

DWG

LPGZ106033LT

NOTES:

- [1] TRIANGULAR DISTORTION TO PRODUCE PREVAILING TORQUE:
 10.5Nm(93lbf-in) MAX FIRST ON.
 1.5Nm(13lbf-in) MIN FIRST OFF.
 1.0Nm(9lbf-in) MIN FIFTH OFF.
- 2. PERFORMANCE REQUIREMENTS:
 INSTALLATION FORCE (PUSH-ON): 90N(20lbf)MAX. AT MAX. PANEL THICKNESS.
 RETENTION FORCE (PUSH-OFF): 13N(3.0lbf)MIN. AT MIN. PANEL THICKNESS.
 PROOF LOAD: 50,050N(11,251lbf)MIN. OVER A 15.40±0.25(6.06±.010) HOLE.

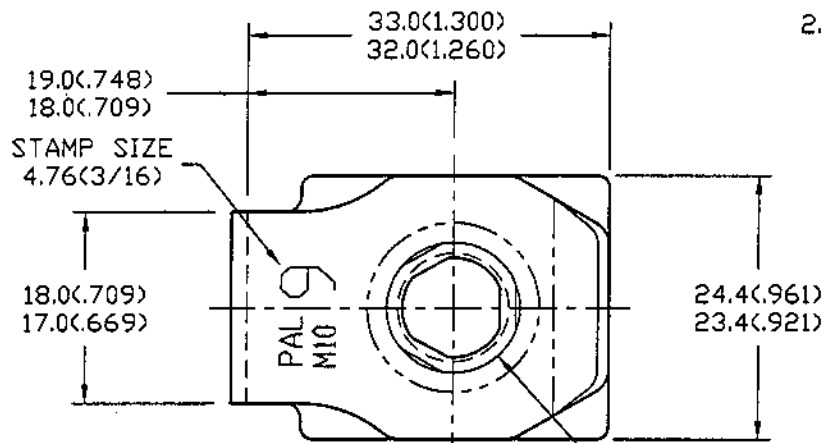

UNCONTROLLED

MAY 10 2002

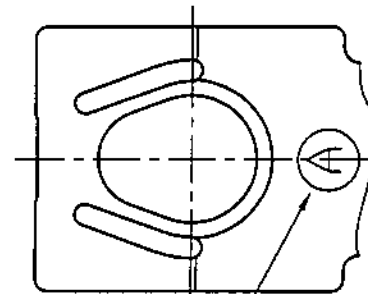

REFERENCE FOR MANUFACTURER IDENTIFICATION PURPOSE ONLY

[1] M10x1.5 6H THREAD

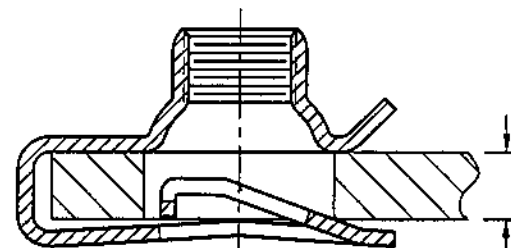
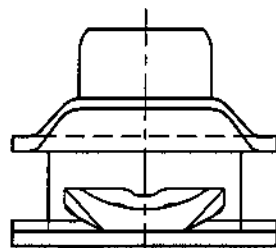
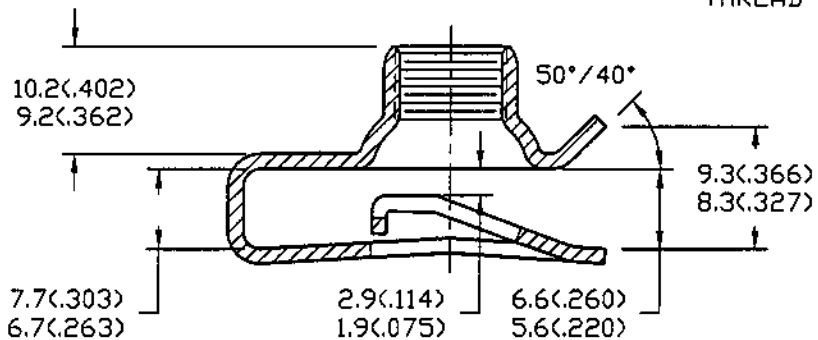

PANEL THICKNESS 3.0(0.118) 6.0(0.236)

ALL DIMENSIONS IN mm. ENGLISH EQUIVALENTS IN ()

Controlled copy must be in Red

TINNERMAN PALNUT
 ENGINEERED PRODUCTS, LLC
 MOUNTAINSIDE, NEW JERSEY

PAL® PALNUT® ON SERT® PUSHNUT®

TITLE
 M10 x 1.5mm MULTI-THREAD
 'U' NUT (SHORT), PREVAILING TORQUE
 FOR 3.0-6.0(0.118-.236)
 PANEL THICKNESS

MATERIAL: SPRING STEEL-SAE1050-1.40(0.055)THK

FINISH: LT-DORRLTECH; TWO COATS+TOPCOAT

DRAWN	CNCas'	RELEASED	SCALE
DATE:	11/27/01	PART No: LPGZ106033LT	NONE
CHECKED:	<i>[Signature]</i>	DWG No.	
APPROVED:	<i>[Signature]</i>	LPGZ106033LT	

HARDNESS: AUSTEMPER RC 42-50

TOLERANCES, UNLESS SPECIFIED:

mm	in
.X±.25	.XX±.010
.XX±.13	.XXX±.005

DATE	REV	DESCRIPTION	BY
1/29/02	A	EC0247; 10.2/9.2 WAS 10.5/9.0; 2.9/1.9 WAS 3.0/2.0; 6.6/5.6 WAS 6.0 MIN; 9.3/8.3 WAS 8.0 MIN; 3.0 WAS 3.5; 50°/40°-ADDED; 15.0/14.0 DIM-DELETED; FINISH-ADDED; NOTES: PERFORMANCE REQUIREMENTS-ADDED; 'A' STAMP-ADDED	CNC
12/10/01	-	PRODUCTION RELEASE #2314	CNC