

RECOMMENDED  
PANEL THICKNESS: 2.8-3.2  
TYPICAL ASSEMBLY  
SCALE: 1:1

CRACKING IS PERMISSIBLE  
IN THIS AREA

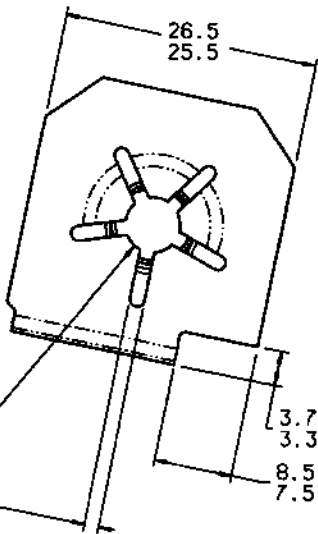
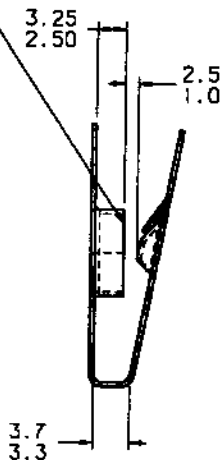
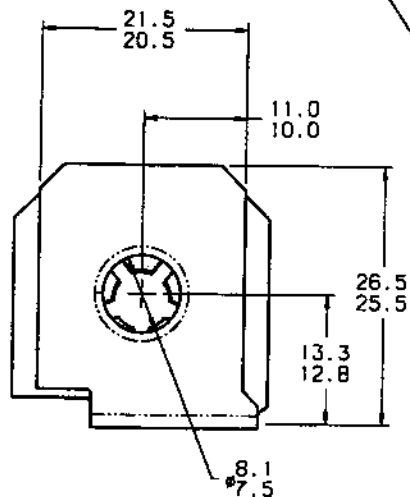

REVISIONS						
E.C.O	REV	DESCRIPTION	DATE	DR	CK	APP
3168	A	DIMENSION LINE CHANGED	05/01/03	RC	RA	HR
3174	B	UPDATED STAR GEOMETRY	05/07/03	RG	RA	HR
		5.6/5.4 WAS 5.71/5.54				
3175	C	PANEL THICKNESS RANGE	05/12/03	RC	RA	HR
		2.8-3.2				

MARK TOOL:



P.O. Box 2492  
Hamilton, Ontario, Canada  
L8N 3K1

DRAWN BY	DATE	CHECKED	SCALE	APPROVED
R. GUARASCIA	04/07/03	R. ALLEN RELEASED 4/30/03	2:1	H. RATTMANN 1ST. PRD. 05/01/03

MATERIAL	THICKNESS	HEAT TREAT	FINISH	HARDNESS
SAE 1050-1065	0.43	AUSTEMPER		Ro44-51

NAME <b>U TYPE SPEED NUT</b>	PRODUCT CODE # 735
---------------------------------	-----------------------

SPECIAL FEATURES: M6 x 1.00 SCREW

SHEET: 1	DWG NO D99056-043M	SIZE B
OF: 1		

NOTE: "T" IDENTIFICATION TO APPEAR  
ON FACE OF PART.  
DIMENSIONING AND TOLERANCING  
PER ASME Y14.5M.



ACTUAL SIZE