



## AVAILABLE FOR LEASE | PHASE 1 BUILDING #5 - 74,482 SQUARE FEET



**BUILDING 5**  
**74,482 SF**

### » BUILDING FEATURES:

- **Clear Height:** 28'
- **Sprinkler System:** ESFR
- **Loading:** 15 Dock High Door Positions  
- Dock Packages To Suit  
1 Ground Level Door
- **Warehouse Lighting:** To Suit
- **Truck Court:** 185' Clear & Fully Secured
- **Trailer Parking:** 30 Spaces
- **Auto Parking:** 36 Spaces

1313 Carriers Drive, Laredo, TX



PHASE 1 CONCEPTUAL ELEVATIONS

### » PORT GRANDE FEATURES:

- Up to 2 Million SF+ Buildings
- Expansion Capabilities
- Immediate access to Union Pacific Intermodal
- 10 miles to Commercial Border Crossings
- Fully Gated and Secured Building
- Lot Sales Available
- 1 Acre - 500 Acres Available

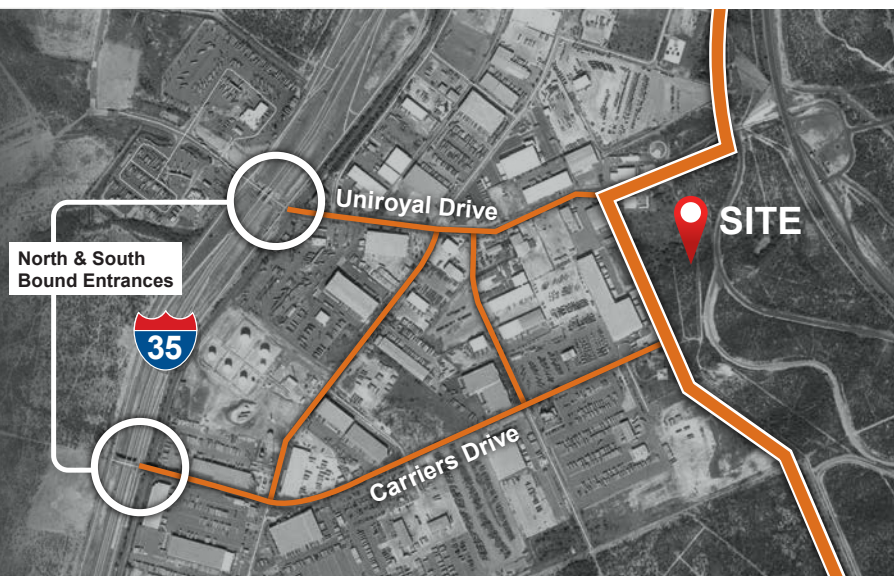

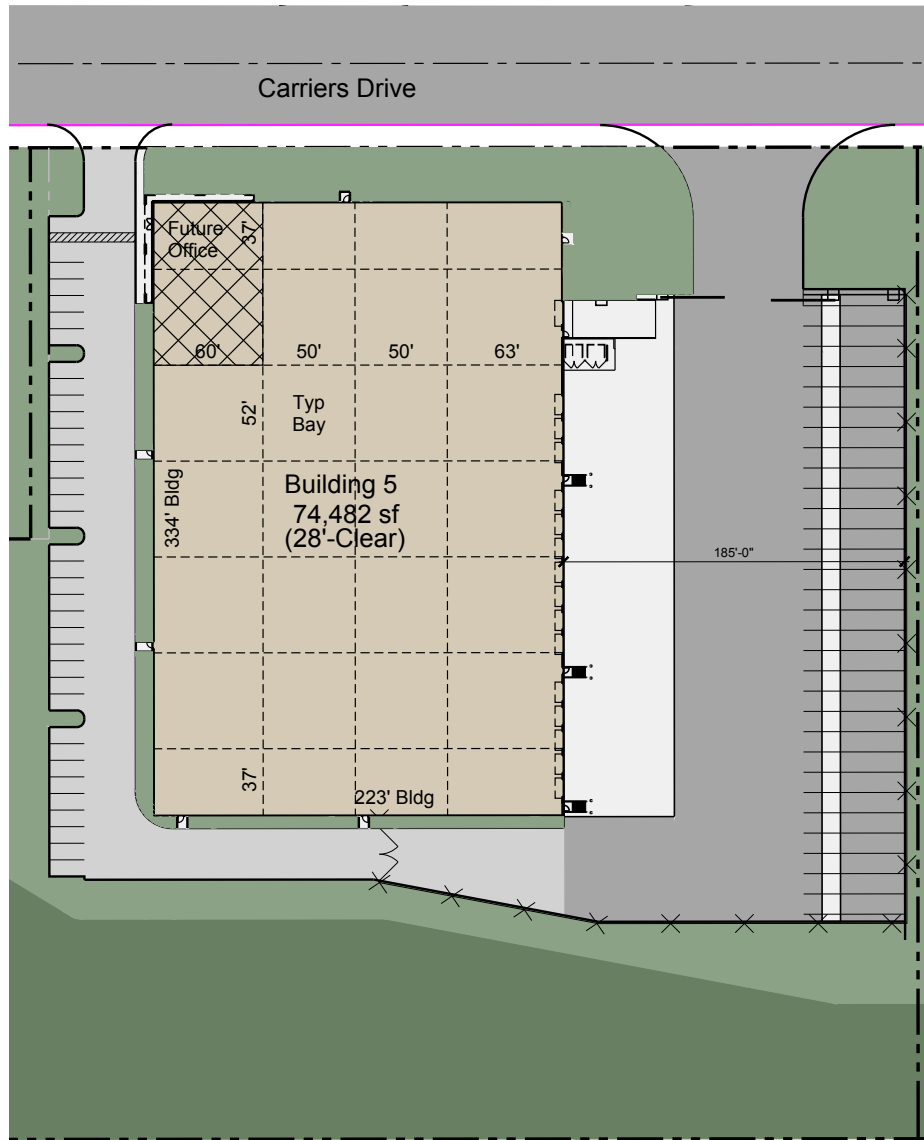

## AVAILABLE FOR LEASE | PHASE 1 BUILDING #5 - 74,482 SQUARE FEET

### FOR ADDITIONAL INFORMATION:

**Kyle Valley - 562.948.4339**  
kylevalley@majesticrealty.com

**Carlo Molano - 956.717.9090**  
carlom@forumcre.com

**Thomas B. Simmons - 562.948.4347**  
tsimmons@majesticrealty.com



1410 Medical Loop • Suite 1B • Laredo, Texas 78045-9998  
**Tel:** 956.717.9090 • [www.forumcre.com](http://www.forumcre.com)

13191 Crossroads Parkway North • Sixth Floor • City of Industry, CA 91746-3497  
**Tel:** 562.692.9581 • **Fax:** 562.695.2329 • [www.MajesticRealty.com](http://www.MajesticRealty.com)



This statement is based upon information which we believe to be correct and is obtained from sources we regard as reliable but we assume no liability for errors or omissions therein.