

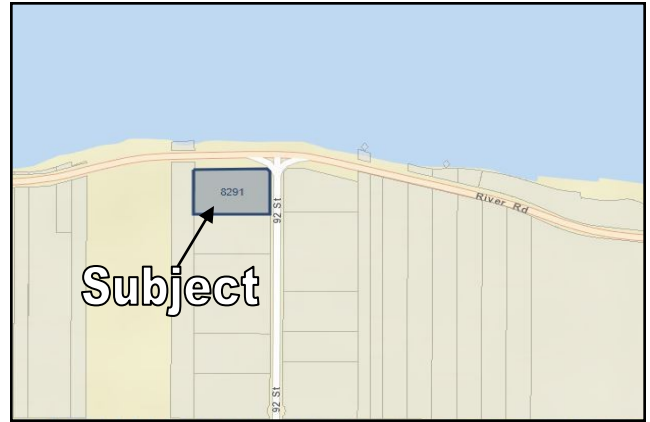

Commercial Strata Unit plus Well Established Business Retirement Sale

#202 - 8291 92St, Delta



Must See! Well built corner warehouse and office unit with high traffic exposure in North Delta area. Easy access to highways and is located at Southeast corner of River Rd & 92 St. Under I-2 Heavy Industrial zoning. Price includes property and existing business (Photocopier Services Provider) with good stable annual revenue of approximately \$2.67 million.

Call now for more information!

Property Information

Address: #202 - 8291 92 St, Delta
Legal: PL EPS1707 LT 1 DL 132 LD 36. GROUP 2
P.I.D.: 029-205-492
Zoning: I2 (Heavy Industrial)
Unit Size: 8,027 SF

Government Assessment (2017)

Land \$671,000
Improvement \$525,000
Total \$1,196,000
Tax: \$18,317.21

Building Information

Building Type: Industrial Flex Building
Strata Area: 8,027 SF
Built Year: 2013



Award Winning Services!



2015 Commercial Top 1 Winner

Raymond Leung PREC* 梁國權

604-644-6482

- Re/Max Commercial Western Canada Top 1 全西岸加拿大第1名
- Re/Max Circle of Legend Award 榮譽傳奇獎
- Re/Max International Lifetime Achievement Award 國際終身成就大獎
- No.1 in Sales with Re/Max Realty Associates 5 years 公司五年銷量第1名
- Re/Max Platinum Club Award Winner for 7 years 7年高銷量白金大獎
- Re/Max 100% Club Award Winner 13 years 13年100% Club 獲獎者
- Re/Max Chairman's Club Award Winner for 3 years 3年主席大獎
- Over 29 Years Real Estate Experience 超過29年房地產經驗
- LS Medallion Club Award 溫哥華地產局銷量大獎
- Re/Max International Top 9 Winner 國際首9名
- Re/Max Canada Top 5 全加拿大首5名
- Re/Max Hall of Fame Award 終身大獎



Re/Max Real Estate Services #410 – 650 W.41st Ave, Vancouver, BC V5Z 2M9

Tel: 604-263-2823 Fax: 604-263-1057 Email: Raymondkleung@hotmail.com WebSite: 410Commercial.com

*Information herein deemed reliable but not guaranteed and must be verified by the buyer. This communication is not intended to cause or induce breach of an existing agency agreement.