

E- 10/12/70

8250 Wadham Drive

A.K. Stuart  
4480 Main St Van BC

LEGAL DESCRIPTION

ADDRESS

ROLL NO.	LOT	BLOCK	D.L.	1	SEC.	TWP. GP	PLAN
166269	365			W $\frac{1}{2}$ SE	26	4	38042
PERMIT NO.	DATE	DATE STARTED	DATE COMPLETED	SPECIAL COMMENTS			
#3711	2 Oct 70	2/10/70	9/12/70	Dwelling Eng. Rec'd 25/9/70 R. Baxter			

ENGINEERING DEPT. APPROVAL \_\_\_\_\_ OCCUPANCY CERT. ISSUED 1/6/71

PLUMBING

SEPTIC TANK

PERMIT NO.	DATE ISSUED	APPROVAL DATE		PERMIT NO. DATE
		ROUGH	FINAL	
5201 (6 Ex)	13/10/70	2/11/70	7/12/70	
				APPROVED

SANITARY SEWER

PERMIT NO. #3711

APPROVAL DATE 4/11/70

FOUNDATION DRAINS

PERMIT NO. #3711

APPROVAL DATE 4/11/70

PLAN SHOWING LOCATION OF  
 FOUNDATION FORMS ON LOT 365, S.E. 1/4, SEC. 26,  
 TP. 4,  
 SCALE 1 INCH = 30 FEET

8250. Madhavan Nair

ROAD

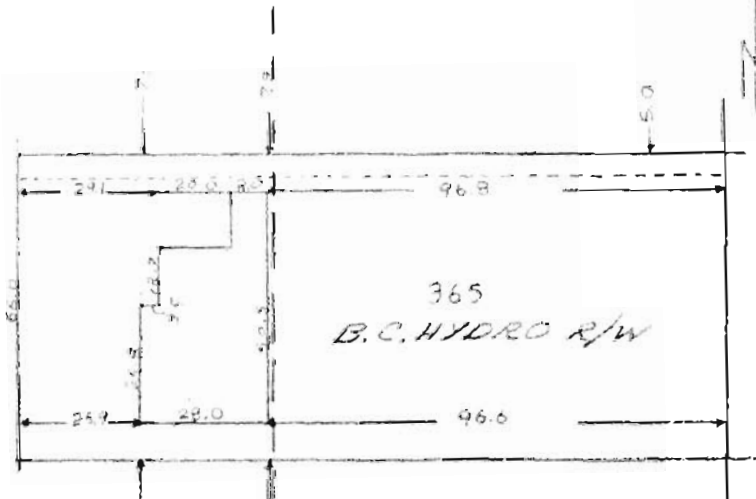

8250 Madhavan Nair

CERTIFIED CORRECT ACCORDING TO  
 SURVEY DATED SEPTEMBER 25, 1970

*R. A. Baxter*  
 R. A. BAXTER, F. C. L. S.

BAXTER & RANNALA  
 SURVEYORS & ENGINEERS  
 STE 102 39 MCKENZIE ST.  
 NEW WESTMINSTER, B. C.

THE CORPORATION OF DELTA  
**PERMIT FORM**  
 APPLICATION TO CONSTRUCT

PERM. CORR. OF DELTA

DATE 2 Oct 70

PHONE No. \_\_\_\_\_

D  
F.C. Dwelling

CASH REGISTER IMPRESSION CONSTITUTES OFFICIAL RECEIPT

REGISTERED OWNER	NAME	ADDRESS					
	<u>A.K. Stuart</u>	<u>4480 Main St Van BC</u>					
CONTRACTOR	NAME	ADDRESS					
	<u>Owner</u>						
LOCATION	ROLL NO.	CIVIC ADDRESS					
	<u>16269</u>	<u>8250 Wadham Dr</u>					
	LOT	BLK.	D.L.	TWP - OR.	PLAN.		
	<u>365</u>			<u>26</u>	<u>4</u>	<u>38042</u>	
ZONING				VALUE	LOT SIZE		
				<u>13,000.00</u>	<u>66'</u>		

		INSTALL.	CODE	WORK ORDER
BUILDING	<u>X</u>	<u>61.00</u>	11 - 527	
CHIMNEY	<u>X</u>	<u>5.00</u>	11 - 529	
OIL BURNER OR GAS	_____	_____	11 - 529	
PLUMBING MIN. \$3.50	_____	_____	11 - 531	
SEPTIC TANK	_____	_____	11 - 533	
FDN. DRAIN	<u>X</u>	<u>5.00</u>	11 - 533	
SEWER INSP.	<u>X</u>	<u>5.00</u>	11 - 535	
SEWER CON.	_____	_____	67 - 517	
	1 LADNER	_____	71 - 517	
	1 LADNER EAST	_____	65 - 517	
	<u>✓</u> 2 NORTH DELTA	<del>_____</del>	69 - 517	
	3 SOUTH DELTA	_____		
WATER CON.	_____	_____	59 - 517	
	<u>✓</u> 1 LADNER	<del>_____</del>	61 - 517	
	<u>✓</u> 2 NORTH DELTA	<del>_____</del>	63 - 517	
	3 SOUTH DELTA	_____		
FRONTAGE CULVERT	_____	_____	11 - 569	
DRIVEWAY CULVERT	_____	_____	<del>11 - 567</del>	
Constr. Deposit				

IN PAID	<input checked="" type="checkbox"/>
IN NOT PAID	<input type="checkbox"/>
TO BE MADE	<input type="checkbox"/>

IN PAID	<input checked="" type="checkbox"/>
IN NOT PAID	<input type="checkbox"/>
TO BE MADE	<input type="checkbox"/>

SUB TOTAL 125.00  
\$201.00

WATER RATES 3.00

SEWER RATES \_\_\_\_\_

GARBAGE RATES \_\_\_\_\_

**TOTAL** \$204.00

CORPORATION OF DELTA NOT RESPONSIBLE FOR LAWFUL SITING OF STRUCTURES ON PROPERTIES WHERE EASEMENTS ARE INVOLVED.

SURVEYORS ENCROACHMENT CERTIFICATE REQUIRED BEFORE FORM INSPECTION. USE OR OCCUPANCY PROHIBITED UNTIL OCCUPANCY PERMIT ISSUED.

SIGNED by mail WITNESSED [Signature] PERMIT # 3711

INSPECTION DEPT.

⑨ ✓

THE CORPORATION OF DELTA  
INSPECTION FORM

PERM. CORP. OF DELTA

81-5101 070012.00 GEN

DATE 13/10/70

PHONE NO. \_\_\_\_\_ **D** Plumbing

CASH REGISTER IMPRESSION CONSTITUTES OFFICIAL RECEIPT

REGISTERED OWNER	NAME	A.K. Stuart		ADDRESS						
INSTALLED BY	NAME	L. Pedersen		ADDRESS						
LOCATION	ROLL NO.	166.69		CIVIC ADDRESS	8250 Wadham Dr.					
	LOT	365	BLK.	D.L.	TWP. GP.	PLAN				
PURPOSE OF BUILDING	Dwelling				NEW	<input type="checkbox"/>	OLD	<input type="checkbox"/>		

FIXTURES TO BE INSTALLED OR REPAIRED

STOREY	WATER CLOSET	WASH BASIN	BATH TUBS	SINKS	WASH TUBS	SHOWERS	UTINALS	AUTO WASHER	WATER HEATER	OTHER FIXTURES
BASEMENT										
MAIN	1	1	1	1	1				1	
2										
3										

	FEE	INSTALL	CODE	WORK ORDER
OIL BURNER OR GAS			11-529	
PLUMBING IMIN. \$3.501	<u>6</u> @ \$2.00 _____ @ \$1.00		11-531	
SEPTIC TANK	_____		11-533	
SEWER INSP.	_____		11-535	
SEWER CON.	_____ 1 LADNER		57-517	
<input type="checkbox"/> IN PAID	_____ 1 LADNER EAST		71-517	
<input type="checkbox"/> IN NOT PAID	_____ 2 NORTH DELTA		65-517	
<input type="checkbox"/> TO BE MADE	_____ 3 SOUTH DELTA		69-517	
	SUB TOTAL	_____		
	SEWER RATES	_____		
	TOTAL	<u>12.00</u>		

PLUMBING INSPECTOR MUST BE NOTIFIED WHEN THE WORK IS READY FOR INSPECTION - BEFORE COVERING UP FINAL INSPECTION REQUIRED BEFORE OCCUPANCY

PERMISSION IS HEREBY GRANTED UNDER THE PROVISIONS OF "DELTA PLUMBING BY-LAW NO. 1007, 1962" AND AMENDMENTS THERETO TO UNDERTAKE THE WORK STATED ABOVE  
In consideration of the granting of this Permit, I/we hereby agree that all such work shall conform to the requirements of "Delta Plumbing By-Law No. 1007, 1962" and amendments thereto.

SIGNED Mail \_\_\_\_\_ WITNESSED P.S \_\_\_\_\_  
INSPECTION DEPT. \_\_\_\_\_ INSP. NO. **5201**