

PSC-REGINA-SASK

POLLOCK & WRIGHT
LAND SURVEYORS

POLLOCK & WRIGHT

LAND SURVEYORS

TELEPHONE 847 1447
4444 CDEE St

REGISTERED
SURVEYORS
SASKATCHEWAN

October 24th, 1984

Messrs. Buchwald, Asper, Ronceloff,
Barristers and Attorneys at Law,
1800 - 155 Carlton Street,
Winnipeg, Manitoba.
R2H 3H3

Attention: Mr. Thomas Prohlmann

Dear Sir:

RE: Lot 46, Plan 900, W.L.T.O.
in R.L. 68 and 69, Parish of St. James.

Certificate of Title 10075

Registered Owners: Maurice Edward Smythe and Lorna Irene Smythe

Encumbrances: Mortgage S77204 is registered against the above
Certificate of Title.

This is to certify that we have made the necessary measurements
to determine the position of a two storey dwelling, numbered 475
on the East side of Craig Street in the City of Winnipeg and find
that the same above ground level is contained entirely within the
limits of the above described land.

There are no encroachments above ground level onto the above described
land by buildings from adjoining properties, except the eavesdroach
of the dwelling to the North as the same projects over the Northern
limit of said land a distance of two-tenths of a foot.

This survey was made on the 23rd day of October, 1984

P. Wright
P. Wright, M.L.S.

SKETCH

Note: Survey monuments were not installed at property corners.

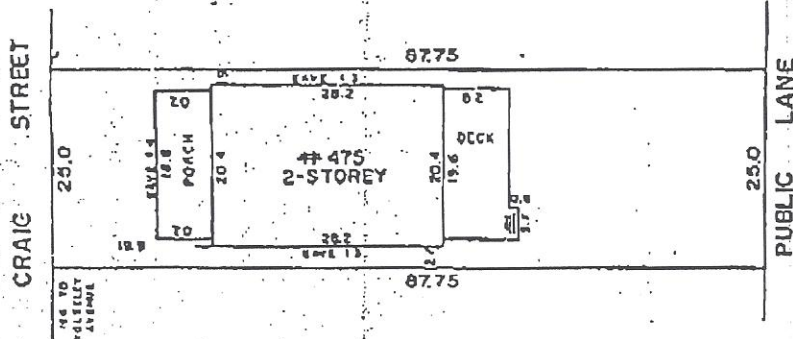

32515