

105 VICTORIA STREET #905

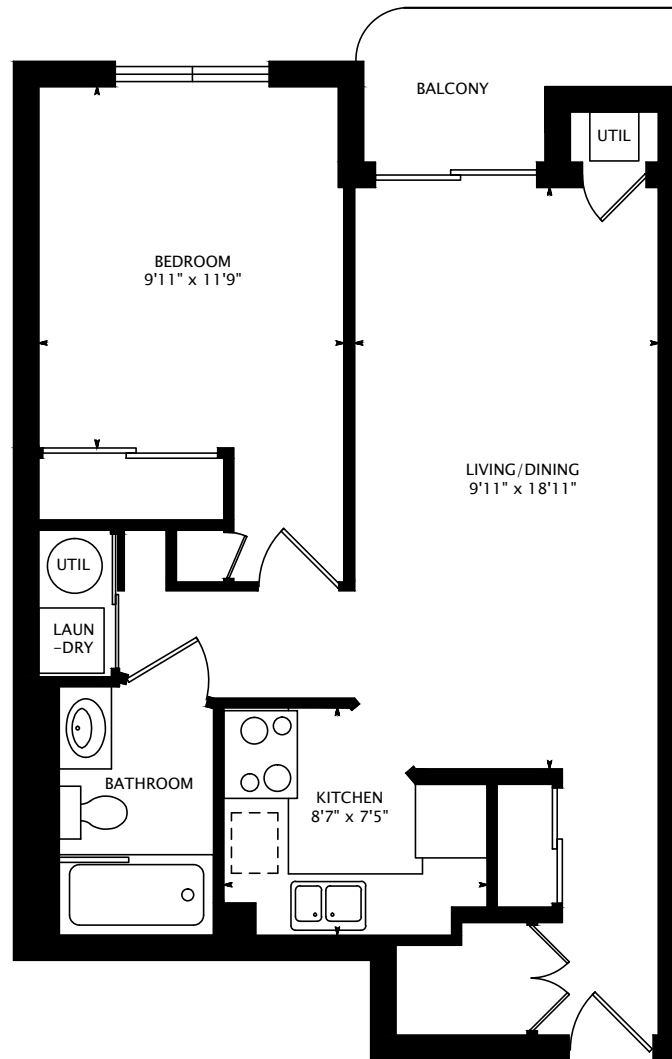

607 SQUARE FEET
+ 40 SQUARE FEET BALCONY

interactive tour: toursler.com/105-victoria-905



DATE: DECEMBER 15, 2015

DIMENSIONS, AREAS, LAYOUTS AND DETAILS ARE APPROXIMATE AND SHOULD BE CONSIDERED ILLUSTRATIVE ONLY.

CORINNE MCCABE, BROKER
BOSLEY REAL ESTATE LTD., BROKERAGE
DIRECT: (416) 888-9842, OFFICE: (416) 322-8000
EMAIL: corinne.mccabe@me.com, WEB: corinnemccabe.com