

PLUMBING				SEPTIC TANK	
PERMIT NO.	DATE ISSUED	APPROVAL DATE		PERMIT NO. DATE	
		ROUGH	FINAL		
2197					
2197	March 22/72				11 fixtures
					APPROVED
SANITARY SEWER			FOUNDATION DRAINS		
PERMIT NO. <u>2235</u>			PERMIT NO. <u>2235</u>		
APPROVAL DATE _____			APPROVAL DATE _____		

CERTIFICATE OF NON-ENCROACHMENT
COVERING LOT 266, DISTRICT LOT 17, GROUP 2.

NEW WESTMINSTER DISTRICT

PLAN 38687

Scale: 1 inch = 20 feet
FORMS 5.5' ABOVE & ROAD

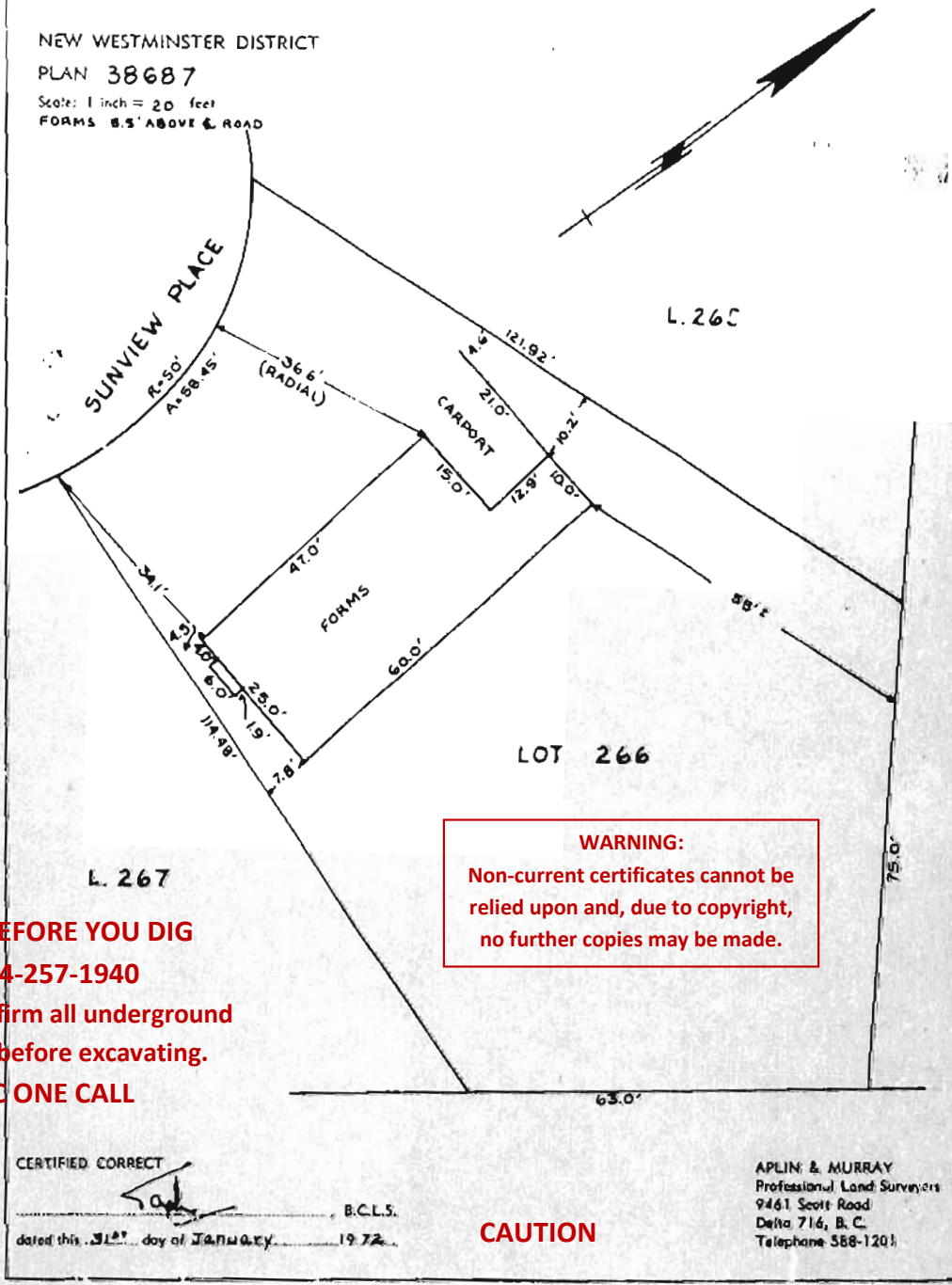

*10527
H337
Sunview Pl.*

WARNING:
Non-current certificates cannot be
relied upon and, due to copyright,
no further copies may be made.

CALL BEFORE YOU DIG
604-257-1940
Please confirm all underground
services before excavating.
BC ONE CALL

CERTIFIED CORRECT
[Signature]
B.C.L.S.
dated this 31st day of JANUARY 1972

CAUTION

APLIN & MURRAY
Professional Land Surveyors
9461 Scott Road
Delta 714, B. C.
Telephone 588-1201

The Corporation of Delta makes no
representation or warranty, either
expressed or implied, with respect to
the accuracy, completeness or
appropriateness of the information
provided on this copy.

THE CORPORATION OF DELTA
INSPECTION FORM

DATE March 22, 1972
PHONE NO. _____

PAID CORP. OF DELTA
972 4960 000022.00 GEN

CASH REGISTER IMPRESSION CONSTITUTES OFFICIAL RECEIPT

REGISTERED OWNER	NAME	Vanant Dvpts	ADDRESS	
INSTALLED BY	NAME	Jim Nyhus	ADDRESS	REG. NO.
LOCATION	ROLL NO.	51298-25	CIVIC ADDRESS 10524 Sunview Place	
	LOT	266	BLK.	D.L.
PURPOSE OF BUILDING			T/4	SEC.
			TWP. 3P.	PLAN

FIXTURES TO BE INSTALLED OR REPAIRED

STOREY	WATER CLOSET	WASH BASIN	BATH TUBS	SINKS	WASH TUBS	SHOWERS	IRINALS	AUTO WASHER	WATER HEATER	OTHER FIXTURES
BASEMENT	/	/			/	/			/	
MAIN	2	2	/	/						
2										
3										

	FEE	INSTALL	CODE	WORK ORDER
OIL BURNER & GAS	<u>L</u>			
PLUMBING (MIN. \$9.50)	\$ 22.00			15131
SEPTIC TANK <input type="checkbox"/> PDN. DRAIN <input type="checkbox"/>				15192
SEWER INSP.				15193
SEWER CON.				15194
IN PAID <input type="checkbox"/>		1 LADNER EAST		39-1443
IN NOT PAID <input type="checkbox"/>		2 NORTH DELTA		61-1443
TO BE MADE <input type="checkbox"/>		3 SOUTH DELTA		63-1443
	SUB TOTAL	<u>22.00</u>		
	SEWER RATES			
	TOTAL	<u>22.00</u>		

PLUMBING INSPECTOR MUST BE NOTIFIED WHEN THE WORK IS READY FOR INSPECTION - BEFORE COVERING UP FINAL INSPECTION REQUIRED BEFORE OCCUPANCY

PERMISSION IS HEREBY GRANTED UNDER THE PROVISIONS OF "DELTA PLUMBING BY-LAW NO. 1007, 1962" AND AMENDMENTS THERE TO UNDERTAKE THE WORK STATED ABOVE
In consideration of the granting of this Permit, I/we hereby agree that all such work shall conform to the requirements of "Delta Plumbing By-Law No. 1007, 1962" and amendments thereto.

SIGNED mail WITNESSED FW

INSPECTION DEPT. COPY

INSP. NO. 2197

DATE January 18, 1972

THE CORPORATION OF DELTA
PERMIT FORM

PHONE No. 581-2697

APPLICATION TO CONSTRUCT
NEW DWELLING

PAID CORP OF DELTA

217717 100034.00 GEN

(single family 1-storey with basement)

POSTER IMPRESSION CONSTITUTES OFFICIAL RECEIPT.

REGISTERED OWNER	NAME	ADDRESS
	Vanant Developments Ltd.	10456 Main Street, Delta, B. C.
CONTRACTOR	NAME	ADDRESS
	-do-	-do-
LOCATION	ROLL NO.	CIVIC ADDRESS
	311298-20	10524 <i>Summit Rd</i>
	LOT 266	BLK. 17x18
		D.L. 1-4
		SEC. 2
		TWP-OP. 38687
ZONING	1200 @ 14.00	VALU E 16,800
		LOT SIZE

		CODE	INSTALL	WORK ORDER
BUILDING <input checked="" type="checkbox"/> CHIMNEY <input checked="" type="checkbox"/>	\$ 74.00	1517		
OIL BURNER OR GAS		15191		
PLUMBING MIN. \$3.50	\$ 2.00 — \$ 1.00	15192		
SEPTIC TANK <input type="checkbox"/> FDN. DRAIN <input type="checkbox"/>	5.00	15193		
SEWER INSP.	5.00	15194		
SEWER CON.	1 LADNER	65-14423		
	1 LADNER EAST	71-14423		
	2 NORTH DELTA	65-14423		
	3 SOUTH DELTA	69-14423		
WATER CON.	1 LADNER	59-14413		
	2 NORTH DELTA	61-14413		
	3 SOUTH DELTA	63-14413		
DRIVEWAY CULVERT		1431		
FRONTAGE CULVERT, STORM CONN.		1432		

IN PAID	<input checked="" type="checkbox"/>
IN NOT PAID	<input type="checkbox"/>
TO BE MADE	<input type="checkbox"/>

IN PAID	<input checked="" type="checkbox"/>
IN NOT PAID	<input type="checkbox"/>
TO BE MADE	<input type="checkbox"/>

SUB TOTAL \$ 84.00

OTHER DEPOSITS _____ 47-4461
CONSTRUCTION DEPOSIT 125.00 47-4462
SUB TOTAL \$ 125.00

WATER RATES 28.50
SEWER RATES 16.00
GARBAGE RATES 9.00
SUB TOTAL \$ 53.50

CORPORATION OF DELTA NOT RESPONSIBLE FOR LAWFUL SITING OF STRUCTURES ON PROPERTIES WHERE EASEMENTS ARE INVOLVED.

TOTAL \$ 262.50

THIS PERMIT IS ISSUED SUBJECT TO THE CONDITIONS LISTED ON REVERSE SIDE.

SIGNED E. J. [Signature] WITNESSED [Signature] PERMIT # 2235

INSPECTION DEPT. COPY

CIVIC ADDRESS: 10524 Sunview Place

OATC: November 17, 1981

LOT: 266

BLK: []

D/L: 17 & 18

SEC: []

MAP: 2

PLAN: 38687

ZONING: Roll No. 311 298 20

USE: CORPUSATION OF DELTA

Install '0' Clearance Fireplace

LOT SIZE: []

SIZE OF BUILDING: []

ADDRESS: []

PHONE: []

OWNER: Bill Sweet (as above) V4C 2M9 588 1135 O/B

ARCHITECT/ENGINEER: []

CONTRACTOR: []

SPECIAL DETAILS

APPROVED	FORMS	CRAAL SP	FRAMING	DUCTWORK	F.P. & CHMNY	INSUL. & V.B.	OCCUPANCY
INSPECTOR							
DATE							

INSP. OF	CALLED FOR	COMMENTS	INSP. BY	DATE
<i>Genel</i>	NOV 27 1981	<i>OK</i>	<i>[Signature]</i>	81-11-27

CIVIC ADDRESS		10524 Sunview Place		DATE	November 10, 1991		CODE	PERMIT NUMBER
LOT	BLK.	D.L.	1/4	SEC.	TWP-GP	PLAN	ROLL NO	
266		17 & 18			3	38687	311 288 20	
OWNER/OWNER'S REPRESENTATIVE		ADDRESS		PHONE:		LIC. NO.		
Bill Sweet (as above)		V4C 2ND		588-1135		0/3		
SPECIAL DETAILS							FEES PAID BY:	
Must be U.L.C. Approved with Type 'A' Vent.							<input type="checkbox"/> OWNER	
							<input type="checkbox"/> REPRESENTATIVE	
USE								
Install '0' Clearance Fireplace								
ZONING	NO. STORIES	SIZE OF BUILDING	NO. OF FLOORS		NO. OF FLOORS		NO. OF FLOORS	
ESTIMATED VALUE OF ERECTION, ALTERATION, REPAIR OR DEMOLITION OF BUILDING OR STRUCTURE				\$ 1,000.00	\$ 10.00	F. S. CHECKED		
				VALUE	FEE			
<p>It is understood that this Permit will be subject to full compliance with the Corporation's Building Bylaw and all other Bylaws and statutory requirements of the Corporation, and it is the duty of the applicant to make enquiries as to such matters before commencing the works.</p> <p>In consideration of the granting of this Permit, I hereby agree to indemnify and release the Corporation of Delta against all claims, liabilities, judgements, costs and expenses of whatsoever kind, which may in any way accrue against the said Corporation in consequence of, and incidental to, the granting of this Permit, if issued. I further agree to pay the cost of repairing any damage to public works by reason of the building operations in respect of which this Permit is applied for.</p>								
PLANS APPROVED AND PERMIT ISSUED BY DIRECTOR OF INSPECTION SERVICES								
Mailed			PER					
SIGNATURE			WITNESSED					