

UNIT N307 - 737 HUMBOLDT STREET

820 SQ. FT.

9' CEILING HEIGHT

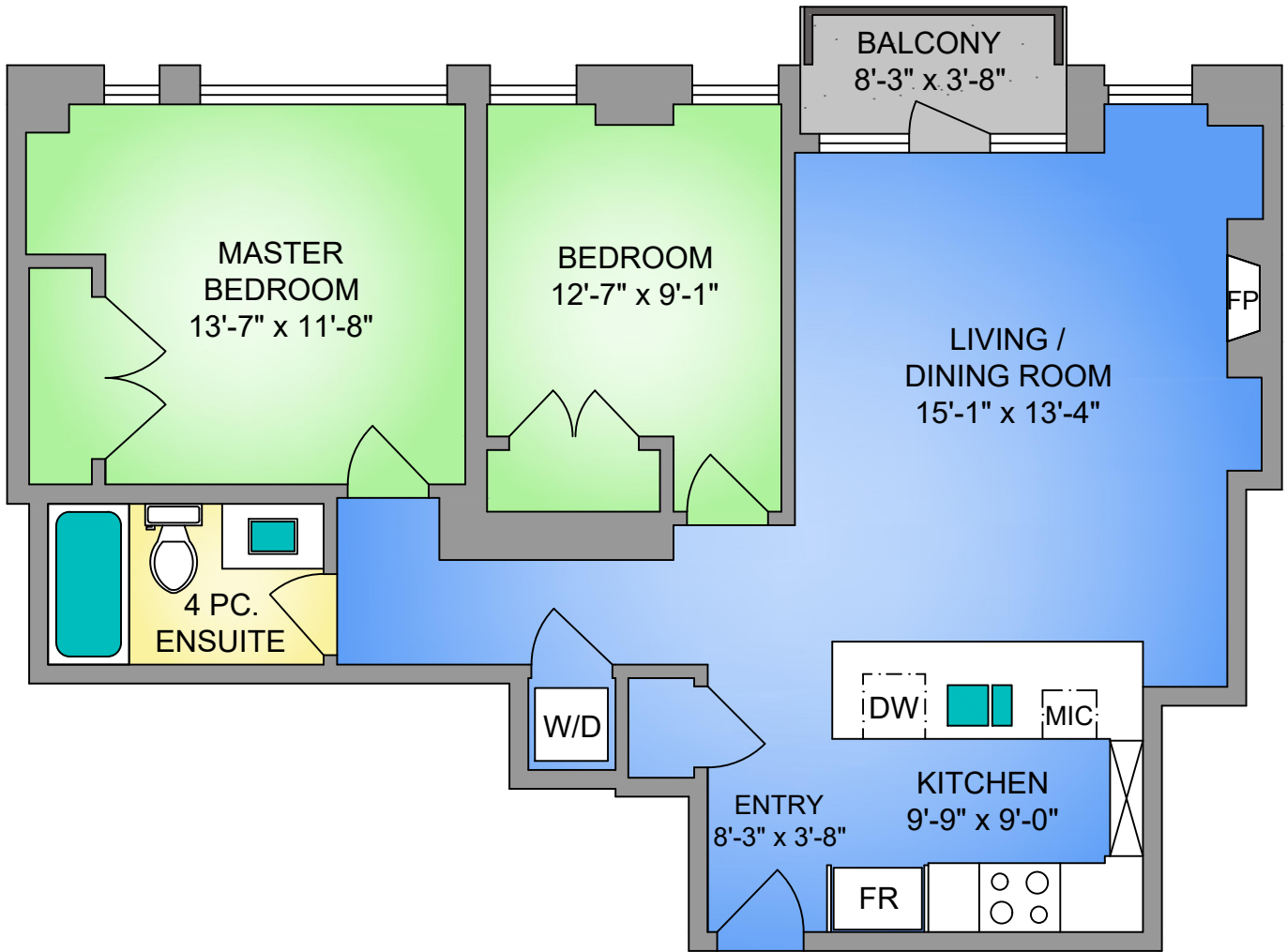

UNIT N307 - 737 HUMBOLDT STREET		
APRIL 21, 2020		
PREPARED FOR THE EXCLUSIVE USE OF THE MODERN REAL ESTATE TEAM		
PLANS MAY NOT BE 100% ACCURATE, IF CRITICAL BUYER TO VERIFY.		
FLOOR	AREA (SQ. FT.)	
	FINISHED	BALCONY
THIRD	820	30

NORTH

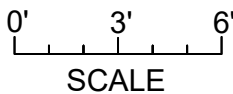

250-884-9753
matt@propermeasure.com
www.propermeasure.com