

**Recommended P.C. Board Layout**  
SCALE 4:1

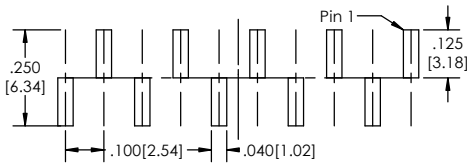

**SINGLE (M) ROW**

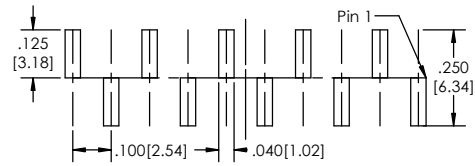

**SINGLE (S) ROW**

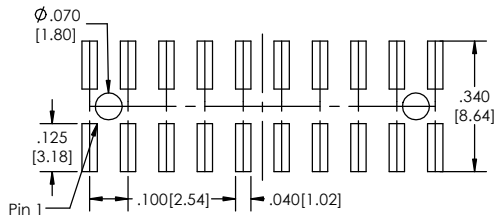

**DOUBLE ROW**

**APPLICATION**

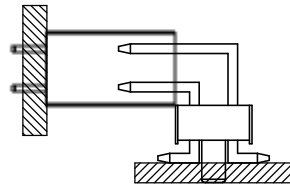

**SINGLE (S) ROW**

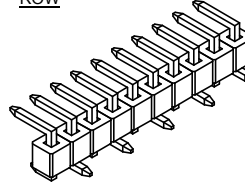

**SINGLE (M) ROW**

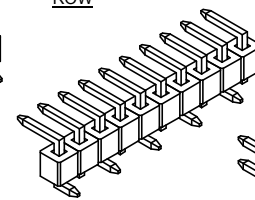

**DOUBLE ROW**

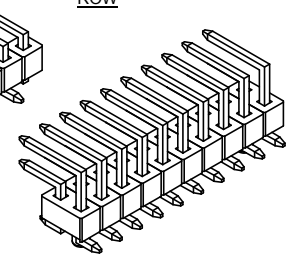

TSHCRSM-1 **XX** - **X** - **XXX** - **XX** - **XX** - **XXX** - **X** - **XX** - **X** - **XX** - **LF**  
(A) (B) (C) (D) (E) (F) (G) (H) (I) (J) (K)

- A. Pins Per Row  
- 1 through 40
- B. Row Specification  
- S= Single Row  
- D= Double Row
- C. Desired Post Height  
- Please specify  
- e.g. .100[2.54]= 100
- D. Pin Options  
- See Pin Options below
- E. Plating Options  
- See Plating Options below
- F. Polarized Position  
- Leave blank if not needed  
- If required, specify empty pin position  
- e.g. 012 for Pin 12
- G. Footprint  
- S= pin 1 left  
- M= pin 1 right
- H. Packing Information  
- TR= Tape and Reel  
- TB= Tube
- I. Pad  
- P= Plastic  
- O= No Pad  
- If required, specify empty pin position  
- e.g. .012 for Pin 12
- J. Alignment Pin Option  
- Leave blank if not needed  
- AP= With
- K. Lead Free

**Mates with:**

- BCSS.
- BSSH.
- BSSHC.
- BSSQ.
- BSSQC.
- BSSQM.
- LCSS.
- LSMBC.
- LSWSS.
- SMBC.
- SSHQ.
- SSHQR.
- SSHR.
- SSHS.
- SSSHM.

Plating options	
G	10µ Gold on Contact Area/ Flash on Tail
T	Matte Tin all Over
GT	10µ Gold on Contact Area/ Matte Tin on Tail
H	30µ Gold on Contact Area/ Matte Tin on Tail
F	Gold Flash over Entire Pin
FT	Gold Flash on Contact Area/ Matte Tin on Tail

**Specifications:**  
 Current Rating: 3.0 Ampere  
 Insulation Resistance: 1000M Ohms Min.  
 Dielectric Withstanding: 600V AC  
 Contact Resistance: 20M Ohms Max.  
 Operation Temperature: -40°C to +105°C  
 Max. Process Temperature  
 Peak: 260°C up to 20 secs.  
 Process: 230°C up to 60 secs.  
 Wave: 260°C up to 6 secs.  
 Reflow: 260°C up to 10 secs.  
 Manual Solder: 350°C up to 5 secs.

Pin Options	
Max. Post Height	
.120[3.05mm]	06
.220[5.59mm]	14
.320[8.13mm]	16
.420[10.67mm]	20
.520[13.21mm]	22
.620[15.75mm]	24
.720[18.29mm]	26
.820[20.83mm]	28
.920[23.37mm]	30

**Materials:**  
 Contact Material: Phosphor Bronze  
 Insulator Material: Nylon 6T  
 Plating: Au or Sn over 50µ" (1.27) Ni

Tails may be clipped to achieve specific dimensions.  
 Products cut to specific sizes are uncancelable/nonreturnable.  
 Parts are subject to change without notice.

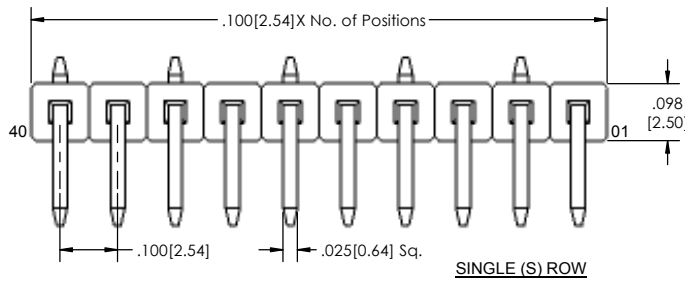
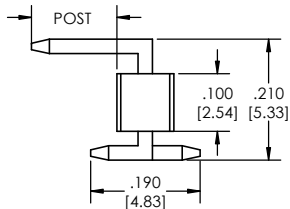

**SINGLE (S) ROW**

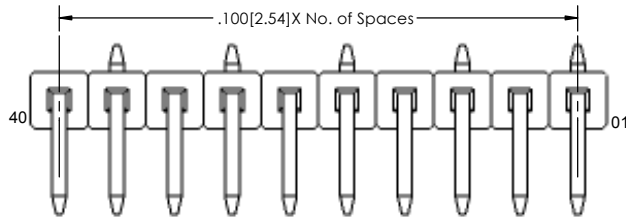

**SINGLE (M) ROW**

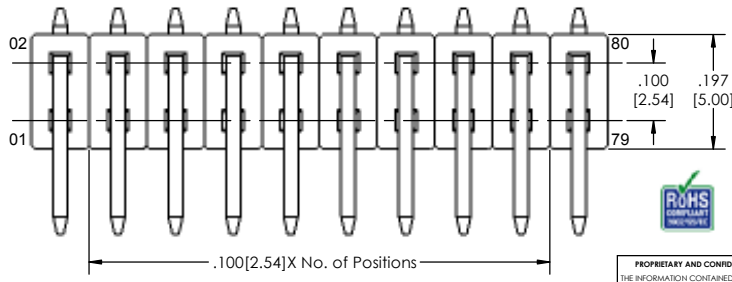

**DOUBLE ROW**

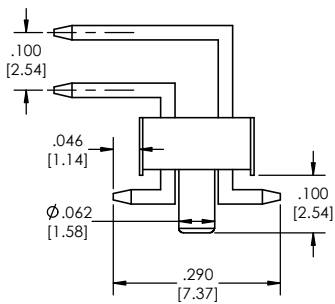

**PROPRIETARY AND CONFIDENTIAL**  
 THE INFORMATION CONTAINED IN THIS DRAWING IS THE SOLE PROPERTY OF Major League Electronics. ANY REPRODUCTION IN PART OR AS A WHOLE WITHOUT THE WRITTEN PERMISSION OF Major League Electronics IS PROHIBITED.

UNLESS OTHERWISE SPECIFIED:		NAME		DATE	
DIMENSIONS ARE IN INCHES		DRAWN	EOW	01/14/14	
TOLERANCES:		CHECKED	GWE	01/14/14	
ONE DECIMALS ±.100		ENG APPR.			
TWO DECIMAL ±.010		MFG APPR.			
THREE DECIMAL ±.005		ADDRESS:			
FOUR DECIMAL ±.002		2533 Centennial Blvd. Jeffersonville, In 47130 Phone: 812-670-4174 Fax: 812-670-4175 E-Mail: mle@mlelectronics.com			
NEXT ASSY	USED ON	FINISH	TITLE: TSHCRSM-1 SERIES		
APPLICATION	DO NOT SCALE DRAWING		SIZE	DWG. NO.	REV
			C		B
			SCALE 6:1		SHEET 1 OF 1

