

Recommended P.C. Board Layout

SCALE 6:1

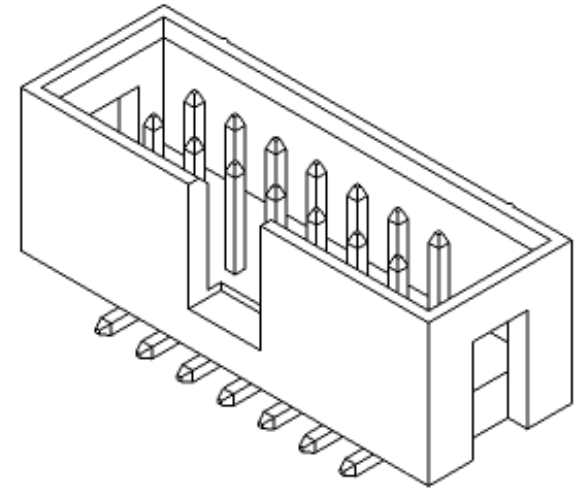
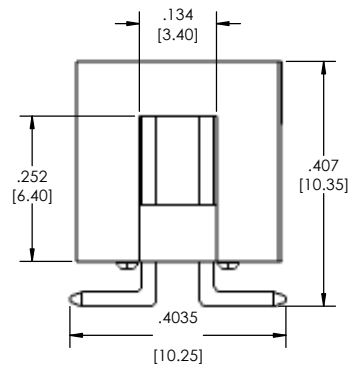
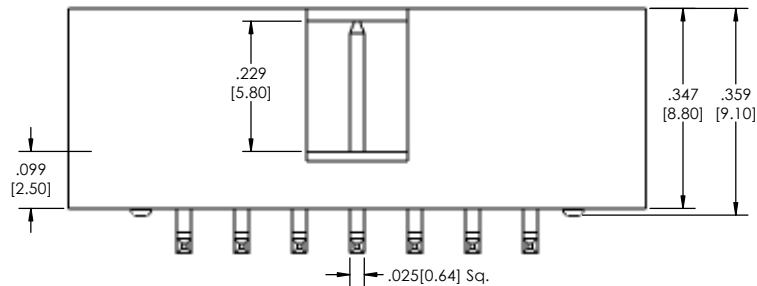
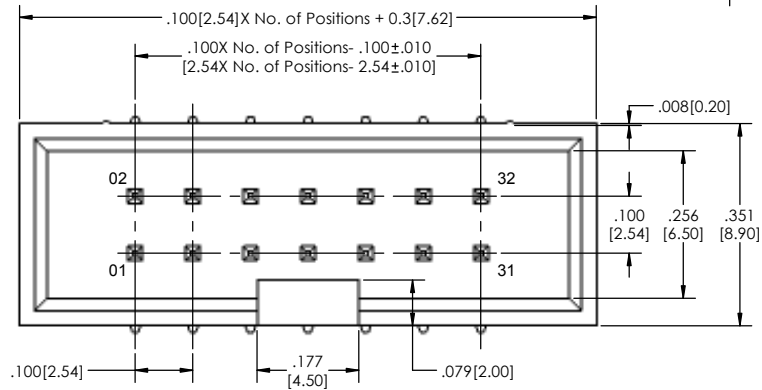
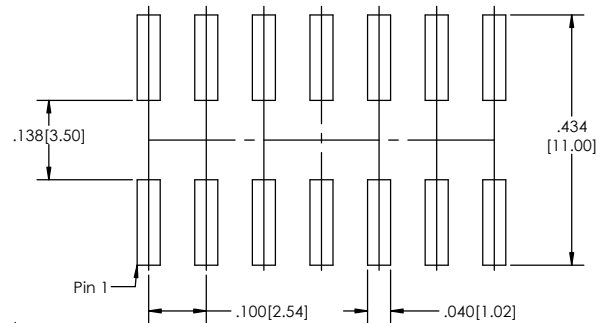

SHTSHSM-1 [XX] - [D] - [02] - [XX] - [V] - [XXX] - [XX] - [X] - [LF]
(A) (B) (C) (D) (E) (F) (G) (H) (I)

- A. Pins Per Row
 - 3 through 32
- B. Row Specification
 - D= Double Row
- C. Style
 - 02= Surface Mount Option
- D. Plating Options
 - See Plating Options below
- E. Vertical
- F. Polarized Position
 - Leave blank if not needed
 - If required, specify empty pin position
 - 001-064
- G. Packaging Option
 - TR= Tape and Reel
 - TB= Tube
- H. Pad
 - P= Pad
 - O= No Pad
- I. Lead Free

Mates With:
IDS-1

Plating options	
G	-10µ Gold on Contact Area/ Flash on Tail
T	-Matte Tin all Over
GT	-10µ Gold on Contact Area/ Matte Tin on Tail
F	-Gold Flash over Entire Pin

Specifications:
Current Rating: 3.0 Ampere
Insulation Resistance: 1000M Ohms Min.
Dielectric Withstanding: 600V AC
Contact Resistance: 20M Ohms Max.
Operation Temperature: -40°C to +105°C

Materials:
Contact Material: Copper Alloy
Insulator Material: Polyester UL 94V-0, Nylon 6T

Tails may be clipped to achieve specific dimensions.
Products cut to specific sizes are uncancellable/ nonreturnable.
Parts are subject to change without notice.



PROPRIETARY AND CONFIDENTIAL
THE INFORMATION CONTAINED IN THIS DRAWING IS THE SOLE PROPERTY OF Major League Electronics. ANY REPRODUCTION IN PART OR AS A WHOLE WITHOUT THE WRITTEN PERMISSION OF Major League Electronics IS PROHIBITED.

UNLESS OTHERWISE SPECIFIED:		NAME	DATE
DIMENSIONS ARE IN INCHES		DRAWN	EOW 03/11/14
TOLERANCES:		CHECKED	GWE 03/11/14
ONE DECIMALS ±.100		ENG APPR.	
TWO DECIMAL ±.010		MFG APPR.	
THREE DECIMAL ±.005		ADDRESS:	
FOUR DECIMAL ±.002		2533 Centennial Blvd.	
NEXT ASSY USED ON		Jeffersonville, IN 47130	
APPLICATION		Phone: 812-670-4174	
DO NOT SCALE DRAWING		Fax: 812-670-4175	
		E-Mail: mle@mllelectronics.com	
		TITLE: SHTSHSM-1 SERIES	
		SIZE	DWG. NO.
		C	D
		SCALE 6:1	
		SHEET 1 OF 1	

