

# APPLICATION

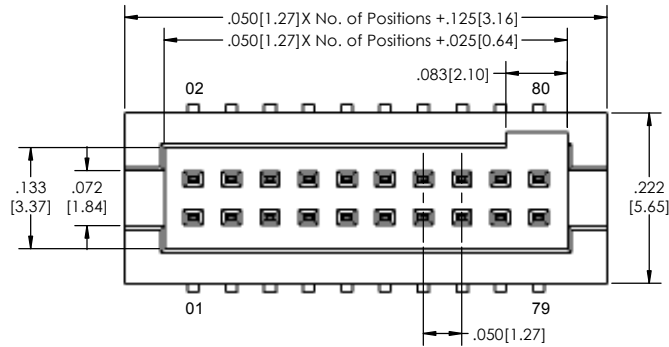

## Alignment Pin Option (-AP)

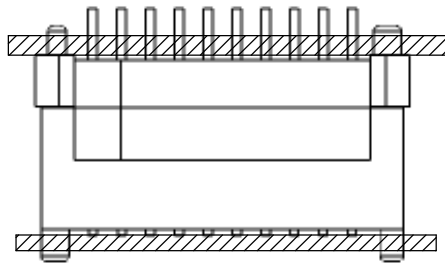
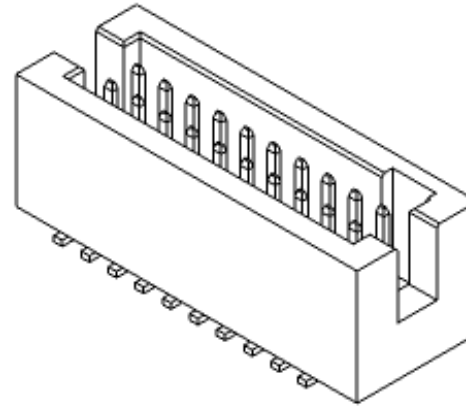
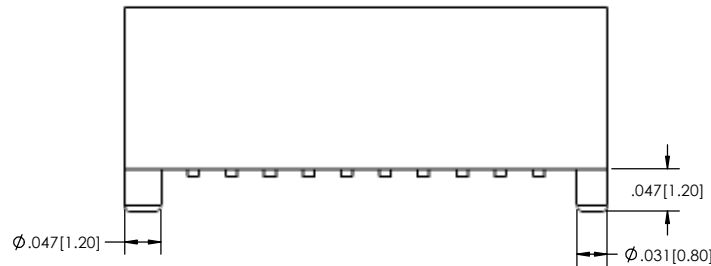

## Locking Clip Option (-C)

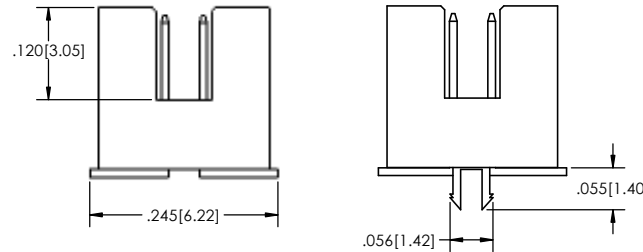

## Recommended P.C. Board Layout

SCALE 6:1

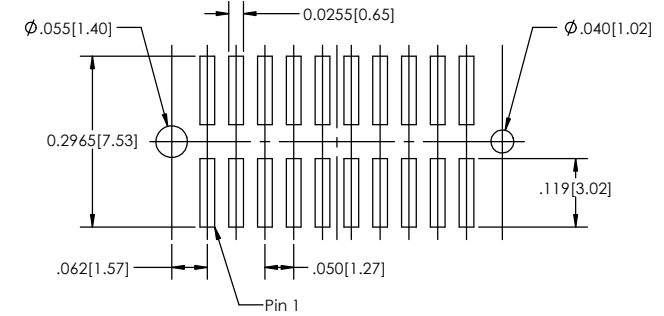

PTSHSM-5 **XX** - **D** - **XX** - **XX** - **XX** - **X** - **XX** - **X** - **LF**  
(A) (B) (C) (D) (E) (F) (G) (H) (I)

- A. Pins Per Row
  - 5 through 40
- B. Row Specification
  - D= Dual Row
- C. Pin Options
  - See Pin Options below
- D. Plating Options
  - See Plating Options below
- E. Alignment Pin
  - Leave blank if not needed
  - AP= With
- F. Locking Clip
  - Leave blank if not needed
  - C= With
- G. Packing Information
  - TR= Tape and Reel
  - TB= Tube
- H. Pad
  - P= Plastic
  - O= No Pad
  - If left blank, packaging at MLE's discretion
  - Pad may be metal, mylar or plastic
- I. Lead Free

Mates with:  
PSSHS  
PSSHSM

Plating options	
G	-10μ Gold on Contact Area/ Flash on Tail
T	-Matte Tin all Over
GT	-10μ Gold on Contact Area/ Matte Tin on Tail
H	-30μ Gold on Contact Area/ Matte Tin on Tail
F	-Gold Flash over Entire Pin
FT	- Gold Flash on Contact Area/ Matte Tin on Tail

Pin Options	
Body Height	
.224	5.70mm 02
.287	7.30mm 06
.354	9.00mm 10
.433	11.00mm 14

Specifications:  
Current Rating: 1.0 Ampere  
Insulation Resistance: 1000M Ohms Min.  
Dielectric Withstanding: 300V AC  
Contact Resistance: 20M Ohms Max.  
Operation Temperature: -40°C to +105°C  
Max. Process Temperature  
Peak: 260°C up to 10 secs.  
Process: 230°C up to 60 secs.  
Wave: 260°C up to 6 secs.  
Reflow: 260°C up to 10 secs.  
Manual Solder: 350°C up to 5 secs.

Materials:  
Contact Material: Phosphor Bronze  
Insulator Material: Nylon 6T  
Plating: Au or Sn over 50μ" (1.27) Ni  
Tails may be clipped to achieve specific dimensions.

Products cut to specific sizes are uncancellable/ nonreturnable.  
Parts are subject to change without notice.



PROPRIETARY AND CONFIDENTIAL  
THE INFORMATION CONTAINED IN THIS DRAWING IS THE SOLE PROPERTY OF Major League Electronics. ANY REPRODUCTION IN PART OR AS A WHOLE WITHOUT THE WRITTEN PERMISSION OF Major League Electronics IS PROHIBITED.

UNLESS OTHERWISE SPECIFIED:	
DIMENSIONS ARE IN INCHES	
TOLERANCES:	
ONE DECIMALS ±.100	
TWO DECIMALS ±.010	
THREE DECIMALS ±.005	
FOUR DECIMALS ±.002	
NEXT ASSY	USED ON
APPLICATION	DO NOT SCALE DRAWING

NAME	DATE
DRAWN: EOW	02/18/14
CHECKED: GWE	02/18/14
ENG APPR:	
MFG APPR:	
ADDRESS:	
2533 Centennial Blvd.	
Jeffersonville, IN 47130	
Phone: 812-670-4174	
Fax: 812-670-4175	
E-Mail: mle@mllelectronics.com	

MAJOR LEAGUE Electronics	
TITLE: PTSHSM-5 SERIES	
SIZE: C	DWG. NO.
REV: B	
SCALE 8:1	SHEET 1 OF 1