

SYSTEM FEATURES AND BENEFITS

A floating sports floor system providing the stability of an anchored floor with the uniform resiliency of a floating system, consisting in general of a vapor barrier, resilient pads, continuous steel channel, steel anchors, wood subflooring, maple flooring, sanding, sealers, finishes, game lines and wall base.

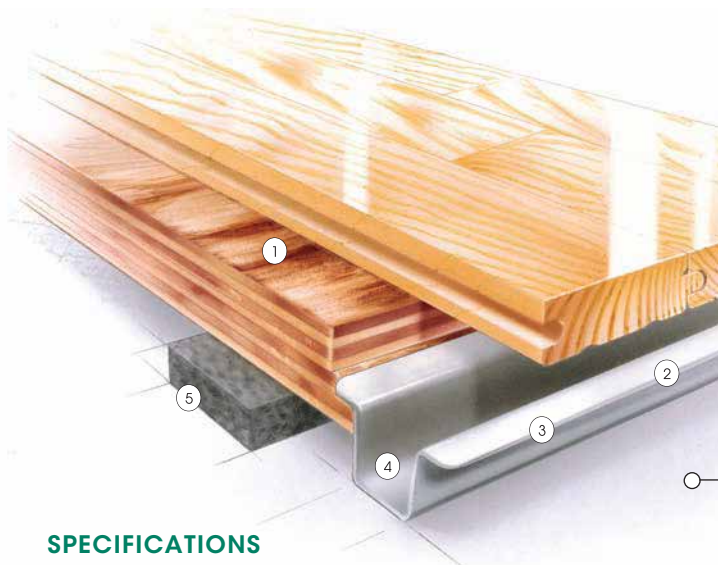

- ① Pre-assembled subfloor panels
- ② Continuous channel assures uniform substrate contact
- ③ Heavy-duty, buckle resistant steel channel provides greater resistance to pin pull through and upward pressure
- ④ Open channel for visual anchor inspection and additional anchor placement
- ⑤ Rezill Pad for excellent resilient life and loading

SPECIFICATIONS

MANUFACTURING	ISO 9001:2008 CERTIFIED ISO 14001:2004 CERTIFIED
U.S. PATENT #	5,016,413
SYSTEM TYPE	Fixed Resilient
ANCHORAGE	Continuous Channel (Design Group 1)
SUBFLOOR CONSTRUCTION	Plywood panel
RESILIENCE	Rezill Pads
RECYCLED CONTRIBUTION	Rezill Channel subfloor system includes components with recycled content
SLAB DEPRESSION	25/32" (20 mm) flooring - 2 1/8" (54 mm) 33/32" (26 mm) flooring - 2 3/8" (60 mm)
DIN STATUS	D-I-N Meets or exceeds all requirements of DIN 18032, Part 2
TESTING LABORATORY	United States Sports Surfacing Laboratory
CERTIFIED TESTING	Laboratory test equipment calibrated and certified through the ISSS
GREEN STATUS	Managed forests, certification available
ENVIRONMENTAL PRODUCT DECLARATION	The first sports floor manufacturer to publish UL certified product-specific environmental performance in compliance with LEED V.4

WALL BASE DETAIL

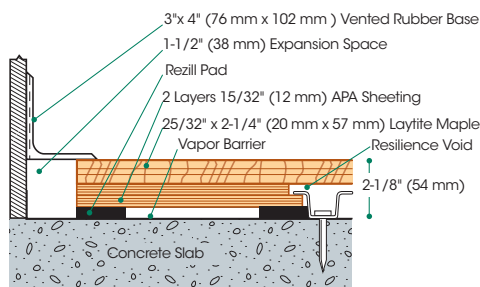

THRESHOLD DETAIL (optional accessory)

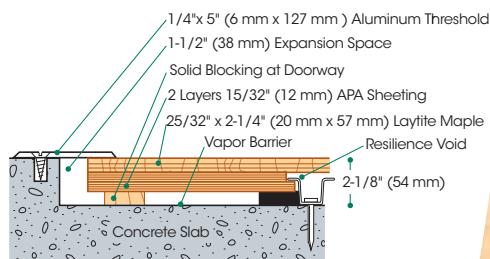

EQUIPMENT DETAIL (optional accessory)

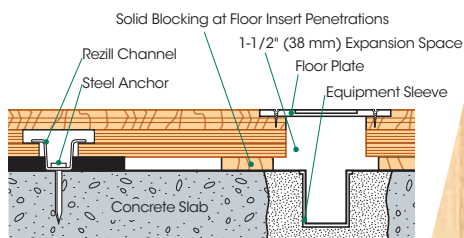

ENDORSED
BY THESE
LEADERS
IN SPORT

