



UNIFORCE™

**FIXED
RESILIENT**
○○○
UNIFORCE

FIXED RESILIENT

SYSTEM FEATURES AND BENEFITS

A sports floor system providing excellent uniformity, low vibration, great shock absorption and basketball rebound, consisting in general of a vapor barrier, subfloor sectional plates, cushion support plates, "Impact Control" cushions, wood nailers, nailer cushions, continuous steel channel, maple flooring, sanding, sealers, finish, game lines and wall base.

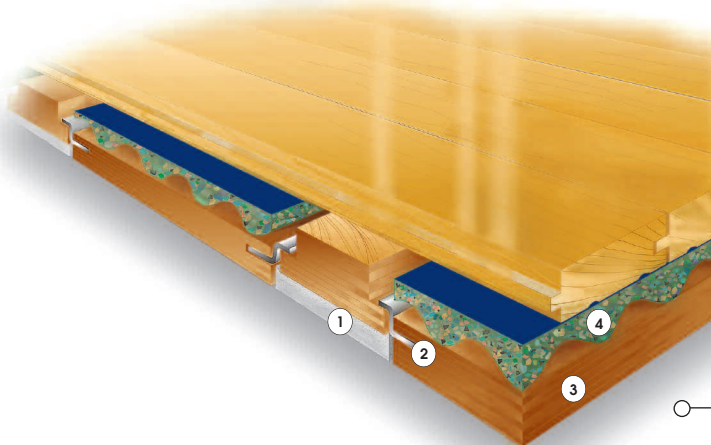

- ① Fastening Row Support Cushion
- ② Interlocking Heavy-Duty Steel Stability Channel
- ③ Anchored Cushion Support Plate
- ④ Impact Control Cushion made with recycled material

SPECIFICATIONS

MANUFACTURING	ISO9001:2000 CERTIFIED
U.S. PATENT #	6,122,873
SYSTEM TYPE	Fixed Resilient
ANCHORAGE	Continuous Channel (Design Group 1)
SUBFLOOR CONSTRUCTION	Engineered Panel
RESILIENCE	Blanket Pad
RECYCLED CONTRIBUTION	UniForce Subfloor System includes components with recycled content
SLAB DEPRESSION	25/32" (20 mm) flooring - 2" (51 mm) 33/32" (26 mm) flooring - 2 1/4" (57 mm)
DIN STATUS	D-I-N Meets or exceeds all the requirements of DIN 18032, part 2, 2001
TESTING LABORATORY	United States Sports Surfacing Laboratory
CERTIFIED TESTING	Laboratory test equipment calibrated and certified through the ISSS
GREEN STATUS	Managed forests, certification available

WALL BASE DETAIL

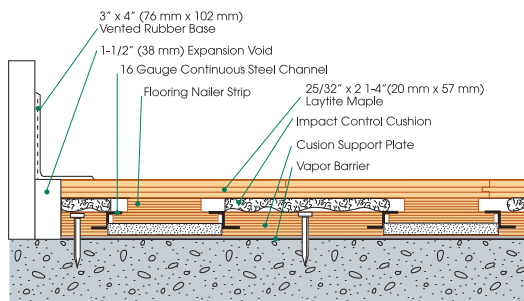

THRESHOLD DETAIL (optional accessory)

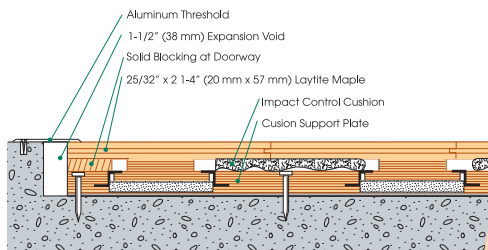

EQUIPMENT DETAIL (optional accessory)

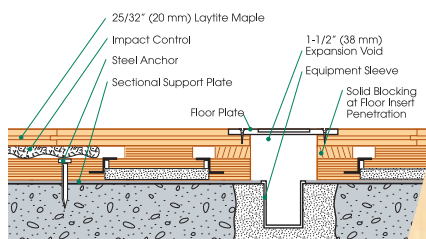

©2010 Connor® is a registered trademark of Connor Sport Court International

connorfloor.com
1.800.283.9522