



PERMALOCK™

FIXED RESILIENT

**FIXED
RESILIENT**
○○○
PERMALOCK

SYSTEM FEATURES AND BENEFITS

An anchored sports floor system providing great resistance to expansion and buckling. A fast and quiet floor, consisting in general of a vapor barrier, grooved underlayment, steel channels, clips, drivepins, maple flooring, sanding, sealers, finishes, game lines and wall base.

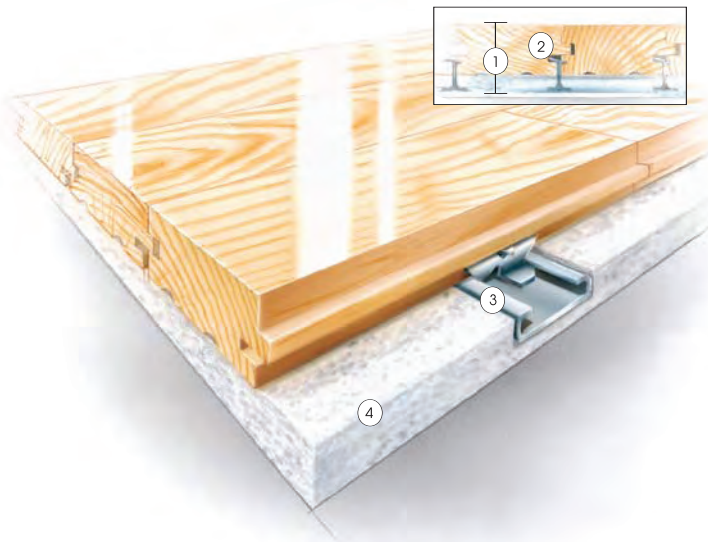

- ① Low profile
- ② Specially milled clip under tongue design
- ③ Heavy-duty, 16-gauge channel and clip
- ④ Multicellular closed cell polyethylene

SPECIFICATIONS

MANUFACTURING

ISO 9001:2008
CERTIFIED

SYSTEM TYPE

Fixed Resilient

SUBFLOOR CONSTRUCTION

Clip and Channel

RESILIENCE

Minimal

SLAB DEPRESSION

33/32" (26 mm) flooring - 1 1/2" (38 mm)
27/32" (21 mm) flooring - 1 1/4" (32 mm)

TESTING LABORATORY

United States Sports
Surfacing Laboratory



CERTIFIED TESTING

Laboratory test equipment
calibrated and certified through
the ISSS



GREEN STATUS

Managed forests,
certification available



WALL BASE DETAIL

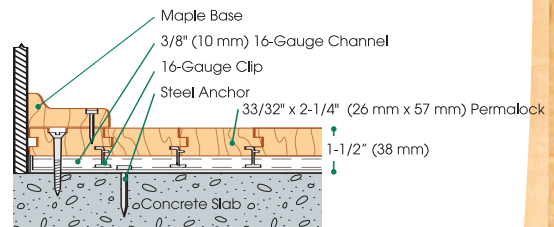

THRESHOLD DETAIL (optional accessory)

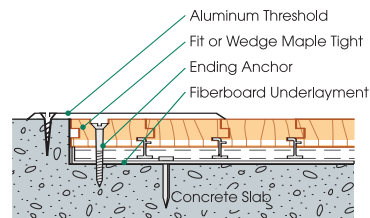

MULTISURFACE Detail (optional accessory)

