

F I X E D R E S I L I E N T

SYSTEM FEATURES AND BENEFITS

A floating sports floor system providing excellent stability and shock absorption with uniform high ball rebound, consisting in general of a vapor barrier, resilient Rezill pads, steel channel encased base and flex sleepers, plywood subfloor, maple flooring, sanding, sealers, finishes, game lines and wall base.

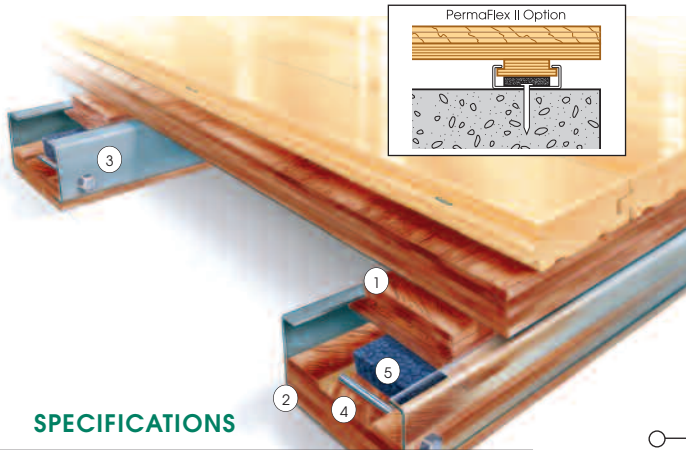

- ① Upper Flex Sleeper
- ② Lower Base Sleeper
- ③ Heavy Duty, buckle resistant steel channel provides great resistance to upward pressure
- ④ Protective Resilient Pad Encasement Slot
- ⑤ Rezill Pad

SPECIFICATIONS

MANUFACTURING

ISO9001:2000
CERTIFIED

U.S. PATENT

5,778,621

SYSTEM TYPE

Floating
(Concrete Attachment Optional)

ANCHORAGE

Continuous Channel
(Design Group 1)

SUBFLOOR CONSTRUCTION RESILIENCE

Sleeper and Plywood

Rezill Pads

RECYCLED CONTRIBUTION

PermaFlex Subfloor System includes components with recycled content.



SLAB DEPRESSION

PermaFlex		PermaFlex II	
	15/32" (12 mm) Plywood		
3" (76 mm)	25/32" (20mm) Flooring	2 1/2" (64 mm)	
3 1/4" (83 mm)	33/32" (26 mm) Flooring	2 3/4" (70 mm)	
	23/32" (18 mm) Plywood		
3 1/4" (83 mm)	25/32" (20 mm) Flooring	2 3/4" (70 mm)	
3 1/2" (89 mm)	33/32" (26 mm) Flooring	3" (76 mm)	

DIN STATUS



D·I·N

Meets or exceeds all the requirements of DIN 18032, part 2

TESTING LABORATORY



Unites States Sports Surfacing Laboratory

CERTIFIED TESTING



Laboratory test equipment calibrated and certified through the ISSS

GREEN STATUS



Managed forests, certification available.

WALL BASE DETAIL

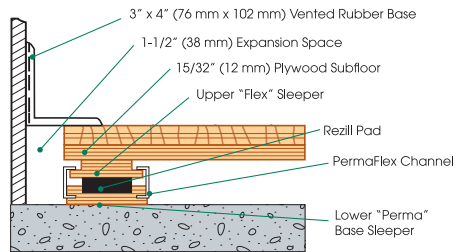

THRESHOLD DETAIL (optional accessory)

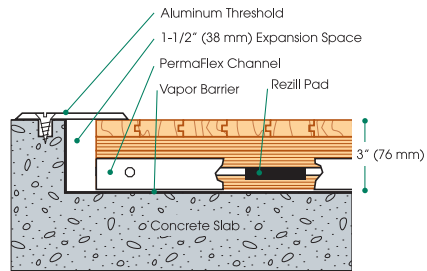

WALL BASE DETAIL (PermaFlex II)

