



DURACUSHION™ I

FLOATING SYSTEM
 ○ ○ ○
 DURACUSHION I

F L O A T I N G S Y S T E M

SYSTEM FEATURES AND BENEFITS

A floating sports floor system providing shock absorption, consisting in general of a vapor barrier, PVC pads, wood subflooring, maple flooring, sanding, sealers, finishes, game lines and wall base.

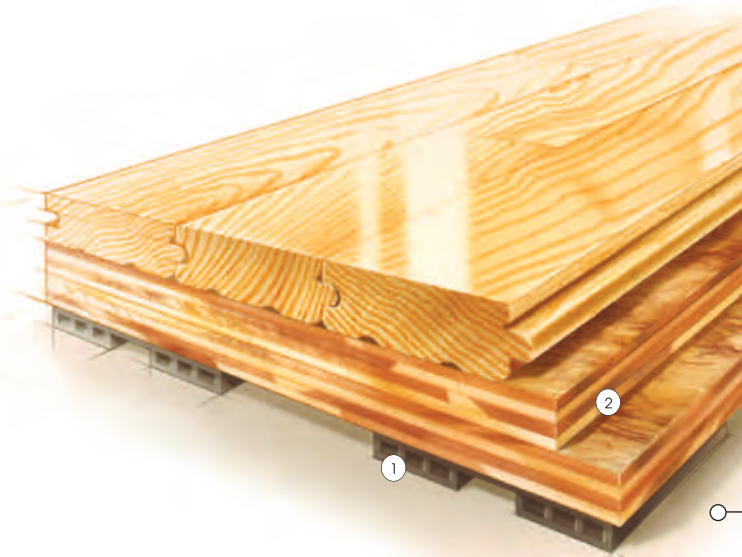

- ① 3/8" Duracushion PVC resilient pads
- ② Two layers of 15/32" APA rated plywood subfloor

SPECIFICATIONS

MANUFACTURING	ISO9001:2008 CERTIFIED
SYSTEM TYPE	Floating System
ANCHORAGE	No concrete attachment
SUBFLOOR CONSTRUCTION	Plywood Panel
RESILIENCE	PVC Pads
SLAB DEPRESSION	3/8" (10 mm) pad: 25/32" (20 mm) flooring - 2 1/8" (54 mm) 33/32" (26 mm) flooring - 2 3/8" (60 mm) 5/8" (10 mm) pad: 25/32" (20 mm) flooring - 2 3/8" (60 mm) 33/32" (26 mm) flooring - 2 5/8" (67 mm)
TESTING LABORATORY	United States Sports Surfacing Laboratory
CERTIFIED TESTING	ISSS Scientific Body Member Laboratory Testing
GREEN STATUS	Managed forests, certification available



WALL BASE DETAIL

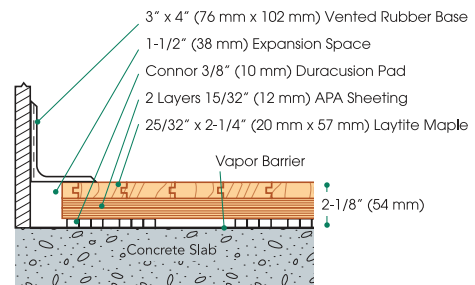

THRESHOLD DETAIL (optional accessory)

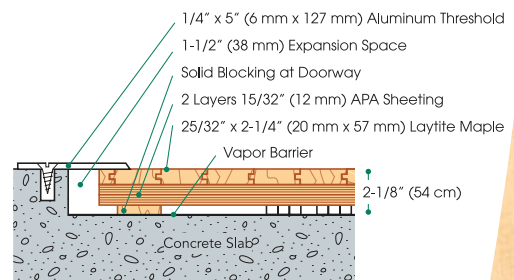

EQUIPMENT DETAIL (optional accessory)

