

F L O A T I N G S Y S T E M

SYSTEM FEATURES AND BENEFITS

Floating sports floor system providing shock absorption, consisting in general of a vapor barrier, PVC pads, softwood nailers, maple flooring, sanding, sealers, finishes, game lines and wall base.



- ① 3/8" Duracushion PVC resilient pads
- ② Nominal 2" x 3" Softwood Sleeper

SPECIFICATIONS

MANUFACTURING	ISO9001:2000 CERTIFIED
SYSTEM TYPE	Floating System
ANCHORAGE	No concrete attachment
SUBFLOOR CONSTRUCTION	Sleeper
RESILIENCE	PVC Pads
SLAB DEPRESSION	3/8" pad: 25/32" flooring – 2 5/8" 33/32" flooring – 2 7/8" 5/8" pad: 25/32" flooring – 2 7/8" 33/32" flooring – 3 1/8"
TESTING LABORATORY	United States Sports Surfacing Laboratory
CERTIFIED TESTING	Laboratory test equipment calibrated and certified through the ISSS
GREEN STATUS	Managed forests, certification available.

WALL BASE DETAIL

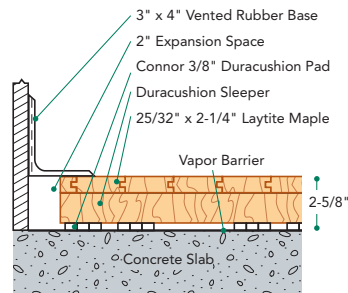

THRESHOLD DETAIL (optional accessory)

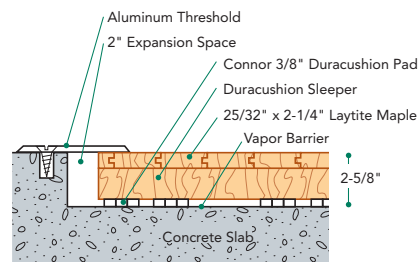

EQUIPMENT DETAIL (optional accessory)

