

REVISIONS				
ECN	REV.	DESCRIPTION	DATE	APPROVED
22019	A	RELEASE FOR PRODUCTION	07-13-23	

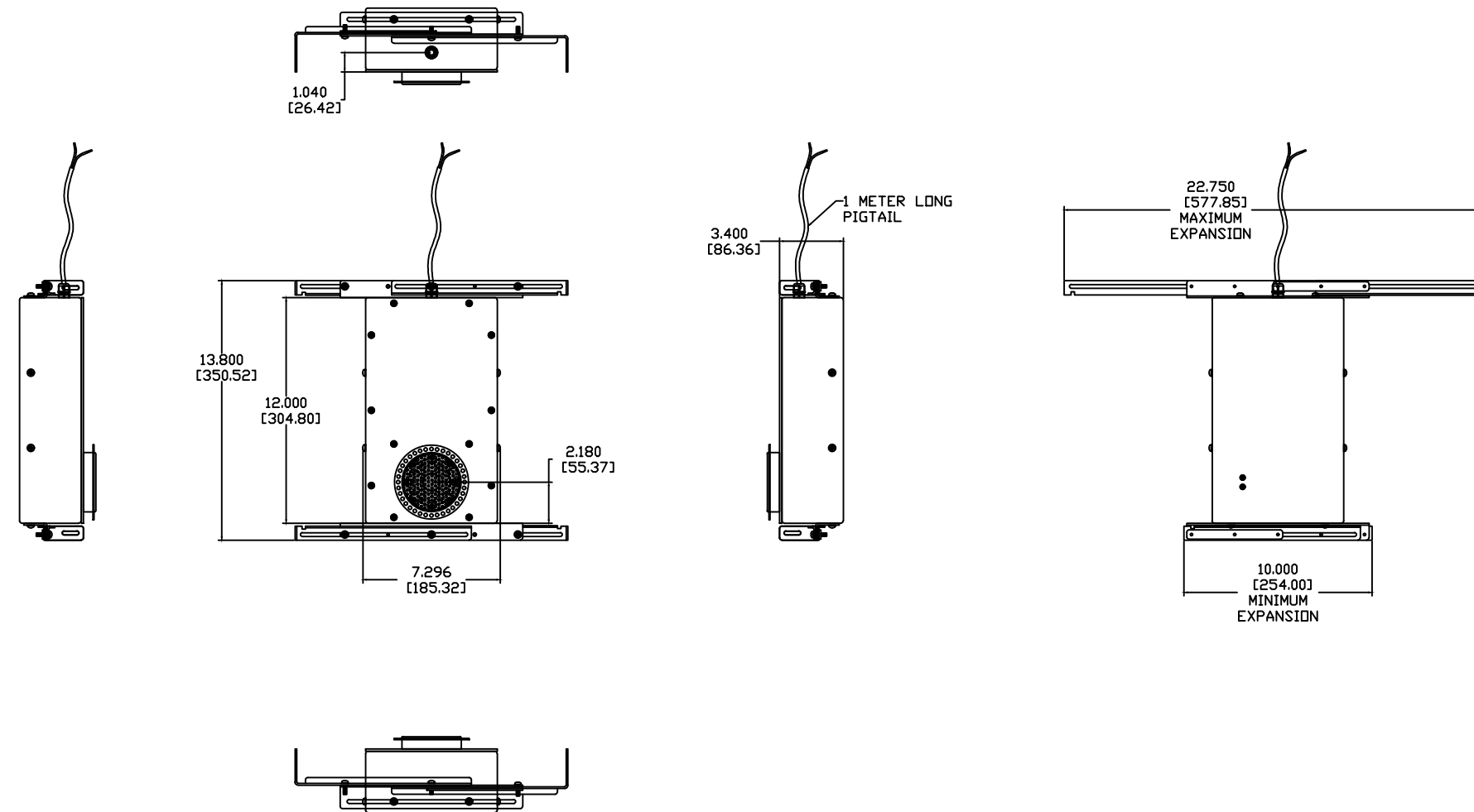

NOTES:

- 1: MATERIAL - 5052 ALUMINUM  
UNLESS OTHERWISE SPECIFIED
- 2: FINISH - TBD
- 3: MODULE (SA42M-4) AND TRIM KITS (SA3-GRILLE-X-XX & SA4-GRILLE-X-XX) ORDERED SEPARATELY
- 4: SPACERS REQUIRED FOR SHEETROCK/SURFACE MATERIAL THICKER THAN 1/2"
- 5: USE BRK.SA42.7-15.25 FOR STUD BAYS UNDER 10" IN WIDTH (ORDERED SEPARATELY)

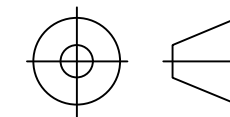

"THIRD ANGLE" PROJECTION

PROPRIETARY INFORMATION  
 THE DESIGNS, INFORMATION, AND DATA CONTAINED HEREIN ARE PROPRIETARY AND ARE SUBMITTED IN CONFIDENCE, AND SHALL NOT BE DISCLOSED, USED OR DUPLICATED IN WHOLE OR IN PART, FOR ANY PURPOSES WHATSOEVER, WITHOUT THE PRIOR WRITTEN PERMISSION OF JAMES LOUDSPEAKER LLC, 2185 PARK PL, MINDEN, NV 89423. THIS LEGEND SHALL BE MARKED ON ANY REPRODUCTIONS HEREOF IN WHOLE OR IN PART. RECEIPT OF THIS DOCUMENT SHALL BE DEEMED TO BE AN ACCEPTANCE OF THE CONDITIONS SPECIFIED HEREIN.

JAMES LOUDSPEAKER

SA42-4

EXTERNAL DIMENSIONS

P/N: -

DWR #: 220912-P101

REVISED BY: S. LOESCH

DRAWN BY: P. KADLEC

DATE: 09-12-22

APPROVED:

DRAFTING APPROVED:

SCALE:

TOLERANCES: ANG: ± = .5° FRACT. ± = 1/32  
 DECIMALS: .XX ± = .01 .XXX ± = .005

REVISION: A