

# Technical Data Sheet

## Solido Interior Panel System

Solido is a natural concrete finish fiber cement panel system for interior walls. Each panel is unique due to the natural curing process.

### Panel Specifications

| Property    |  | Profile |
|-------------|--|---------|
| Dimensions  | W: 455mm<br>L: 3030mm<br>T: 15mm           |         |
| Coverage    | 1.38 m <sup>2</sup> (15 ft <sup>2</sup> )  |         |
| Weight      | 62 lbs                                     |         |
| Application | Vertical or Horizontal                     |         |
| Finish      | Unfinished concrete with protective sealer |         |

### Accessories

| Accessories                                     | Stock # | Photo |
|---|---------|-------|
| 1 Panel Clip (5mm)                              | B1005   |       |
| 2 Starter Bar (5mm) for horizontal installation | B10052  |       |
| 3 Starter Bar (5mm) for vertical installation   | B10057  |       |

| Accessories                         | Stock # | Photo |
|-------------------------------------|---------|-------|
| 4 Clip Screw (19mm) for steel frame | RY8840  |       |
| 5 Face Screw (50mm) For steel frame | B88501  |       |
| 6 Spacer (5mm)                      | RY82S05 |       |

| Accessories         | Stock # | Photo |
|---------------------|---------|-------|
| 7 Face Nail (38mm)  | RM89S0  |       |
| 8 Clip Screw (25mm) | RY8830  |       |
| 9 Clip Screw (35mm) | B88352  |       |

### Installation

Please consult manufacturers installation manual for a complete set of details.

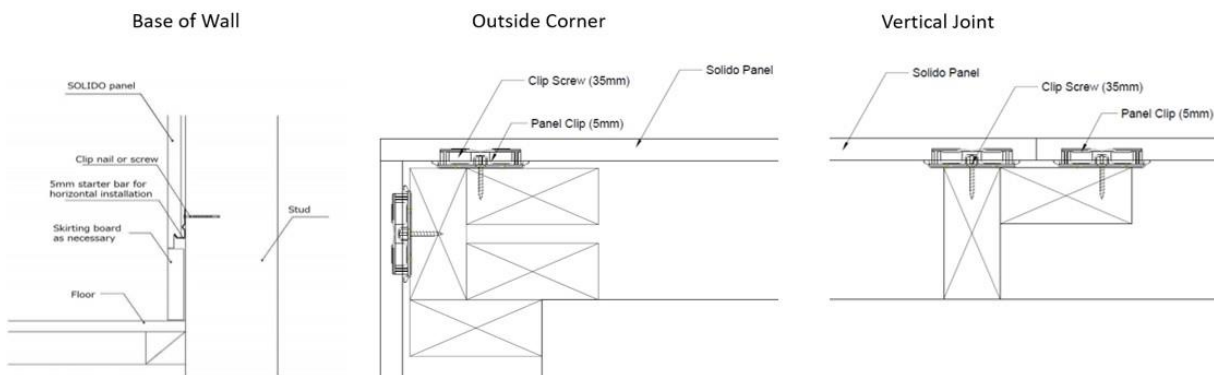

### Testing Data

| Property          | Result  | Test Method |
|-------------------|---------|-------------|
| Fire Rating       | Class A | ASTM E-84   |
| Specific Gravity  | 1.3     | JISA 5422   |
| Flexural Strength | >785N   | JISA 5422   |
| Impact Resistance | Passed  | JISA 5422   |

| Detectable VOCs | Reference Level | Solido Panel |
|-----------------|-----------------|--------------|
| Formaldehyde    | 5               | 1            |
| Toluene         | 38              | 4            |
| Xylene          | 120             | <0.2         |
| Ethyl Benzene   | 550             | <0.2         |
| Styrene         | 32              | <0.2         |
| Chlorpyrifos    | No Limit        | <0.2         |

Units: µg/m<sup>2</sup>hr

Test Method: JIS A 1901: 2015 Determination of the emission of volatile organic compounds and aldehydes in building products

**Minimum Recycled Content: 60%**

Pre-Consumer 55%  
Post-Consumer 5%