

# **UNDERCOVER** **SWING CASE**

**PRODUCT INSTALLATION GUIDE**  
**SC102 - CHEVY COLORADO/GMC CANYON 2004-CURRENT**



**For Warranty Issues, contact Customer Service  
(866) 900-8800 or visit [www.undercoverinfo.com](http://www.undercoverinfo.com)**



## PRE-INSTALLATION NOTES

### Thank you for purchasing the UnderCover Swing Case!

- Read instructions completely before installing your Swing Case to your truck.
- The Swing Case is designed for trucks that do not have a bedliner (spray in bedliners pose no problem). Trucks that do have plastic drop in bedliners or Bed Rugs will require some trimming of the liner to ensure proper fit of the brackets. We provide some guidelines for installing with liners, however due to the wide variety of liner manufacturers, the modifications will vary. Any modifications must be made to the liner and NOT to the Swing Case mounting hardware. Modifications to the mounting hardware could result in improper installation and will void your warranty.
- The Swing Case is left and right specific. They will not interchange.
- ⚠ The Swing Case will not work with bed extenders.
- Upon opening the Swing Case lid there could be an odor of glue. This is a non toxic adhesive that we use during the assembly of the box. The odor will go away as the lid is opened and closed a few times.

## INSTALLATION KIT CHECKLIST

- A. Box Bracket (*factory installed on box*)
- B. Truck Bracket
- C. Striker Bracket
- D. Self tapping screw 1/4" x 1" (qty 8)
- E. Foam block

## INSTALLATION TOOLS NEEDED

1. Electric or cordless drill
2. Tape measure
3. 7/16" driver or socket/adaptor
4. 3/8" wrench

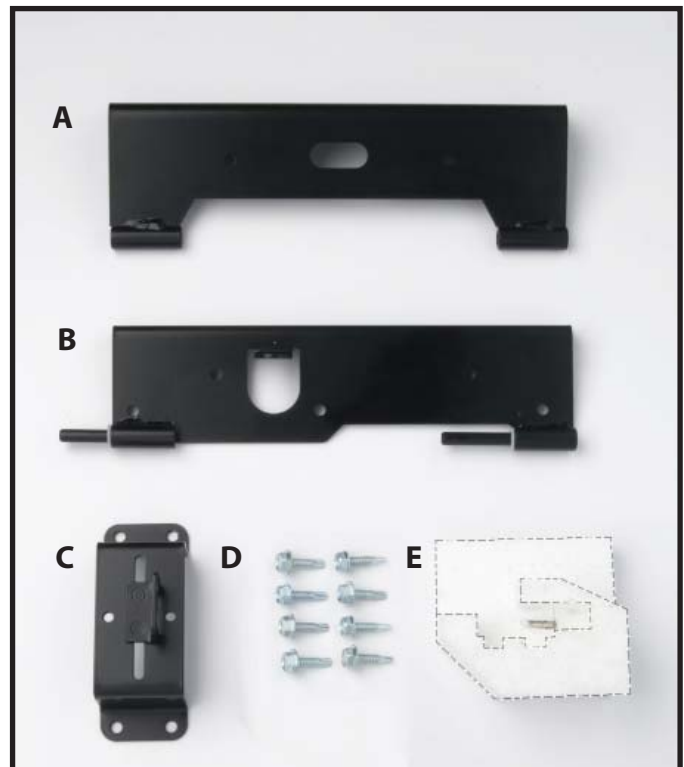

For Warranty Issues, Contact Customer Service  
(866) 900-8800 or visit [www.undercoverinfo.com](http://www.undercoverinfo.com)



**STEP 1**

Measure up the vertical post at the rear of the truck and make a mark at 13/4" (photos 1 and 2).



**STEP 2**

Position the Truck Bracket with the bottom lined up with the mark you just made (photo 3). You can use masking tape to help hold the bracket in position, make sure it is 90 degrees to the bed floor, measure from the top of the pin to the inside edge of the tailgate to verify that it is straight (photos 4 and 5). Placing one of the 1/4" x 1" screws through the lowest hole, attach the bracket (photo 6), be careful not to overtighten and strip out the screw hole. Double check to make sure it is still 90 degrees to the truck bed floor, you can still pivot the bracket a little if needed. Finish attaching the bracket using three more of the 1/4" x 1" screws. (photo 7).



**STEP 3**

Position the foam block on the latch (**photo 8**). Push the striker into the slot in the foam block until it latches (**photo 9**). Lower the box onto the hinge (**photo 10**).



For Warranty Issues, Contact Customer Service  
(866) 900-8800 or visit [www.undercoverinfo.com](http://www.undercoverinfo.com)



### STEP 4

Push the box to the stowed position against the side of the truck bed. The foam block will hold the striker while you position it. You may need to loosen the two  $\frac{3}{8}$ " nuts on the back of the striker and slide it forward or back. The goal is to have it flush with the the bed side and parallel to the bed floor. The diagram below shows the aproximate location in reference to the wheel well and to the bed floor.

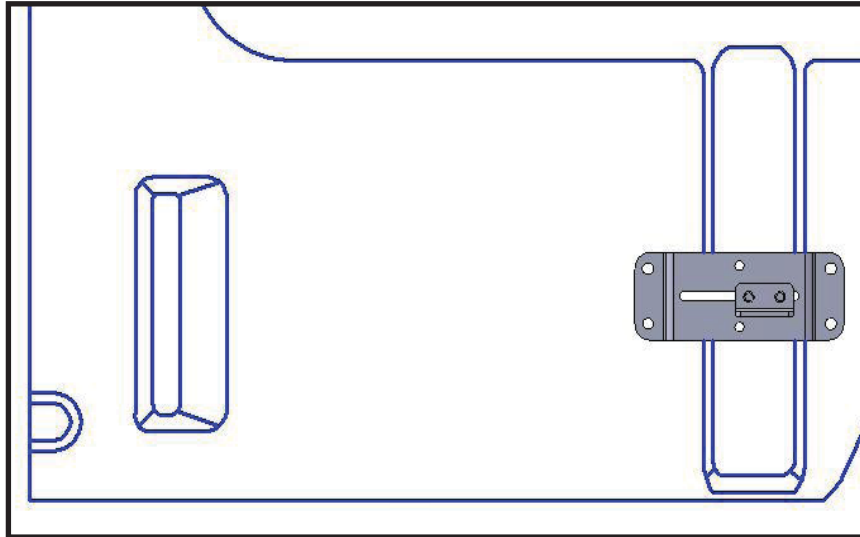

### STEP 5

Once you are satisfied with the position of the striker, place one of the  $\frac{1}{4}$ " x 1" screws through the lower hole (**photo 11**), be careful not to overtighten and strip out the screw hole. If your drill will not fit between the box and the wheel well, it may be necessary to mark the holes prior to drilling (**photo 12**). Release the box and swing out, dispose of the foam block. Make sure the striker bracket is straight, install the last three screws (**photo 13**). Tighten the two  $\frac{3}{8}$ " nuts on the back of the striker (**photo 14**). Gently swing the box to the stowed position, it should latch and unlatch easily. If needed you can adjust the striker forward or back by loosening the two  $\frac{3}{8}$ " nuts on the back of the striker. Be sure to blow or sweep the metal shavings out of the bed.



• CONGRATULATIONS!

You have just installed the most versatile tool box on the market.



**FOR TRUCKS WITH PLASTIC BED LINERS**

For trucks with plastic bed liners it will be necessary to trim the liner. **⚠ DO NOT INSTALL THE BRACKETS ON TOP OF THE BEDLINER.** The brackets will not fit over the plastic bedliner, the brackets must be attached directly to the sheet metal.

Hold the brackets up against the bedliner in their approximate location. Using a grease pencil, mark lines to indicate where to cut the bedliner (**Picture 7**). Once you have finished trimming your bedliner, install the brackets (**Picture 8**) per the instructions in Steps 1 through 5 (previous pages). Due to the fact that all the brands of bed liners fit differently we can not provide exact instructions as how much of your liner to trim. These pictures are only an example and may not accurately depict your specific situation.



**FOR TRUCKS WITH BED RUGS**

For trucks with Bed Rugs it will be necessary to cut slots in the material. **⚠ DO NOT INSTALL THE BRACKETS ON TOP OF THE BED RUG.** Most of the brackets will fit under the bed rug, pull the Bed Rug loose from the corner, remove any hook and loop strips that may be in the way of the brackets, and install the brackets per instructions in Steps 1 through 5 (previous pages).

Push the rug around the latch bracket and cut a slot to allow it to stick through. Push the rug around the pad lock piece and cut a slot to allow it to stick through (**Picture 9 and 10**). You will need to re-attach the Bed Rug to the truck bracket at the light well using the existing hook and loop strips.

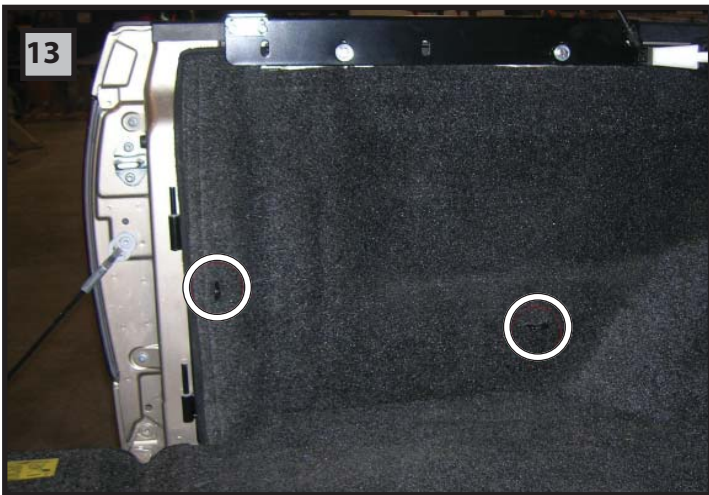



## 1 YEAR LIMITED WARRANTY

**Terms of this Warranty.** E. D. Industries, Inc. warrants that the ABS polymer structure of your Swing Case will be structurally free from defects in material and workmanship for (1) one year from the retail date of purchase. The lock, hinges, and hardware are warranted to be free from defects in material and workmanship for (1) one year from the retail date of purchase. This warranty applies only to the original purchaser and is nontransferable. Your original sales receipt will serve as proof of purchase for this warranty. **Be sure to retain your receipt for your proof of purchase date.** Before credit can be issued on a warranty claim, proof of defect may be required. This can be determined at the time of the claim.

**Exclusions of this Warranty.** Not covered under this warranty is failure due to neglect, improper installation including any modifications to installation hardware, alterations, addition of equipment, abuse, accident, weather related damage exposure to chemicals that are not labeled "safe for plastics", and normal wear from lack of maintenance.

**Caution.** Always read the ingredients of any product you are using to clean your Swing Case. Make sure that you use only products that are safe for use with plastics. Many chemicals contain material that will permanently discolor your Swing Case. This is not considered a manufacturer defect.

**Owner Responsibilities.** Incidental or consequential damage or loss of contents due to use, neglect, lack of maintenance, misuse, or abuse of the Swing Case is the sole responsibility of the truck owner and operator. Paint damage to your truck is not covered under this warranty. When operating your truck always keep the Swing Case in the stowed position with the lid closed and latched.

**Repair and Replacement.** In the event that your Swing Case is found to be defective under the terms of this warranty, it is at the discretion of E. D. Industries, Inc. to repair or replace the defective part. All repairs must be made by an authorized Swing Case dealer or under the direction by the factory. In the case of either event, E. D. Industries, Inc. is not responsible for any transportation costs associated with the warranted claim.

**Maintenance & Care.** The ABS polymer body of your Swing Case requires only periodic cleaning with mild car wash soap. **ONLY USE CLEANERS, WAXES OR PRODUCTS THAT ARE LABELED "Safe for use on plastics"**. Do not let chemicals or substances come into contact with your Swing Case, unless labeled "safe for plastics". Avoid use of all abrasive type cleaners as they may dull the finish. Be sure that products such as OFF® or other insecticides do not get onto the Swing Case from contact with your hands or other parts of your body. This could cause serious damage and discoloration.



E. D. Industries, Inc. / UnderCover • P.O. Box 620 • Rogersville, MO 65742

"If the quality is built-in, you know it's an UnderCover!"

Customer Service: (417) 753-8000 • (866) 900-8800

[www.undercoverinfo.com](http://www.undercoverinfo.com)

[sales@undercoverinfo.com](mailto:sales@undercoverinfo.com)

© 2008 E. D. Industries, Inc.  
All Rights Reserved.

