

Holy Cross Catholic School Transportation Information 2012-2013

Bussing Boundary

The Holy Cross School Board of Directors approved a Bussing Boundary. The boundary map is located at the bottom of this page. The following is the approved boundary policy, as stated in the "Holy Cross Bussing Policy".

II. Bussing boundaries

In order to operate within our budget and maintain acceptable bus route lengths, it is necessary to limit the area where we can offer bussing services. The boundary will be defined by the Board of Directors with consultation from the Transportation Director and the Principal. In certain circumstances, the Principal may make exceptions to the boundary. Exceptions should be rare and should not be made if they result in increased expenses to the bussing program. Families outside the boundary who received bussing before the implementation of this policy, may receive an exception on a year-by-year basis. However, this exception is not guaranteed.

Transportation Form Must Be Completed by May 25, 2012:

AFTER SUBMITTING THE REQUIRED REGISTRATION MATERIAL to Holy Cross Catholic School, a Transportation Form must be completed by every family. The Transportation Form can be filled out manually (see reverse side) or online. Visit the Holy Cross Catholic School website at www.holycrossschool.net. and click on the *Registration* heading located at the top of the home page. Under *Kindergarten through 8th Grade Registration*, click on "Online Transportation Form."

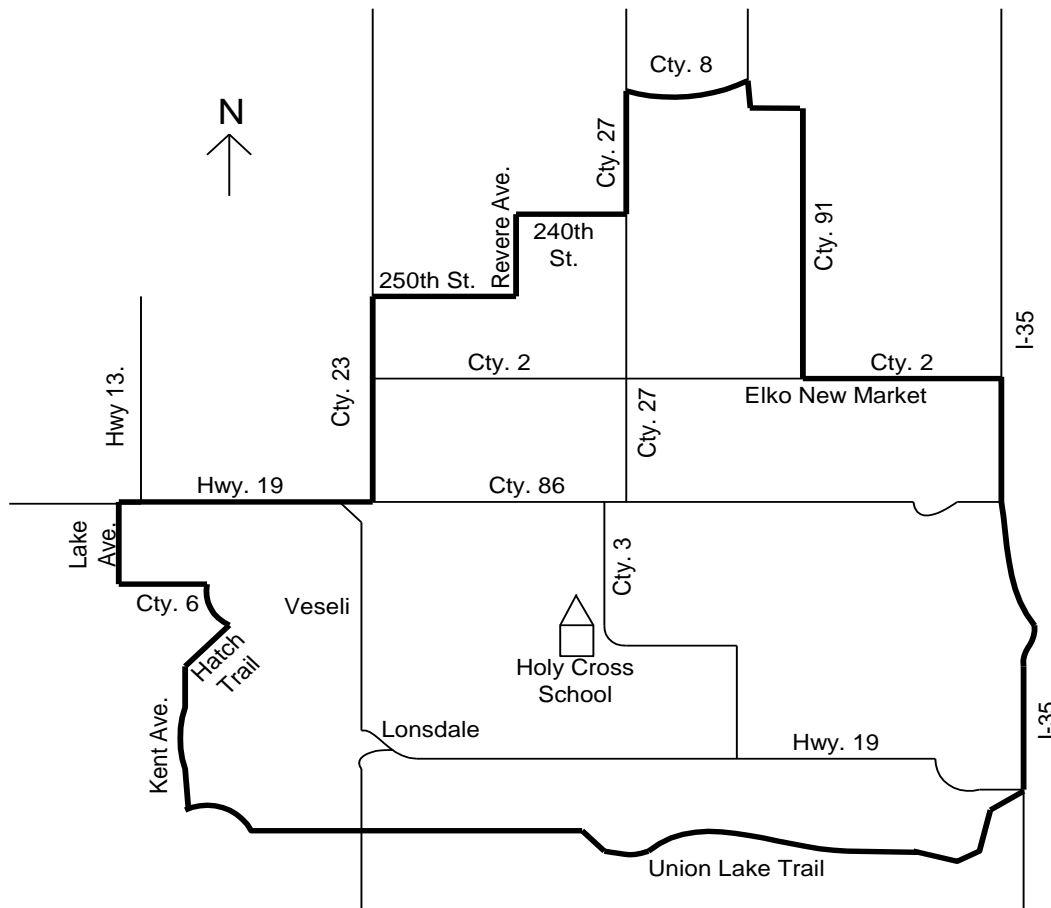

**Holy Cross Catholic School
Transportation Form
2012-2013**

Every Holy Cross School family must complete this form.

Form must be returned to the school office by **May 25, 2012**.

Family Name _____ **Phone #** _____

of Children _____

Please check the one box that applies to your family.

- We will not be using Holy Cross Transportation for the coming school year. We understand this to mean we will provide our own transportation to and from school.

- We live outside the bussing boundaries and are requesting an exception. Please send us a Transportation Exception Form.

- We reside or attend daycare within the bussing boundaries and will use Holy Cross Transportation for the coming school year. (Complete the information below.)

This portion should be completed if you
will be using Holy Cross Transportation.

Morning Pick Up

Address

If not parent, name and phone number
of caregiver.

Afternoon Drop Off

Address

If not parent, name and phone number
of caregiver.

Parent/Guardian Signature

Date

