



**Gordon House Road, NW5**  
**£715,000, Freehold**



A spacious three double bedroom maisonette of 920 square feet, with a pleasant south-facing terrace, arranged over the top two floors of a handsome Victorian terrace. and situated within a very short walk of the Heath







## Gordon House Road, NW5

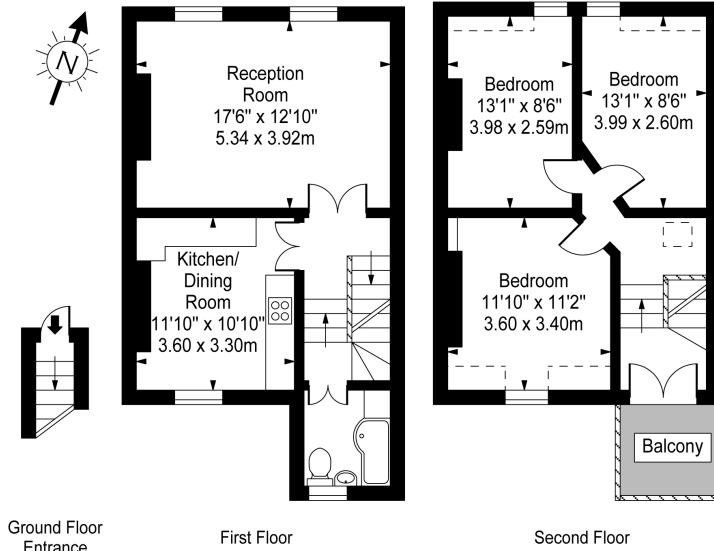

**Approx Gross Internal Area    920 Sq Ft - 85.51 Sq M**  
(Excluding Restricted Height Area)

For Illustration Purposes Only - Not To Scale    Floor Plan by [www.nogaphotostudio.com](http://www.nogaphotostudio.com)    Ref: No. 27815

This floor plan should be used as a general outline for guidance only. Any intending purchaser or lessee should satisfy themselves by inspection, searches, enquiries and full survey as to the correctness of each statement. Any areas, measurements or distances quoted are approximate and should not be used to value a property or be the basis of any sale or let.

Salter Rex give notice to anyone reading these particulars that: (i) these particulars do not constitute part of an offer or contract; (ii) these particulars and any pictures or plans represent the opinion of the author and are given in good faith for guidance only and must not be construed as statements of fact; (iii) nothing in the particulars shall be deemed a statement that the property is in good condition otherwise; we have not carried out a structural survey of the property and have not tested the services, appliances or specified fittings.

## Long Description

A bright and spacious three bedroom maisonette, occupying the upper levels of a four storey Victorian end-terraced house, ideally placed for easy access to Gospel Oak Overground Station (North London Line) and within a very short walking distance of Hampstead Heath. A variety of shops, restaurants, leisure and cultural amenities are also close by.

The accommodation is conveniently arranged and well presented throughout, offering a good-size reception and eat-in kitchen on the first floor with three good size bedrooms on the second floor. To the rear is a terrace with a pleasant southerly aspect