

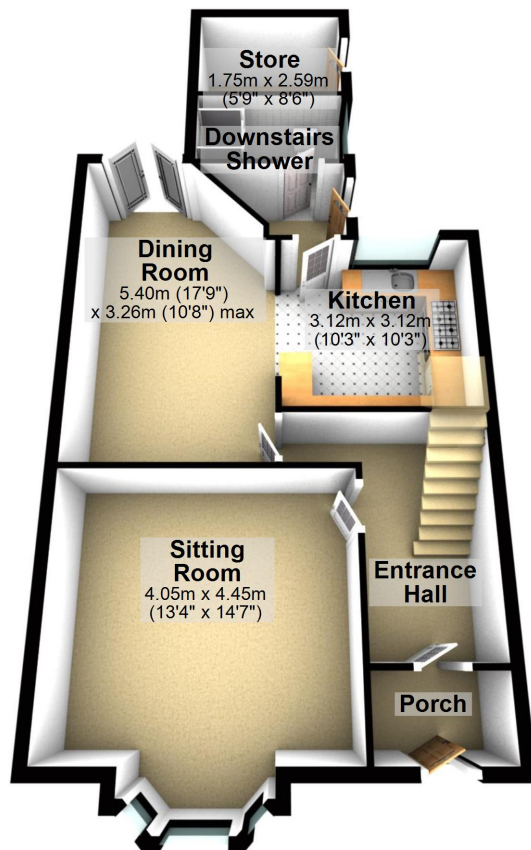

- Click video for key facts
- Selling the FACTS not the FLOWER
 - 4 Bedroom mid terrace house
 - Rear Yard
 - Centrally heated
 - Double glazed



Ground Floor



First Floor

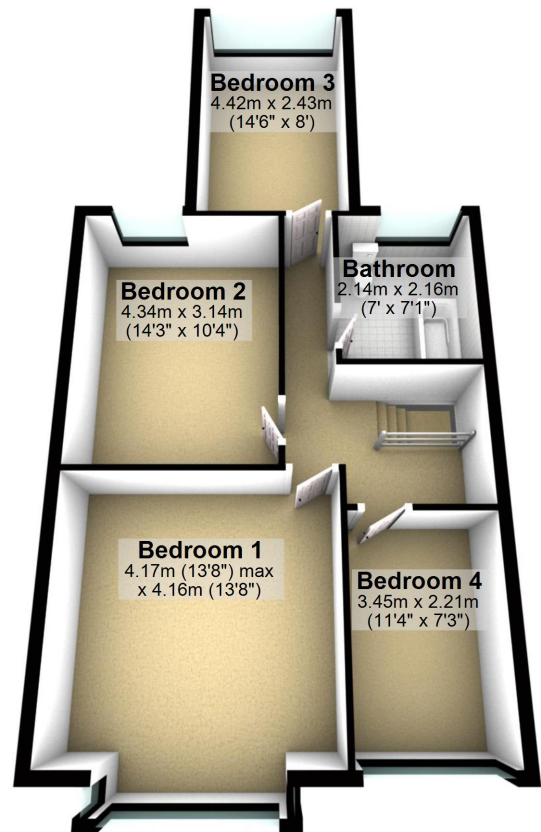

These particulars do not form part of any offer or contract and must not be relied upon as statements or representations of fact. Any areas, measurements or distances are approximate. The text, photographs and plans are for guidance only and are not necessarily comprehensive. It should not be assumed that the property has all the necessary planning, building regulation or other consents and we have not tested services, equipment or facilities. Purchasers must satisfy themselves by inspection or otherwise.

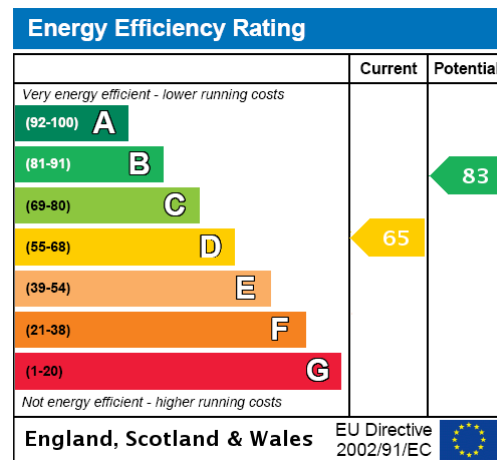

SELLING THE FACTS NOT THE FLOWER!

For all room sizes / dimensions please see the floorplans.

Title Number - MS16464

Tenure - Freehold

Local Authority - Sefton Council

Council Tax - Band:C
Annual Price: £1,815.55

Conservation Area - No

Flood Risk - Very Low

Floor Area - 1,539.24 ft² / 143 m²

Plot size - 0.03 acres

Mobile coverage
Vodafone - Great
Three - Great
O2 - Great

Broadband
Basic 17 Mbps
Superfast 80 Mbps
Ultrafast 1000 Mbps

Satellite / Fibre TV Availability
BT - Great
Sky - Great
Virgin - Great

(Data sourced from Sprift)

97 | SOUTH ROAD | WATERLOO | L22 0LR
Tel: 0151 920 2404
E-mail: info@logicstates.co.uk





'UNUSUALLY GOOD AT WHAT WE DO'

Buy, Sell or Let with the agent of the decade - Zoopla customer excellence award 2020

These particulars do not form part of any offer or contract and must not be relied upon as statements or representations of fact. Any areas, measurements or distances are approximate. The text, photographs and plans are for guidance only and are not necessarily comprehensive. It should not be assumed that the property has all the necessary planning, building regulation or other consents and we have not tested services, equipment or facilities. Purchasers must satisfy themselves by inspection or otherwise.