



# BROOK STREET



£2,650 PER WEEK  
FURNISHED

**WETHERELL**  
MAYFAIR'S FINEST PROPERTIES

102 Mount Street · London · W1K 2TH  
T: 020 7529 5588 E: [rentals@wetherell.co.uk](mailto:rentals@wetherell.co.uk)  
[wetherell.co.uk](http://wetherell.co.uk)

NO-ONE KNOWS MAYFAIR BETTER THAN WETHERELL





## BROOK STREET



This brand new three bedroom apartment has been finished to the highest specification providing elegance, quality and contemporary living as well as charming views overlooking the courtyard and the classic architecture of Bond Street.

THREE DOUBLE BEDROOMS • THREE LUXURY BATHROOMS • AIR CONDITIONING  
• PRIVATE ROOF TERRACE • GAGGENAU KITCHEN • BRAND NEW RENOVATION

---

NO-ONE KNOWS MAYFAIR BETTER THAN WETHERELL







## BROOK STREET

This brand new three bedroom apartment has been finished to the highest specification providing elegance, quality and contemporary living as well as charming views overlooking the courtyard and the classic architecture of Bond Street.

This impressive apartment spanning over 1,900 sq.ft provides the very best finishes and technology of a new home and includes a 336 sq.ft private roof terrace with views across Bond Street.

The historic, restored facade features exquisite stone carvings and generous windows which fill the rooms with light. Every element, from the home entertainment system to the bespoke kitchens and bathrooms, is of exceptional quality.

Further benefits include secure entry systems and CCTV, secure bicycle storage area and lift access.

Brook Street sits between the world-class, luxury retail offering on Bond Street and the elegantly landscaped Hanover Square. From 2022, Hanover Square's new Bond Street underground station will provide direct access to the Elizabeth line.

### Accommodation:

- \* Three Double Bedrooms
- \* Three Luxury Bathrooms
- \* Air Conditioning
- \* Private Roof Terrace
- \* Gaggenau Kitchen
- \* Brand New Renovation

\*Wetherell & Co. (Mayfair) Ltd. is a member of the RICS Client money protection Scheme, and also a member of the NAEA, ARLA Propertymark and the property Ombudsman which are Redress schemes. Any Tenancy that falls outside of the housing act will be subject to Tenant fees. You can find out more details on the Wetherell website or by contacting us directly.

**£2,650 PER WEEK**  
FURNISHED

Wetherell have no authority to make or give any representations or warranties in relation to the property. These particulars do not form part of any offer or contract and must not be relied upon as statements or representations of fact. Any areas, measurements or distances are approximate. The text, photographs and plans are for guidance only and are not necessarily comprehensive. It should not be assumed that the property has all the necessary planning, building regulation or other consents and Wetherell have not tested any services, equipment or facilities. Purchasers must satisfy themselves by inspection or otherwise. 2021

**WETHERELL**  
MAYFAIR'S FINEST PROPERTIES

102 Mount Street · London · W1K 2TH  
T: 020 7529 5588 E: [rentals@wetherell.co.uk](mailto:rentals@wetherell.co.uk)  
[wetherell.co.uk](http://wetherell.co.uk)

NO-ONE KNOWS MAYFAIR BETTER THAN WETHERELL





## BROOK STREET

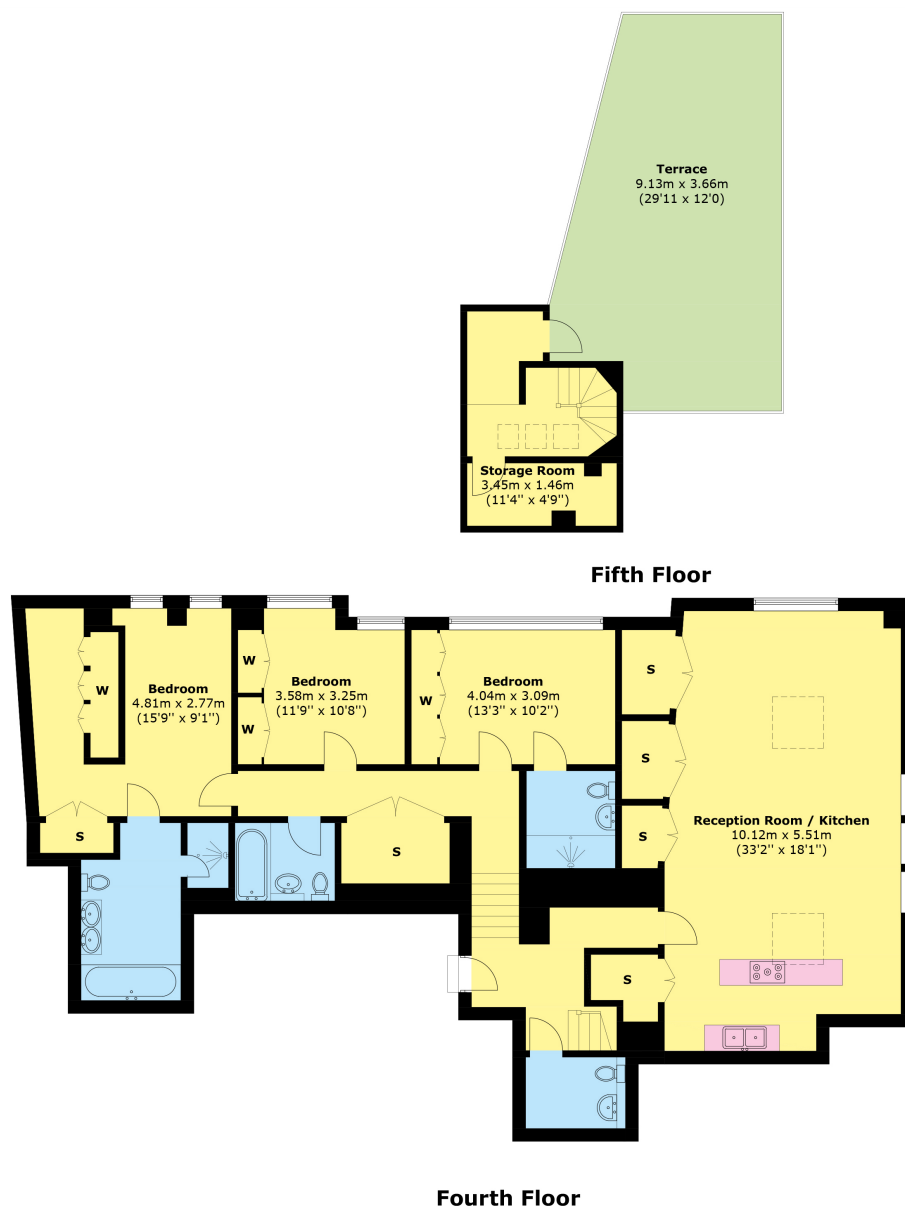

Area (approx.): 178.3 sq. m (1919.6 sq. ft)  
Terrace area: 41.3 sq. m (444.5 sq. ft)

Wetherell have no authority to make or give any representations or warranties in relation to the property. These particulars do not form part of any offer or contract and must not be relied upon as statements or representations of fact. Any areas, measurements or distances are approximate. The text, photographs and plans are for guidance only and are not necessarily comprehensive. It should not be assumed that the property has all the necessary planning, building regulation or other consents and Wetherell have not tested any services, equipment or facilities. Purchasers must satisfy themselves by inspection or otherwise. 2021

## WETHERELL

MAYFAIR'S FINEST PROPERTIES

102 Mount Street · London · W1K 2TH  
T: 020 7529 5588 E: [rentals@wetherell.co.uk](mailto:rentals@wetherell.co.uk)  
[wetherell.co.uk](http://wetherell.co.uk)

NO-ONE KNOWS MAYFAIR BETTER THAN WETHERELL

