

Lichfield Avenue  
Waterloo, L22

Freehold  
£240,000



- Buy, Sell or Let with the agent of the decade
- Zoopla customer excellence award 2020
- Four bedroom semi detached house
  - Rear garden
  - Driveway
  - Centrally heated



97 | SOUTH ROAD | WATERLOO | L22 0LR  
Tel: 0151 920 2404  
E-mail: [info@logicstates.co.uk](mailto:info@logicstates.co.uk)



## Ground Floor

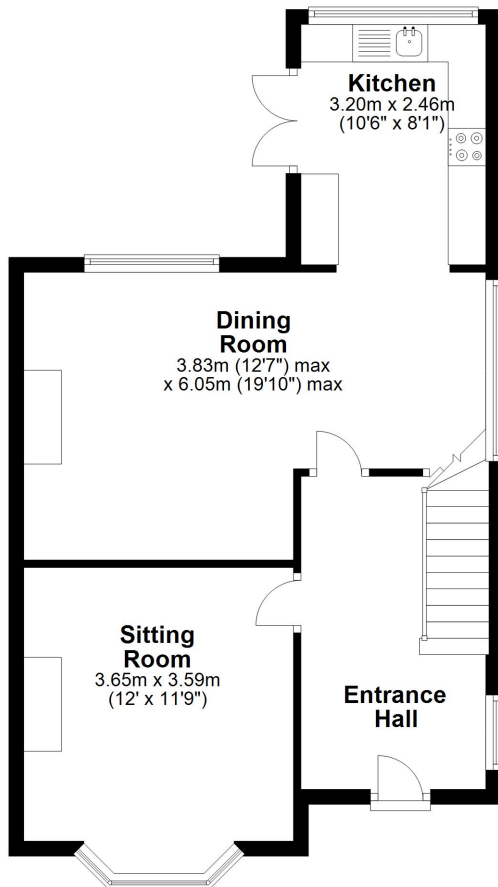

## First Floor

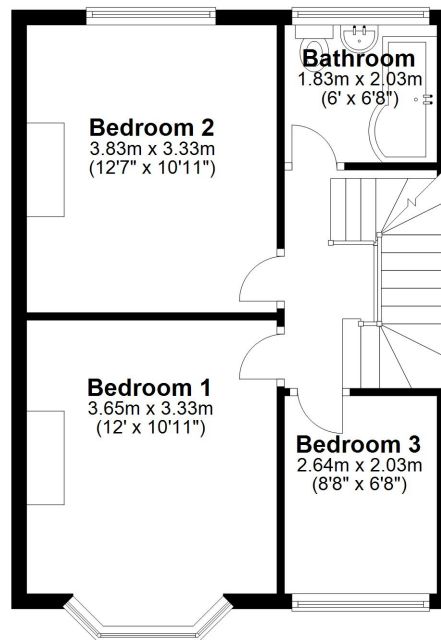

## Second Floor

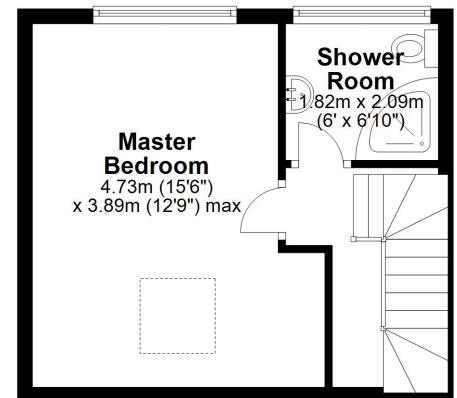

These particulars do not form part of any offer or contract and must not be relied upon as statements or representations of fact. Any areas, measurements or distances are approximate. The text, photographs and plans are for guidance only and are not necessarily comprehensive. It should not be assumed that the property has all the necessary planning, building regulation or other consents and we have not tested services, equipment or facilities. Purchasers must satisfy themselves by inspection or otherwise.



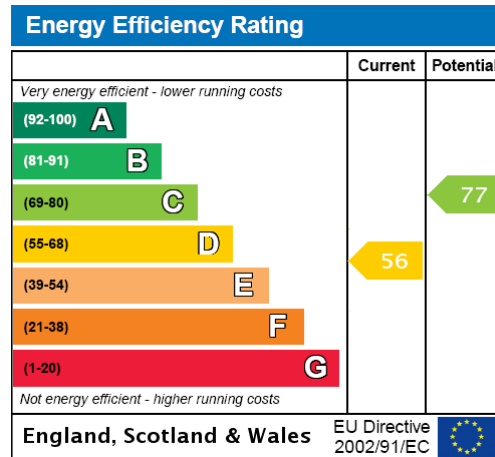

## SELLING THE FACTS NOT THE FLOWER!

For all dimensions / room sizes please see the floorplans.

Property type - Semi-detached House

Tenure - Freehold

Title Number  
MS181588 - (148 Sq.M.) - Freehold - Privately owned

Listed Building - No

Number of Bedrooms - 4

Internal area - 1,324 Sq.Ft. (123 Sq.M.)

Plot/Land Area - 0.04 Acres (148.15 Sq.M.)

Broadband connectivity - Ultrafast broadband

Mobile coverage - Excellent

EPC Rating - (2013) 56 (D) Potential 77 (C)

Conservation Area - N/A

Flood Risk - None

Council Tax Band - C (£1,740 p/yr)

Borough - Sefton

Planning Permission Applications - 0

Planning Potential (Based on properties with planning on street) - Low

97 | SOUTH ROAD | WATERLOO | L22 0LR  
Tel: 0151 920 2404  
E-mail: [info@logicstates.co.uk](mailto:info@logicstates.co.uk)





Estimated Stamp Duty  
£0 (Standard Rate)  
£0 (First Time Buyer)  
£6,510 (Additional Property)

Homesearch Rental Estimate  
£1000 pcm  
5% Yield

(Data sourced from homesearch)

'UNUSUALLY GOOD AT WHAT WE DO'

These particulars do not form part of any offer or contract and must not be relied upon as statements or representations of fact. Any areas, measurements or distances are approximate. The text, photographs and plans are for guidance only and are not necessarily comprehensive. It should not be assumed that the property has all the necessary planning, building regulation or other consents and we have not tested services, equipment or facilities. Purchasers must satisfy themselves by inspection or otherwise.