

Westcombe Lodge Drive, UB4 £149,950, Leasehold



No upper chain for this refurbished 1 bedroom first floor, 24 hour warden controlled (over 55's) retirement apartment.

Lounge views over pretty communal gardens. fitted kitchen with integrated appliances, double bedroom with mirror fronted fitted wardrobes, luxury shower room, residence & visitors parking, social lounge with regular activities & events (subject to current Covid regulations). Close to local bus routes and local shops including Iceland





First Floor

Approx. 39.5 sq. metres (425.5 sq. feet)

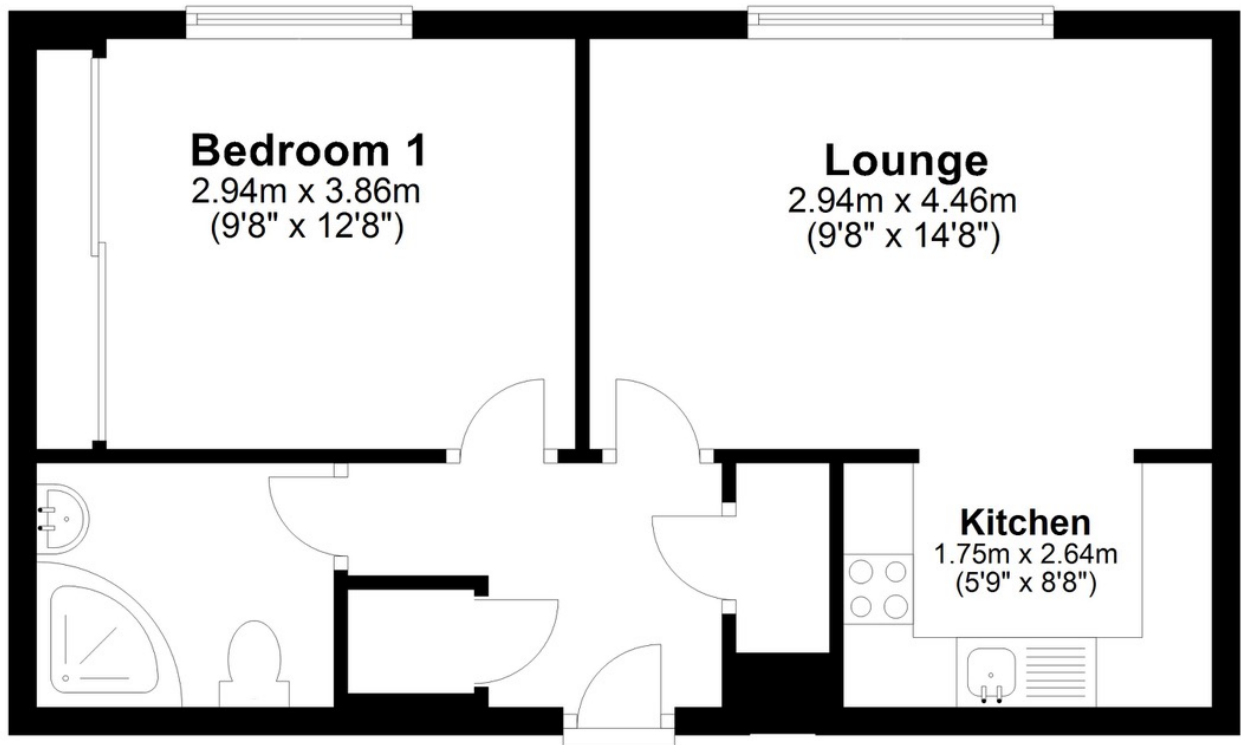

Total area: approx. 39.5 sq. metres (425.5 sq. feet)

All measurements are approximate and not to scale.
Plan produced using PlanUp.

broads property services give notice to anyone reading these particulars that: (i) these particulars do not constitute part of an offer or contract; (ii) these particulars and any pictures or plans represent the opinion of the author and are given in good faith for guidance only and must not be construed as statements of fact; (iii) nothing in the particulars shall be deemed a statement that the property is in good condition otherwise; we have not carried out a structural survey of the property and have not tested the services, appliances or specified fittings.

Long Description

Lounge views over pretty communal gardens. fitted kitchen with integrated appliances, double bedroom with mirror fronted fitted wardrobes, luxury shower room, residence & visitors parking, social lounge with regular activities & events (subject to current Covid regulations). Close to local bus routes and local shops including Iceland