

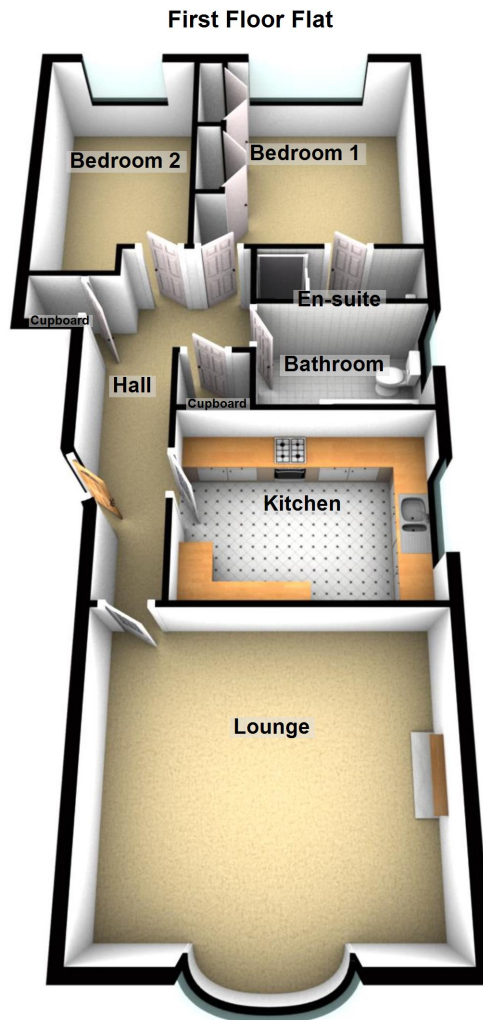

- Two bedroom first floor apartment
- Garage
- Communal gardens
- Centrally heated
- Double glazed
- 0.4 miles to Blundellsands and Crosby train station





Dowhills Court, Liverpool

These particulars do not form part of any offer or contract and must not be relied upon as statements or representations of fact. Any areas, measurements or distances are approximate. The text, photographs and plans are for guidance only and are not necessarily comprehensive. It should not be assumed that the property has all the necessary planning, building regulation or other consents and we have not tested services, equipment or facilities. Purchasers must satisfy themselves by inspection or otherwise.



Energy Efficiency Rating		
	Current	Potential
Very energy efficient - lower running costs		
(92-100) A		
(81-91) B		
(69-80) C	79	79
(55-68) D		
(39-54) E		
(21-38) F		
(1-20) G		
Not energy efficient - higher running costs		
England, Scotland & Wales	EU Directive 2002/91/EC	

NEW!!! "ANY HOUR" Viewing Booking System - Visit <http://logicstates.co.uk/> to book and confirm your viewing online!

Two bedroom first floor apartment situated in Blundellsands, L23 with excellent local amenities, transport links and access into Liverpool City Centre. This property benefits from having a breakfast bar in the kitchen, garage and communal gardens. Dowhills Court is situated 0.4 miles to Blundellsands and Crosby train station and 1 mile to Crosby beach.

Accommodation comprises of:

Entrance Hall
Lounge
Kitchen
Bedroom One
Bedroom Two
Bathroom

Exterior:
Communal gardens
Garden
Off Street Parking

These particulars do not form part of any offer or contract and must not be relied upon as statements or representations of fact. Any areas, measurements or distances are approximate. The text, photographs and plans are for guidance only and are not necessarily comprehensive. It should not be assumed that the property has all the necessary planning, building regulation or other consents and we have not tested services, equipment or facilities. Purchasers must satisfy themselves by inspection or otherwise.