



CHESTERFIELD GARDENS



£1,450,000
SHARE OF FREEHOLD

WETHERELL
MAYFAIR'S FINEST PROPERTIES

102 Mount Street · London · W1K 2TH
T: 020 7529 5566 E: sales@wetherell.co.uk
wetherell.co.uk

NO-ONE KNOWS MAYFAIR BETTER THAN WETHERELL





CHESTERFIELD GARDENS



VIRTUAL VIEWING AVAILABLE BY APPOINTMENT A spacious apartment on the fourth floor of one of Mayfair's most sought after purpose built blocks with 24-hour portering, off-street car parking and a share of freehold.

1 BEDROOM • PORTER • OFF STREET PARKING

NO-ONE KNOWS MAYFAIR BETTER THAN WETHERELL





CHESTERFIELD GARDENS

A spacious apartment on the fourth floor of one of Mayfair's most sought after purpose built blocks with 24-hour portage, off-street car parking and a share of freehold.

Chesterfield House is ideally located less than half a mile from Green Park underground station and the open spaces of Hyde Park and Green Park.

Accommodation

- * Entrance Hall
- * Kitchen
- * Reception Room
- * Double Bedroom
- * One Bathroom
- * Porter
- * 657 sq ft
- * EPC Band: D

Share of Freehold - 88 years remaining
Service Charge: £4,967 p.a approx
Ground Rent - £25 p.a
Price - £1,550,000

£1,450,000
SHARE OF FREEHOLD

Wetherell have no authority to make or give any representations or warranties in relation to the property. These particulars do not form part of any offer or contract and must not be relied upon as statements or representations of fact. Any areas, measurements or distances are approximate. The text, photographs and plans are for guidance only and are not necessarily comprehensive. It should not be assumed that the property has all the necessary planning, building regulation or other consents and Wetherell have not tested any services, equipment or facilities. Purchasers must satisfy themselves by inspection or otherwise. 2021

WETHERELL
MAYFAIR'S FINEST PROPERTIES

102 Mount Street · London · W1K 2TH
T: 020 7529 5566 E: sales@wetherell.co.uk
wetherell.co.uk

NO-ONE KNOWS MAYFAIR BETTER THAN WETHERELL





CHESTERFIELD GARDENS

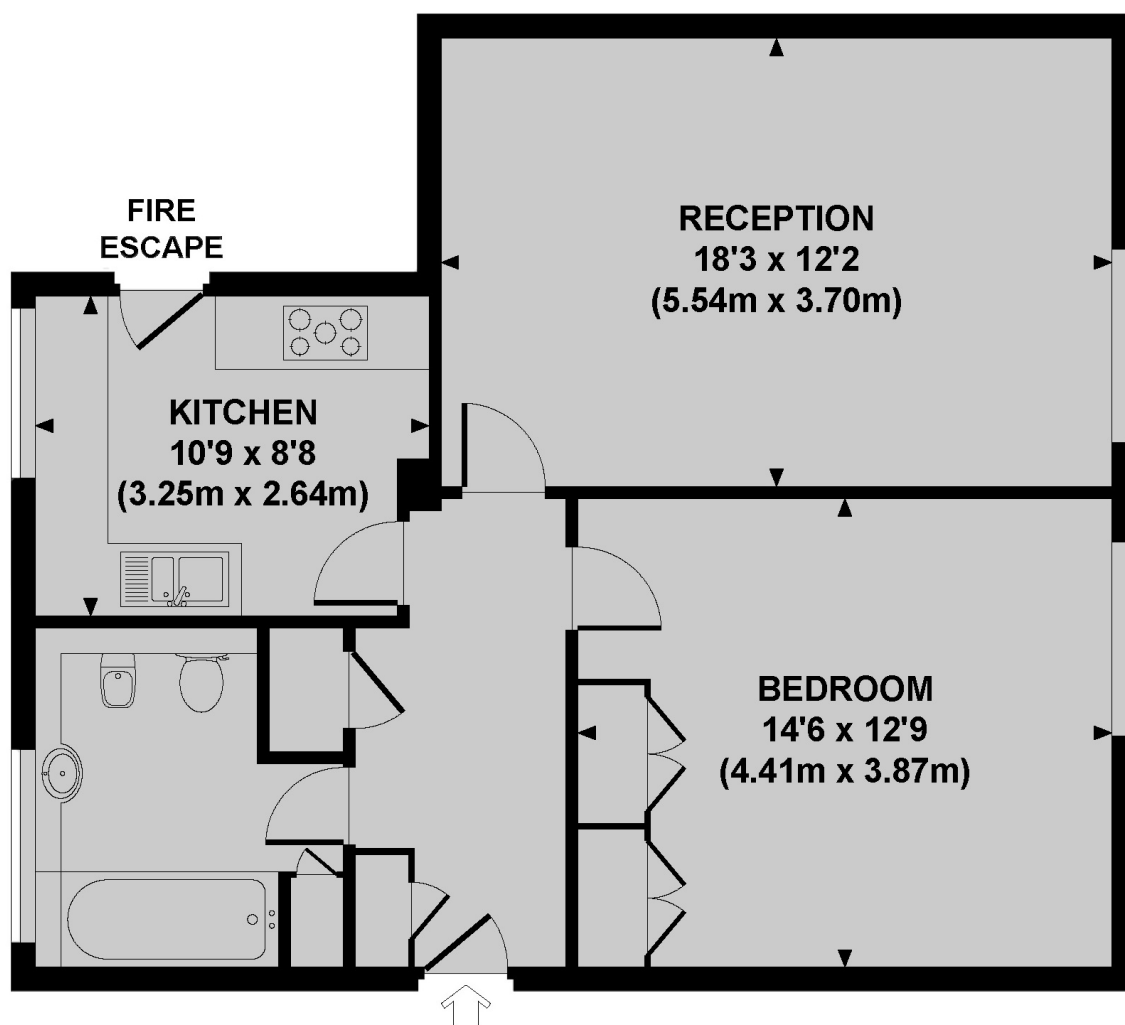

FOURTH FLOOR

CHESTERFIELD GARDENS, W1J

Approx. gross internal area
657 Sq Ft. / 61.1 Sq M.

Wetherell have no authority to make or give any representations or warranties in relation to the property. These particulars do not form part of any offer or contract and must not be relied upon as statements or representations of fact. Any areas, measurements or distances are approximate. The text, photographs and plans are for guidance only and are not necessarily comprehensive. It should not be assumed that the property has all the necessary planning, building regulation or other consents and Wetherell have not tested any services, equipment or facilities. Purchasers must satisfy themselves by inspection or otherwise. 2021

WETHERELL

MAYFAIR'S FINEST PROPERTIES

102 Mount Street · London · W1K 2TH
T: 020 7529 5566 E: sales@wetherell.co.uk
wetherell.co.uk

NO-ONE KNOWS MAYFAIR BETTER THAN WETHERELL

