

Young Street

Ayr, KA8

Offers over £55,000



2 bed upper cottage flat in a quiet cul-de-sac. comprising lounge, kitchen, 2 double bedrooms & bathroom. Rear garden, double glazing & GSC. Ideal purchase for buy-to-let investors with a high yield, for first time buyers or for property developers.



HOPPERS | 8 MAIN STREET | PRESTWICK | KA9 1NX
Tel: 01292477788
E-mail: hopperleads@aol.com



GROUND FLOOR 606 sq. ft.
(56.3 sq. m.)

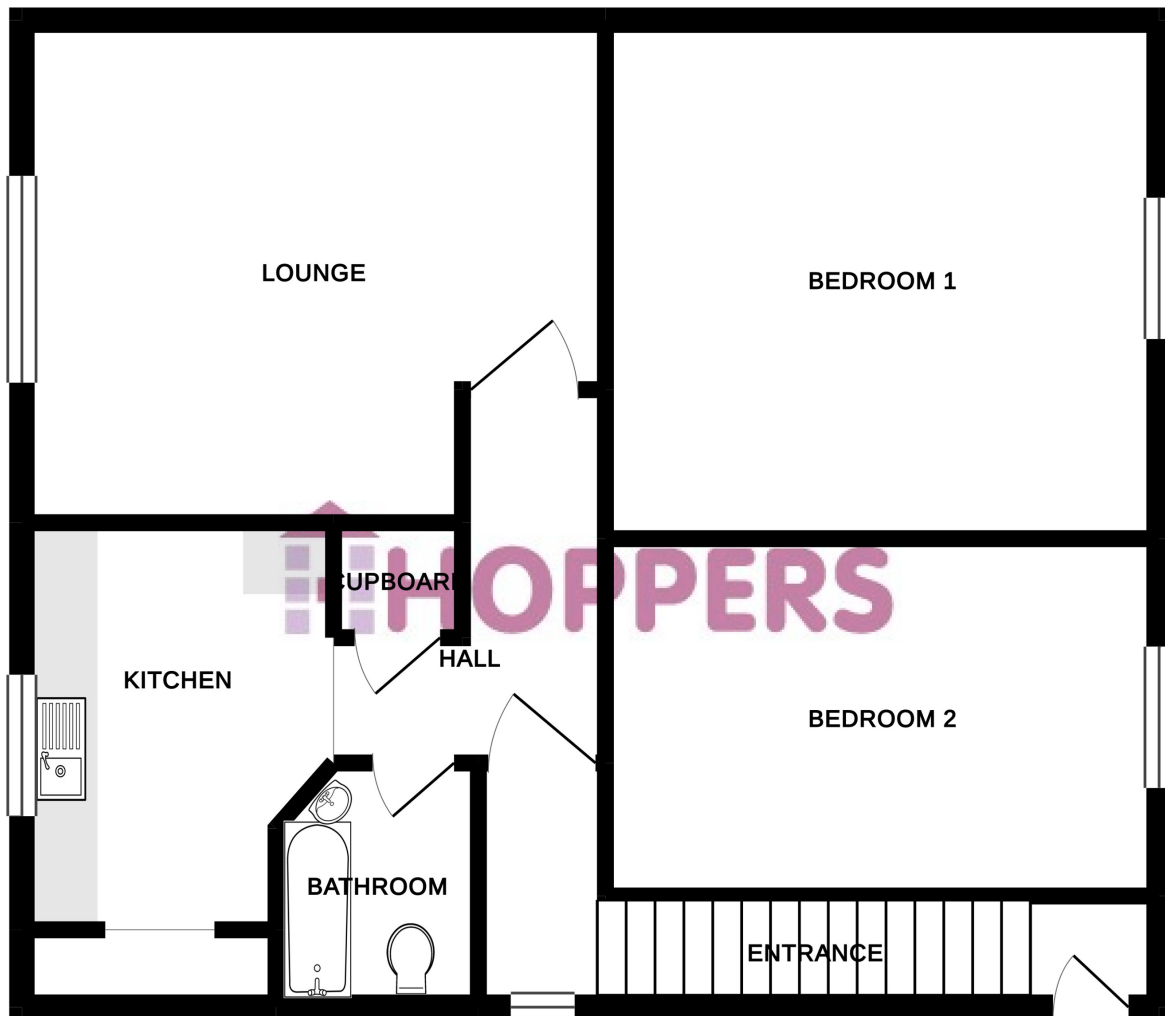

TOTAL FLOOR AREA : 606 sq. ft. (56.3 sq. m.) approx.

Whilst every attempt has been made to ensure the accuracy of the floorplan contained here, measurements of doors, windows, rooms and any other items are approximate and no responsibility is taken for any error, omission or mis-statement. This plan is for illustrative purposes only and should be used as such by any prospective purchaser. The services, systems and appliances shown have not been tested and no guarantee as to their operability or efficiency can be given.
Made with Metropix ©2019

These particulars do not form part of any offer or contract and must not be relied upon as statements or representations of fact. Any areas, measurements or distances are approximate. The text, photographs and plans are for guidance only and are not necessarily comprehensive. It should not be assumed that the property has all the necessary planning, building regulation or other consents and we have not tested services, equipment or facilities. Purchasers must satisfy themselves by inspection or otherwise.

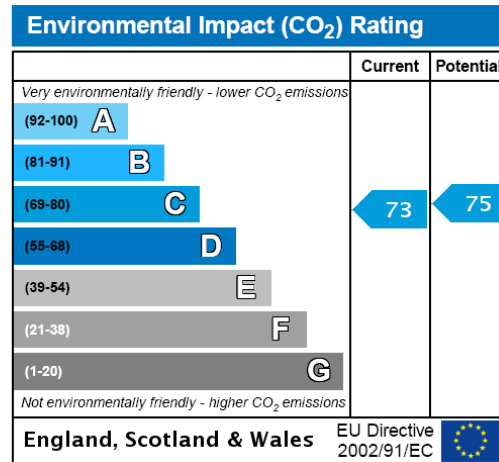
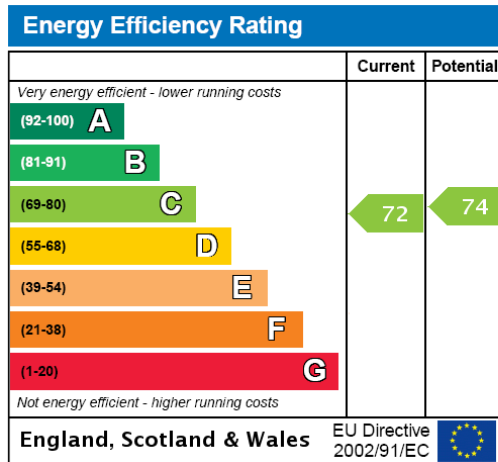

6 Young Street, Ayr, KA8 8PW

Hoppers Estate Agency is pleased to market this 2 bedroom upper flat in a quiet area of Ayr. The property comprises lounge, kitchen, 2 bedrooms and bathroom. With rear garden, GCH and double glazing.

This property is sold-as-seen without any guarantees. Viewings available only during day-light.

The property is of a good size, with neutral decor throughout. The lounge is front facing with fitted carpet and fireplace, a good sized room with potential space for a small dining table at the rear. Next to the lounge is the kitchen; front facing and well proportioned with an area at the rear for storage. The bathroom is modern with white suite comprising toilet, wash-hand basin and bath with shower above. There are 2 bedrooms in the property, both double sized and rear facing.

There is a fully enclosed rear garden with shed.

The property is located in a quiet area of Ayr, with easy access into Ayr Town Centre, Prestwick, Glasgow and beyond. With good amenities close by.

DIMENSIONS

Lounge: 11'8x14'11 approx.

Kitchen: 11'11x7'4 approx.

Bedroom 1: 12'1x12'10 approx.

Bedroom 2: 9'1x12'10 approx.

Bathroom: 5'10x4'6 approx.

VIEWINGS

Strictly through Hoppers Estate Agency. Tel 01292 477788.

These particulars do not form part of any offer or contract and must not be relied upon as statements or representations of fact. Any areas, measurements or distances are approximate. The text, photographs and plans are for guidance only and are not necessarily comprehensive. It should not be assumed that the property has all the necessary planning, building regulation or other consents and we have not tested services, equipment or facilities. Purchasers must satisfy themselves by inspection or otherwise.