



# PARK LANE



A newly decorated one Bedroom apartment with porter and lift  
on the world renowned Park Lane.

£1,250,000

**WETHERELL**  
MAYFAIR'S FINEST PROPERTIES

102 Mount Street · London · W1K 2TH  
T: 020 7529 5566 E: [sales@wetherell.co.uk](mailto:sales@wetherell.co.uk)  
[wetherell.co.uk](http://wetherell.co.uk)

NO-ONE KNOWS MAYFAIR BETTER THAN WETHERELL







## PARK LANE



LIFT • NEWLY DECORATED • 24 PORTER

NO-ONE KNOWS MAYFAIR BETTER THAN WETHERELL





## PARK LANE

A newly decorated one Bedroom apartment with porter and lift on the world renowned Park Lane.

This perfect Pied-à-Terre of 523 square feet is situated on the third floor of this prestigious building. The spacious apartment comprises a bright Reception Room, fully fitted Kitchen, double Bedroom and a separate Bathroom.

55 Park Lane is one of the most prestigious addresses in Mayfair and is ideally located for Hyde Park, Mayfair's variety of Michelin-starred restaurants, and boutique shopping district of Mount Street. Originally a country lane, Park Lane first became a desirable residential address in the eighteenth century and soon became home to some of the largest privately owned mansions in Great Britain.

### Accommodation:

- \* Reception Room
- \* Master Bedroom
- \* Kitchen
- \* Bathroom
- \* Porter
- \* Lift
- \* 523 square feet
- \* EPC Band C

### Terms:

- \* Lease Length - Approximately 115 years
- \* Service Charge - £7,000 Per Annum
- \* Ground Rent - £350 Per Annum
- \* Price - £1,250,000

£1,250,000

Wetherell have no authority to make or give any representations or warranties in relation to the property. These particulars do not form part of any offer or contract and must not be relied upon as statements or representations of fact. Any areas, measurements or distances are approximate. The text, photographs and plans are for guidance only and are not necessarily comprehensive. It should not be assumed that the property has all the necessary planning, building regulation or other consents and Wetherell have not tested any services, equipment or facilities. Purchasers must satisfy themselves by inspection or otherwise. 2019

**WETHERELL**  
MAYFAIR'S FINEST PROPERTIES

102 Mount Street · London · W1K 2TH  
T: 020 7529 5566 E: sales@wetherell.co.uk  
wetherell.co.uk

NO-ONE KNOWS MAYFAIR BETTER THAN WETHERELL





PARK LANE

## Park Lane, W1K

Approximate Gross Internal Area = 48.6 sq m / 523 sq ft

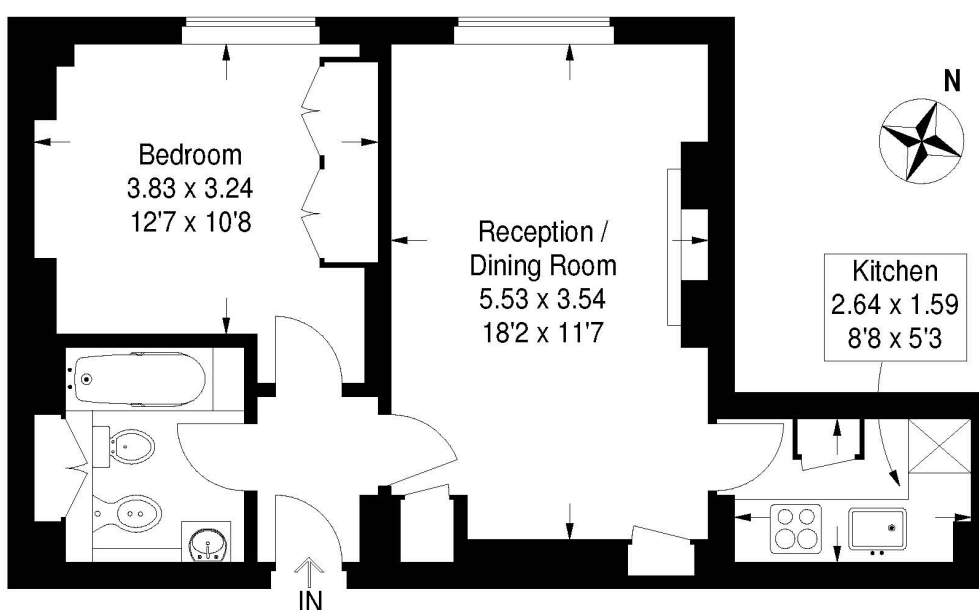

### Third Floor

Illustration for identification purposes only,  
measurements are approximate, not to scale.  
FloorplansUsketch.com © 2015 (ID 173299 )

Wetherell have no authority to make or give any representations or warranties in relation to the property. These particulars do not form part of any offer or contract and must not be relied upon as statements or representations of fact. Any areas, measurements or distances are approximate. The text, photographs and plans are for guidance only and are not necessarily comprehensive. It should not be assumed that the property has all the necessary planning, building regulation or other consents and Wetherell have not tested any services, equipment or facilities. Purchasers must satisfy themselves by inspection or otherwise. 2019

**WETHERELL**  
MAYFAIR'S FINEST PROPERTIES

102 Mount Street · London · W1K 2TH  
T: 020 7529 5566 E: sales@wetherell.co.uk  
wetherell.co.uk

NO-ONE KNOWS MAYFAIR BETTER THAN WETHERELL

