

**Westcombe Lodge Drive, UB4
£199,950, Leasehold**



NO UPPER CHAIN!

Over 55's only & 24 hour warden controlled retirement development for this 1 bedroom first floor flat (lift service)
Set back off the main Uxbridge Road opposite bus stops for both Uxbridge & Hayes Town.

Walking distance to Iceland's, the post office and other local amenities.

Pretty communal gardens, residence social lounge & regular activities & organised day trips.
Residence private car park.

Approx. 70 year lease

Approx. £249.00PCM Service charge.





First Floor

Approx. 40.2 sq. metres (432.5 sq. feet)

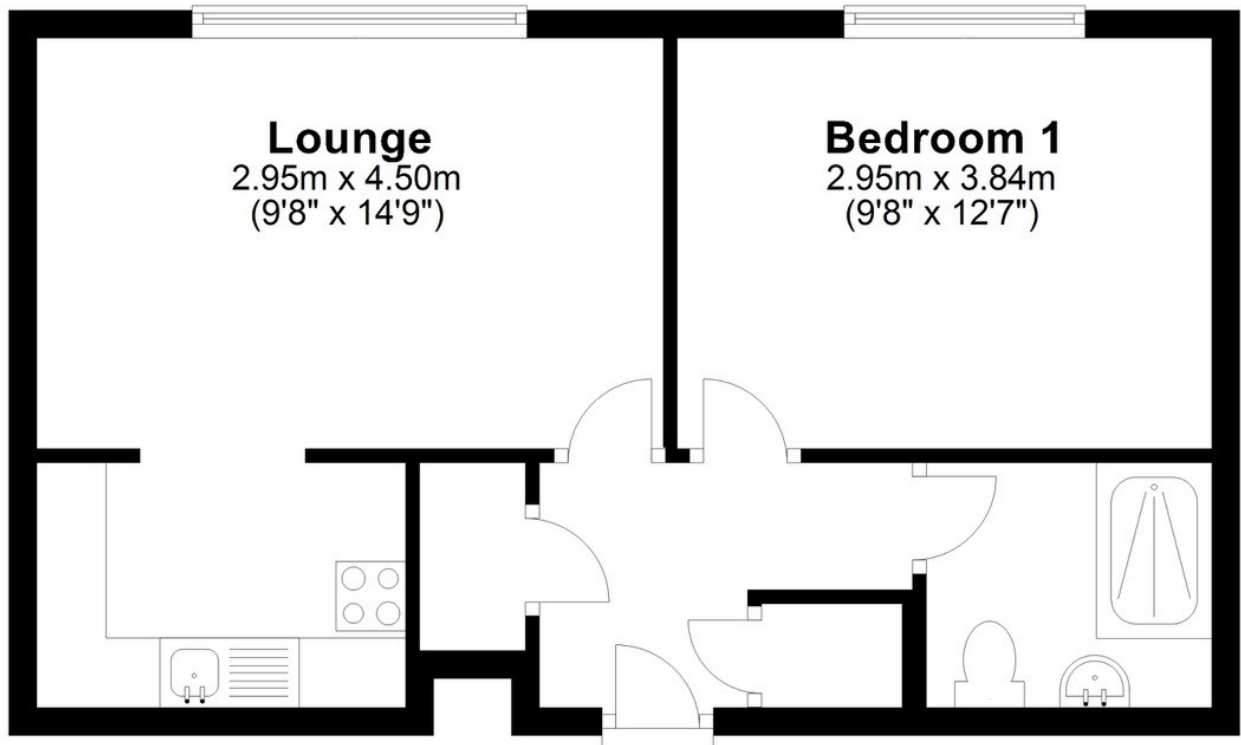

Total area: approx. 40.2 sq. metres (432.5 sq. feet)

All measurements are approximate and not to scale.
Plan produced using PlanUp.

broads property services give notice to anyone reading these particulars that: (i) these particulars do not constitute part of an offer or contract; (ii) these particulars and any pictures or plans represent the opinion of the author and are given in good faith for guidance only and must not be construed as statements of fact; (iii) nothing in the particulars shall be deemed a statement that the property is in good condition otherwise; we have not carried out a structural survey of the property and have not tested the services, appliances or specified fittings.

Long Description

NO UPPER CHAIN!

Over 55's only & 24 hour warden controlled retirement development for this 1 bedroom first floor flat (lift service)

Set back off the main Uxbridge Road opposite bus stops for both Uxbridge & Hayes Town.

Walking distance to Icelands, the post office and other local amenities.

Pretty communal gardens, residence social lounge & regular activities & organised day trips.

Residence private car park.

Approx. 70 year lease

Approx. £249.00PCM Service charge.