

Westlake Close, UB4

Offers in excess of £295,000, Freehold



Beautifully presented 1 bedroom 'Bovis' built freehold house, set within a much sought after development walking distance to Tesco superstore & Yeading marina. Main bus route links give you access to Ealing, Northolt, Hayes station & Heathrow. This property has been carefully maintained by the present owners and benefits from gas central heating (new combination boiler 2016) Leaded light style double glazed windows, modern fitted kitchen & bathroom, lounge with solid wood flooring with underfloor heating, pretty rear garden, 3 allocated parking spaces.





Ground Floor

Approx. 28.7 sq. metres (309.2 sq. feet)

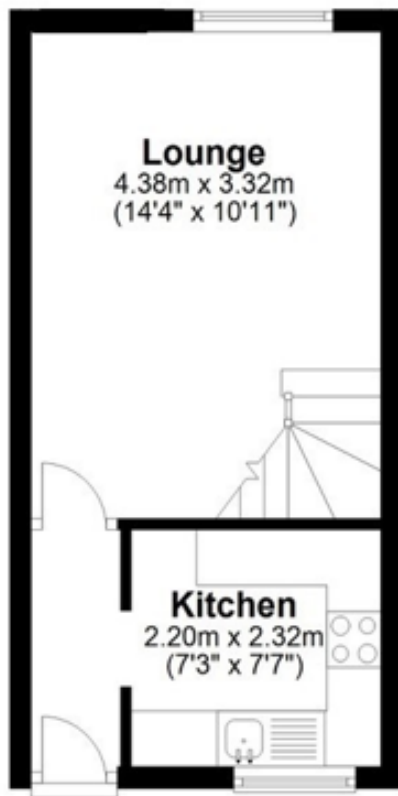

First Floor

Approx. 22.9 sq. metres (247.0 sq. feet)

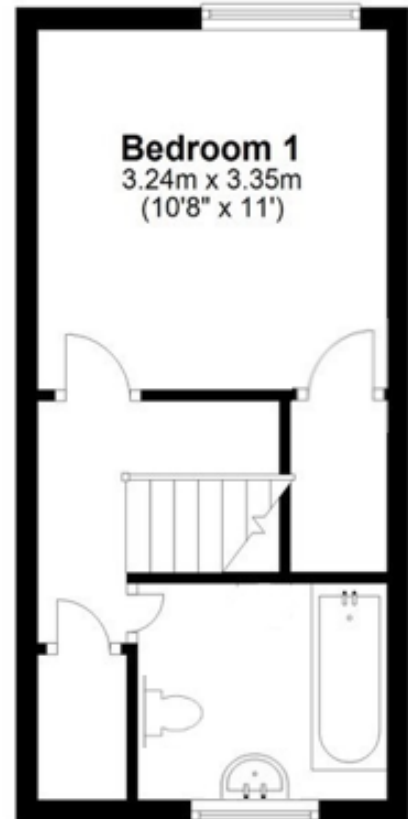

Total area: approx. 51.7 sq. metres (556.1 sq. feet)

All measurements are approximate and not to scale.
Plan produced using PlanUp.

broads property services give notice to anyone reading these particulars that: (i) these particulars do not constitute part of an offer or contract; (ii) these particulars and any pictures or plans represent the opinion of the author and are given in good faith for guidance only and must not be construed as statements of fact; (iii) nothing in the particulars shall be deemed a statement that the property is in good condition otherwise; we have not carried out a structural survey of the property and have not tested the services, appliances or specified fittings.

Long Description

Beautifully presented 1 bedroom 'Bovis' built freehold house, set within a much sought after development walking distance to Tesco superstore & Yeading marina. Main bus route links give you access to Ealing, Northolt, Hayes station & Heathrow.

This property has been carefully maintained by the present owners and benefits from gas central heating (new combination boiler 2016)

Leaded light style double glazed windows, modern fitted kitchen & bathroom, lounge with solid wood flooring with underfloor heating, pretty rear garden, 3 allocated parking spaces.