

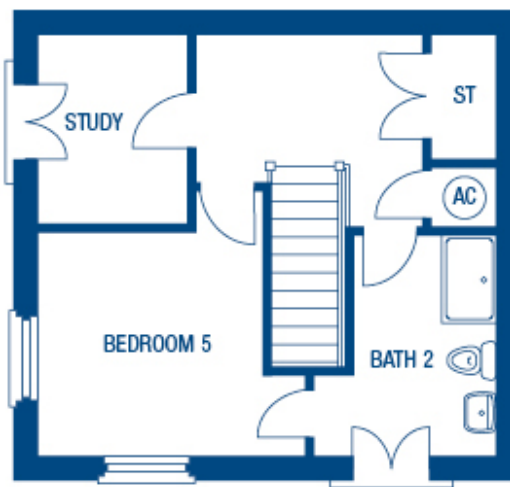

- * COMING SOON!
- * 5 BEDROOM DETACHED HOUSE
- * 3 STOREYS
- * 2 BATHROOMS + 1 EN-SUITE
- * ADJACENT TO WEST LANCS GOLF COURSE
- * CLOSE TO HALL RD RAILWAY STATION





These particulars do not form part of any offer or contract and must not be relied upon as statements or representations of fact. Any areas, measurements or distances are approximate. The text, photographs and plans are for guidance only and are not necessarily comprehensive. It should not be assumed that the property has all the necessary planning, building regulation or other consents and we have not tested services, equipment or facilities. Purchasers must satisfy themselves by inspection or otherwise.



5 Bedroom Detached House With Double Garage
Book and Confirm Your Show House Viewing Online Now!

The kitchen has a family room with bi-folding doors leading to the garden.

Flexible accommodation for the family with the second floor having bedroom 5, bathroom 2 & a study.

High specification tiling, fittings & appliances in the kitchen & bathrooms.

Property Comprises Of:

Ground Floor:

Entrance Hall

Lounge - 12'4" x 18'6"

Dining Room - 9'8" x 11'8"

WC - 4'5"* x 5'6"*

Kitchen/Breakfast Area - 16'1"* x 18'8"*

Family Room - 11'8" x 10'2"

Utility Room - 10'9"* x 6'5"*

First Floor:

Landing

Bedroom One - 16'1"* x 14'4"* (En-Suite - 3'10" x 7'10")

Bedroom Two - 9'11" x 11'9"

Bedroom Three - 12'6" x 9'1"

Bedroom Four - 12'6"* x 9'1"*

Bathroom - 9'11"* x 6'5"*

Second Floor:

Bedroom Five - 11'9"* x 11'8"

Study - 6'7" x 8'4"

Bathroom - 8'0"* x 9'8"*

These particulars do not form part of any offer or contract and must not be relied upon as statements or representations of fact. Any areas, measurements or distances are approximate. The text, photographs and plans are for guidance only and are not necessarily comprehensive. It should not be assumed that the property has all the necessary planning, building regulation or other consents and we have not tested services, equipment or facilities. Purchasers must satisfy themselves by inspection or otherwise.