



- Click video for key facts
- Selling the FACTS not the FLOWER
- Three bedroom mid terrace house
  - Rear garden
  - Driveway
  - Ground floor W/C





## Ground Floor

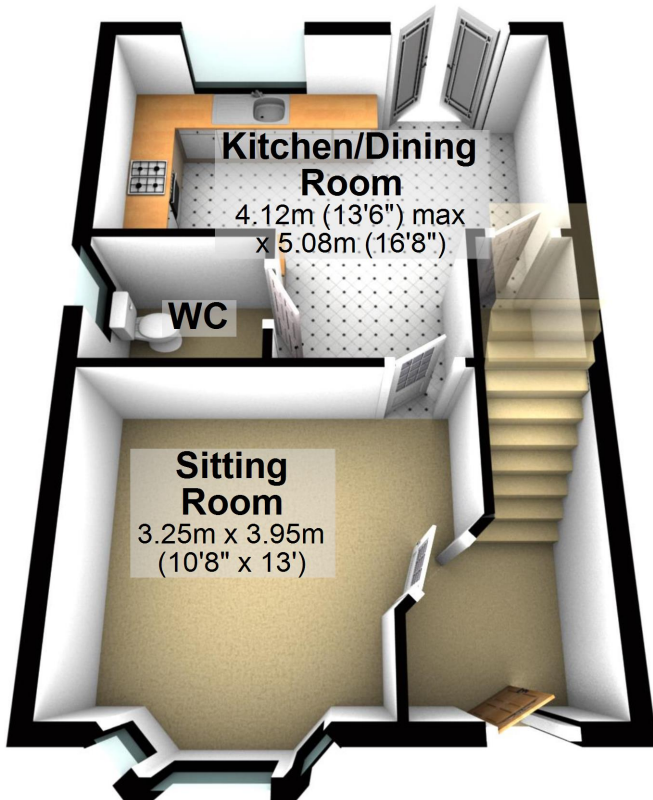

## First Floor

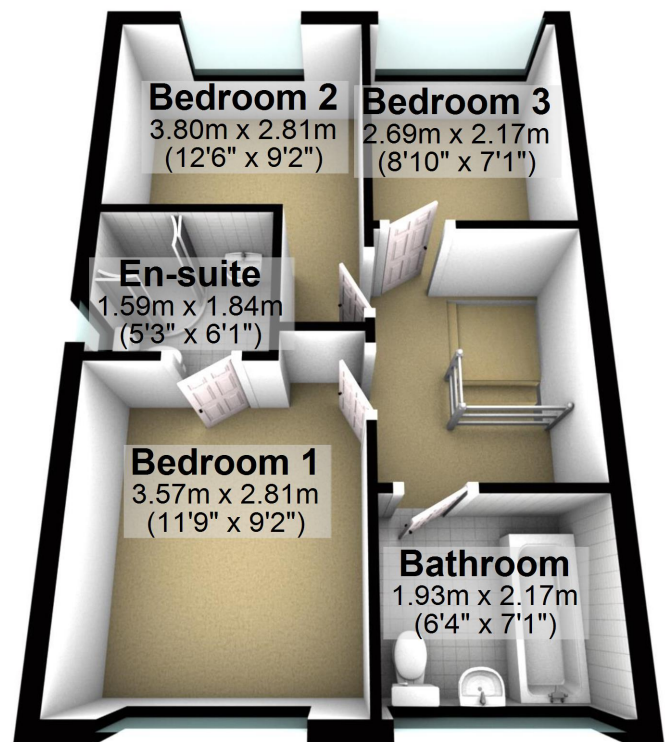

These particulars do not form part of any offer or contract and must not be relied upon as statements or representations of fact. Any areas, measurements or distances are approximate. The text, photographs and plans are for guidance only and are not necessarily comprehensive. It should not be assumed that the property has all the necessary planning, building regulation or other consents and we have not tested services, equipment or facilities. Purchasers must satisfy themselves by inspection or otherwise.



Energy Efficiency Rating		
	Current	Potential
Very energy efficient - lower running costs		
(92-100) <b>A</b>		95
(81-91) <b>B</b>	83	
(69-80) <b>C</b>		
(55-68) <b>D</b>		
(39-54) <b>E</b>		
(21-38) <b>F</b>		
(1-20) <b>G</b>		
Not energy efficient - higher running costs		
England, Scotland & Wales	EU Directive 2002/91/EC	

## SELLING THE FACTS NOT THE FLOWER!

For all room sizes/measurements, please see the floorplans.

Tenure - Leasehold

Lease Start Date- 01 Aug 2014

Lease End Date- 01 Aug 3013

Lease Term- 999 years from and including 1 August 2014

Lease Term Remaining - 992 years

Local Authority - Sefton Council

Council Tax - Band B

Annual Price: £1,588.60

Conservation Area - No

Flood Risk - Very Low

Floor Area - 839.59 ft<sup>2</sup> / 78 m<sup>2</sup>

Plot size - 0.04 acres

Mobile coverage

Vodafone - Great

Three - Good

O2 - Great

Broadband

Basic 6 Mbps

Superfast 58 Mbps

Ultrafast 1000 Mbps

Satellite / Fibre TV Availability

BT - Great

Sky - Great

97 | SOUTH ROAD | WATERLOO | L22 0LR

Tel: 0151 920 2404

E-mail: [info@logicstates.co.uk](mailto:info@logicstates.co.uk)





Virgin - Great

(Data sourced from Sprift)

'UNUSUALLY GOOD AT WHAT WE DO'

Buy, Sell or Let with the agent of the decade - Zoopla customer excellence award 2020

These particulars do not form part of any offer or contract and must not be relied upon as statements or representations of fact. Any areas, measurements or distances are approximate. The text, photographs and plans are for guidance only and are not necessarily comprehensive. It should not be assumed that the property has all the necessary planning, building regulation or other consents and we have not tested services, equipment or facilities. Purchasers must satisfy themselves by inspection or otherwise.