

# Seaforth Crescent

Ayr, KA8

Offers over £60,000



\*\*\* CLOSING DATE FOR OFFERS TUESDAY 3RD SEPTEMBER @ 3PM \*\*\*

1 bedroom upper flat in a popular residential area. Comprising lounge, kitchen, double bedroom & shower room. Off street parking & large rear garden. Move-in condition, viewings recommended.



HOPPERS | 8 MAIN STREET | PRESTWICK | KA9 1NX  
Tel: 01292477788  
E-mail: [hopperleads@aol.com](mailto:hopperleads@aol.com)



GROUND FLOOR 511.12 sq. ft.  
( 47.48 sq. m. )

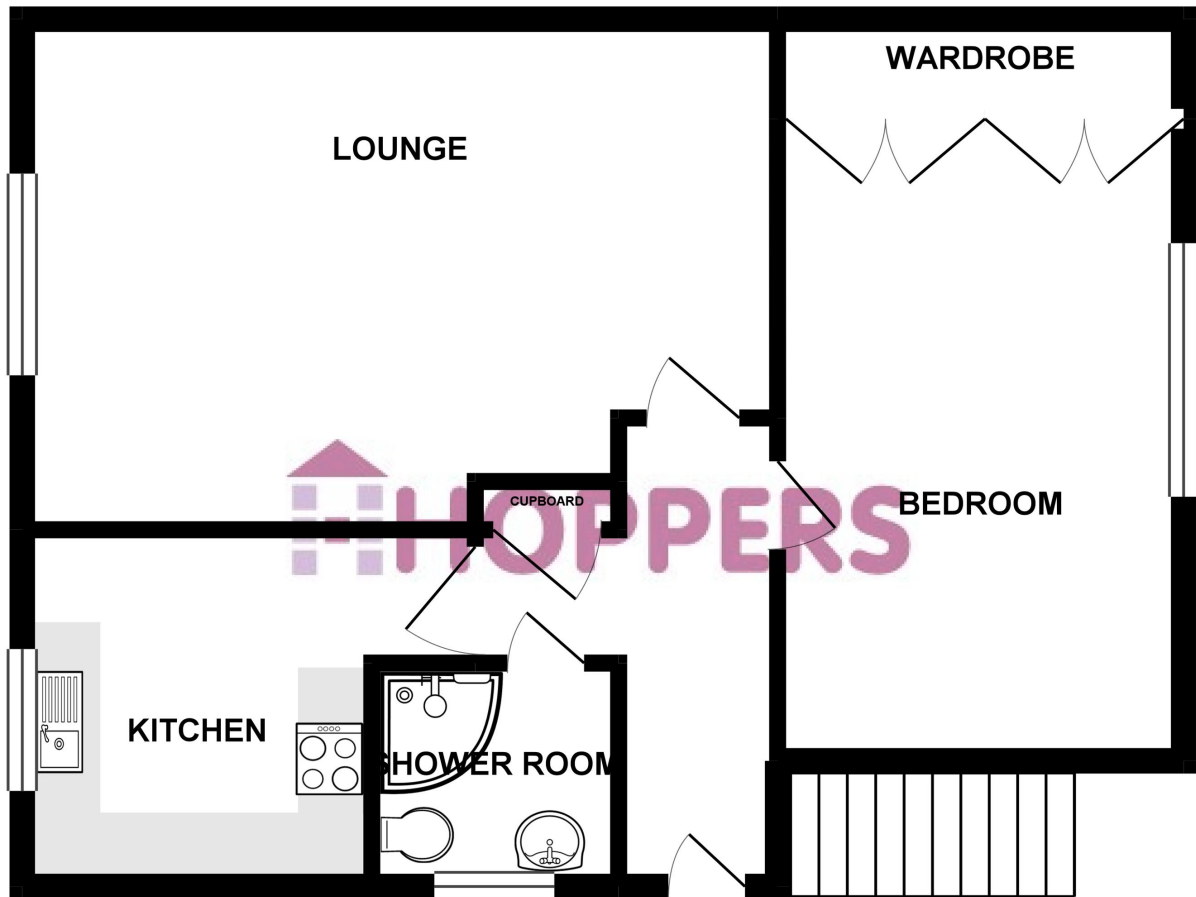

TOTAL FLOOR AREA : 511.12 sq. ft. ( 47.48 sq. m.) approx.

Whilst every attempt has been made to ensure the accuracy of the floorplan contained here, measurements of doors, windows, rooms and any other items are approximate and no responsibility is taken for any error, omission or mis-statement. This plan is for illustrative purposes only and should be used as such by any prospective purchaser. The services, systems and appliances shown have not been tested and no guarantee as to their operability or efficiency can be given.  
Made with Metropix ©2019

These particulars do not form part of any offer or contract and must not be relied upon as statements or representations of fact. Any areas, measurements or distances are approximate. The text, photographs and plans are for guidance only and are not necessarily comprehensive. It should not be assumed that the property has all the necessary planning, building regulation or other consents and we have not tested services, equipment or facilities. Purchasers must satisfy themselves by inspection or otherwise.



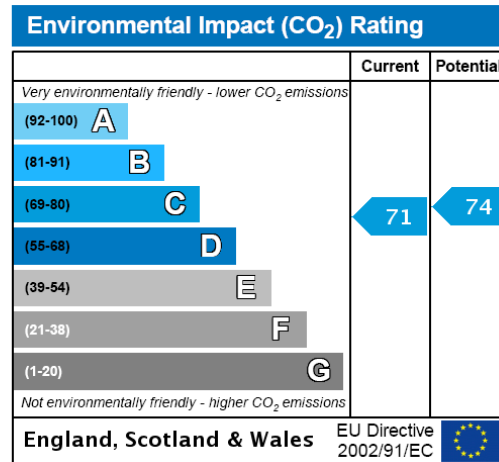
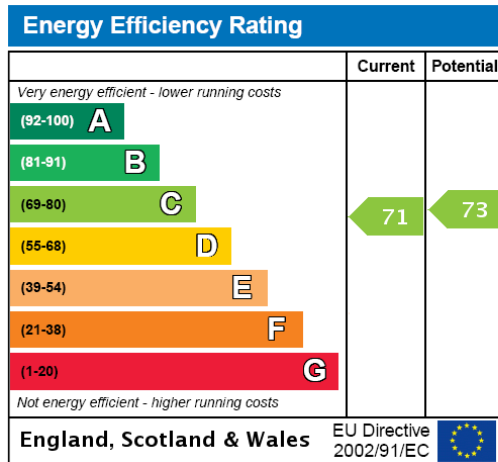

23 Seaforth Crescent, Ayr, KA8 9BY

\*\*\* CLOSING DATE FOR OFFERS TUESDAY 3RD SEPTEMBER @ 3PM \*\*\*

Hoppers Estate Agency are pleased to market this beautifully presented 1 bedroom upper flat in a popular residential area in Ayr. The property comprises spacious lounge, kitchen, double bedroom and shower room. With large rear garden and off street parking. Freshly decorated in and in walk-in condition, viewings highly recommended.

Internally, the property is beautifully presented, with new carpets and fresh paintwork. The lounge is spacious and bright with modern, tasteful decor, and is large enough to accommodate dining furniture also. Next to the lounge lies the kitchen, a bright room with white wall and base units providing a good amount of storage and worktop space. The decor is modern with a contemporary metro tile splashback and attractive wooden worktops. The bedroom is a spacious double with large fitted, mirrored wardrobes providing excellent storage, with tasteful decor and fitted carpet. There is an attractive shower room, with modern white suite and corner shower cubicle.

Externally, the property is well kept with a very large rear garden which is fully laid to lawn, and a driveway to the side of the building.

Seaforth Crescent is located in a popular residential area close to Prestwick Road. There are good amenities nearby with supermarkets and good bus links into Prestwick, Ayr Town Centre and beyond.

#### DIMENSIONS

Lounge: 11'10x17'5 approx.

Kitchen: 8'3x10'6 approx.

Bedroom: 14'11x9'4 approx.

Shower Room: 4'7x5'7 approx.

#### INCLUDED IN SALE

All floor coverings, window blinds and light fittings.

#### VIEWINGS

Strictly by appointment through Hoppers Estate Agency. Tel 01292 477788



These particulars do not form part of any offer or contract and must not be relied upon as statements or representations of fact. Any areas, measurements or distances are approximate. The text, photographs and plans are for guidance only and are not necessarily comprehensive. It should not be assumed that the property has all the necessary planning, building regulation or other consents and we have not tested services, equipment or facilities. Purchasers must satisfy themselves by inspection or otherwise.