



Thornton Avenue W4

FINLAY
BREWER

Thornton Avenue W4

**2 Double Bedrooms
Open Plan Kitchen/Breakfast/Reception
Bathroom * Cellar
Walled & Paved Garden * Side & Rear Access
Potential To Extend To The Side Rear STPP
EPC Rating E 39**

A well presented and spacious 2 bedroom garden flat located moments from the amenities of Turnham Green Terrace and the overground station.

With 2 generous double bedrooms, bathroom and a fabulous open plan kitchen/breakfast/reception room which opens onto a walled paved garden and a useful cellar - this property is a MUST SEE!

There could also be potential to extend to the side rear subject to planning permission.

**GUIDE: £725,000
LEASEHOLD**

**LEASE LENGTH: 999 YRS APPROX
SUBJECT TO CONTRACT**





Approximate Gross Internal Area 1,087 Sq Ft/101 Sq M

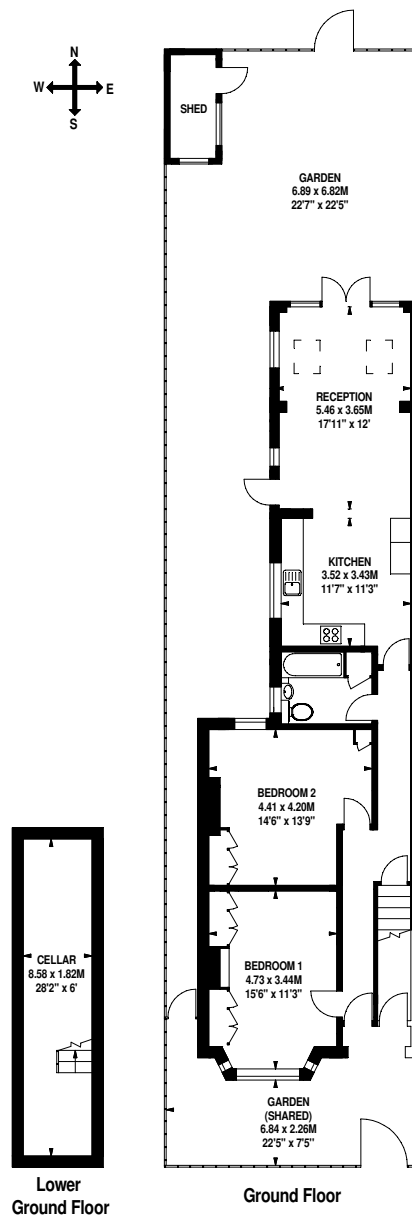

FOR ILLUSTRATIVE PURPOSES ONLY - NOT TO SCALE
The position & size of doors, windows, appliances and other features are approximate only.