

2 BEDROOM FLAT
ADELAIDE ROAD, SURBITON

£325,000



This 2nd floor purpose built flat requiring updating is located in the heart of Surbiton on a highly sought after road within a few minutes walking distance of Surbiton station with its fast trains into Waterloo, shops, bars and restaurants. The accommodation comprises, entrance lobby, lounge/diner, kitchen, two double bedrooms and bathroom. Further benefits include an allocated parking space, a share of the freehold and no onward chain.



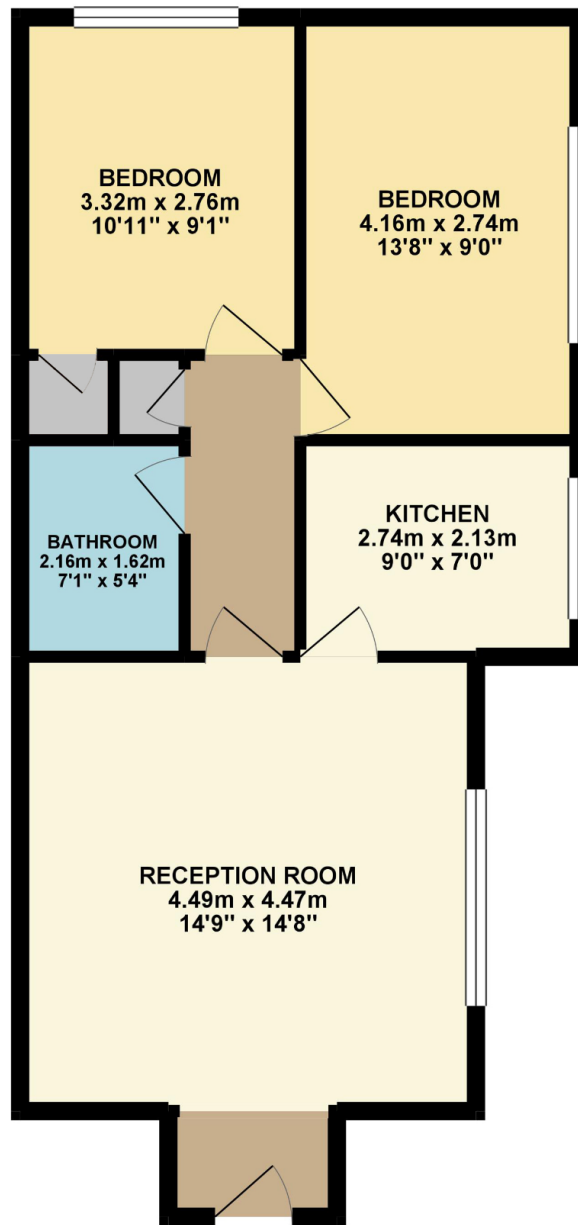

DULVERTON COURT, ADELAIDE ROAD
INTERNAL FLOOR AREA (APPROX.) 607 sq ft/ 56.4 sq m

Whilst every attempt has been made to ensure the accuracy of this floor plan, measurement of doors, windows, rooms and any other items are approximate and no responsibility is taken for any error, omission or mis-statement. Made with Metropix © 2019.

We have prepared these sales particulars as a general guide after a brief inspection of the property and with information supplied by the Vendors. No detailed survey was carried out nor were the services and appliances tested. Photographs are not comprehensive and no assumption should be made that the property remains as displayed. The floor plans are for representation purposes only as defined by the RICS Code of Measuring Practice. Measurements, room shapes and sizes are approximate and must not be relied on. No responsibility is taken for errors or omissions. All fixtures and fittings, carpets, curtains/blinds, lighting and kitchen equipment, whether fitted or not, are deemed to be removable by the Vendors unless specifically itemised. No representation is given as to the title of the property.



HIGHER VALUES

HJC Surbiton 020 8390 0404 | HJC Lettings 020 8390 9290 | HJC Thames Ditton 020 8398 3707
 surbiton@hjc.co.uk | lettings@hjc.co.uk | thamesditton@hjc.co.uk

Reg no: 05272208 | VAT no: 720 5720 65