

3 BEDROOM HOUSE
HARVEST LANE, THAMES DITTON

£700,000

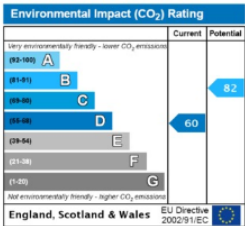

SOLD BEFORE LAUNCHING! ANOTHER SUCCESSFUL HJC SALE IN THAMES DITTON VILLAGE

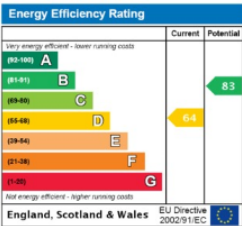

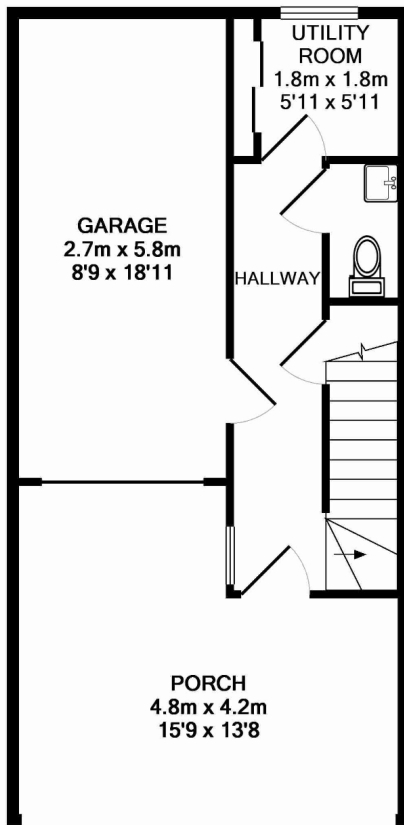

GROUND FLOOR
APPROX. FLOOR
AREA 47.8 SQ.M.
(514 SQ.FT.)

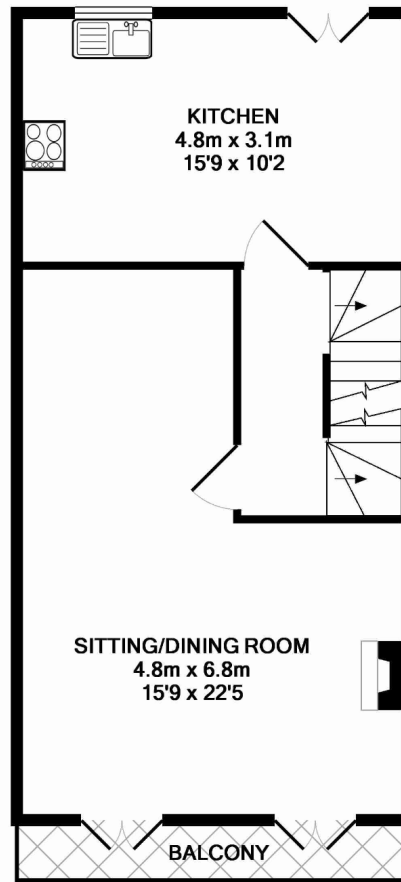

1ST FLOOR
APPROX. FLOOR
AREA 47.8 SQ.M.
(514 SQ.FT.)

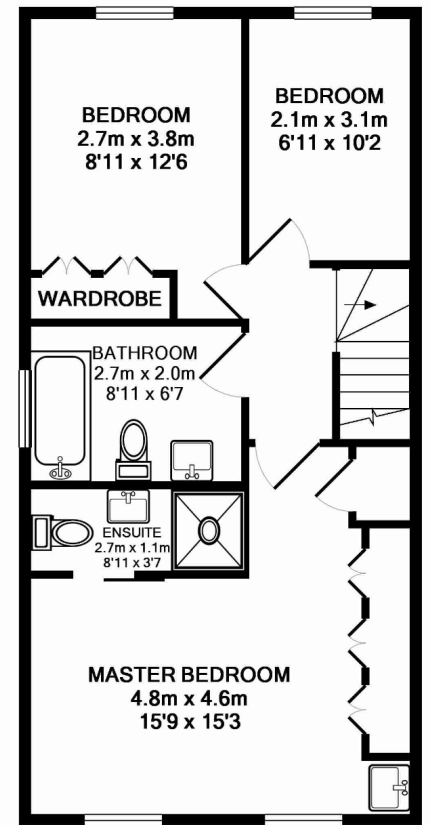

2ND FLOOR
APPROX. FLOOR
AREA 47.8 SQ.M.
(514 SQ.FT.)

TOTAL APPROX. FLOOR AREA 143.3 SQ.M. (1542 SQ.FT.)

KeyHIPS Floor Plans are produced and provided for illustration purposes only. Whilst every attempt has been made to ensure the plan is accurate and presents the property in the best way, measurements of doors, windows and rooms are approximate and no responsibility is taken for any error, omission or mis-statement. To find out more about KeyHIPS please visit www.keyhips.com (Tel: 0845 475 4165) Made with Metropix ©2009

We have prepared these sales particulars as a general guide after a brief inspection of the property and with information supplied by the Vendors. No detailed survey was carried out nor were the services and appliances tested. Photographs are not comprehensive and no assumption should be made that the property remains as displayed. The floor plans are for representation purposes only as defined by the RICS Code of Measuring Practice. Measurements, room shapes and sizes are approximate and must not be relied on. No responsibility is taken for errors or omissions. All fixtures and fittings, carpets, curtains/blinds, lighting and kitchen equipment, whether fitted or not, are deemed to be removable by the Vendors unless specifically itemised. No representation is given as to the title of the property.

HJC

HIGHER VALUES

HJC Surbiton 020 8390 0404 | HJC Lettings 020 8390 9290 | HJC Thames Ditton 020 8398 3707
surbiton@hjc.co.uk | lettings@hjc.co.uk | thamesditton@hjc.co.uk

Reg no: 05272208 | VAT no: 720 5720 65