

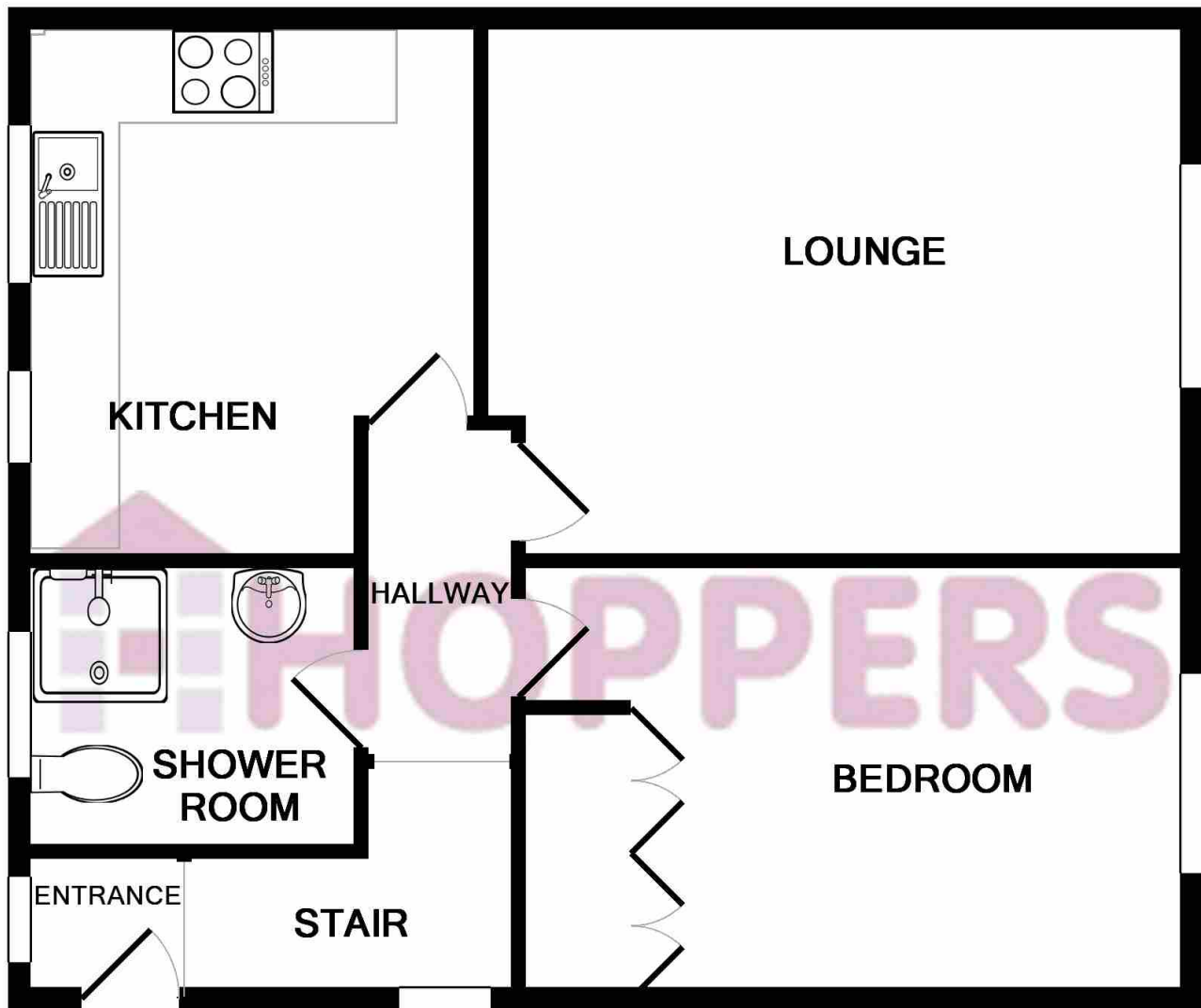

A spacious 1 bedroom upper flat in a popular area close to local amenities. Comprising spacious lounge, double bedroom, kitchen and shower room. With rear garden and off street parking.





Whilst every attempt has been made to ensure the accuracy of the floor plan contained here, measurements of doors, windows, rooms and any other items are approximate and no responsibility is taken for any error, omission, or mis-statement. This plan is for illustrative purposes only and should be used as such by any prospective purchaser. The services, systems and appliances shown have not been tested and no guarantee as to their operability or efficiency can be given
Made with Metropix ©2018

These particulars do not form part of any offer or contract and must not be relied upon as statements or representations of fact. Any areas, measurements or distances are approximate. The text, photographs and plans are for guidance only and are not necessarily comprehensive. It should not be assumed that the property has all the necessary planning, building regulation or other consents and we have not tested services, equipment or facilities. Purchasers must satisfy themselves by inspection or otherwise.



52 Waterloo Road, Prestwick, KA9 2AA

Hoppers Estate agency are pleased to market this 1 bedroom upper flat on Waterloo Road in Prestwick. A spacious property comprising lounge, bedroom, kitchen and shower room, as well as rear garden and off street parking. Close to supermarkets, pharmacy and other amenities, and with easy access to Ayr Town Centre, Prestwick Main Street, Glasgow and beyond.

A hall at the top of the stairs leads to the lounge at the far left, a spacious front facing room with fitted carpet and neutral decor. The kitchen is of a good size, with L-shaped units offering good storage & worktop space and 2 rear facing windows. The bedroom is a spacious front facing double, again with neutral decor and fitted carpet, as well as built in wardrobes providing a good amount of storage space. The shower room comprises white suite with toilet, wash-hand basin and separate shower cubicle.

EXTERIOR

The property boasts off street parking and a rear garden. The garden is of a good size, partially laid to lawn with planting beds and summer house.

DIMENSIONS

Lounge: 15'5x12'0 approx.

Kitchen: 10'1x11'2 approx.

Bedroom: 15'5x10'5 approx.

Shower Room: 6'9x4'5 approx.

INCLUDED IN SALE

All floor coverings, window blinds and light fittings.

VIEWINGS

Strictly through Hoppers Estate Agency. Tel 01292 477788

These particulars do not form part of any offer or contract and must not be relied upon as statements or representations of fact. Any areas, measurements or distances are approximate. The text, photographs and plans are for guidance only and are not necessarily comprehensive. It should not be assumed that the property has all the necessary planning, building regulation or other consents and we have not tested services, equipment or facilities. Purchasers must satisfy themselves by inspection or otherwise.