

BEECHCROFT AVENUE, GOLDERS GREEN, NW11
£2,000 per month, For long let

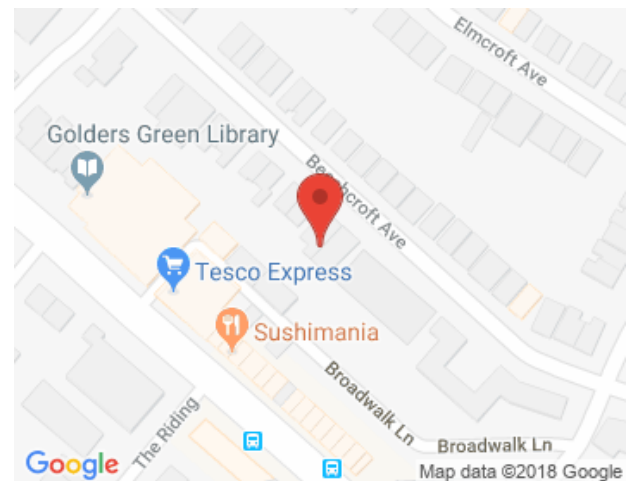

A stunning two bedroom flat located on the first floor of this modern purpose built block.

The property benefits from two bathrooms (one en-suite), secure off street parking, wood flooring, modern kitchen and is available now.





10 Beechcroft (3)

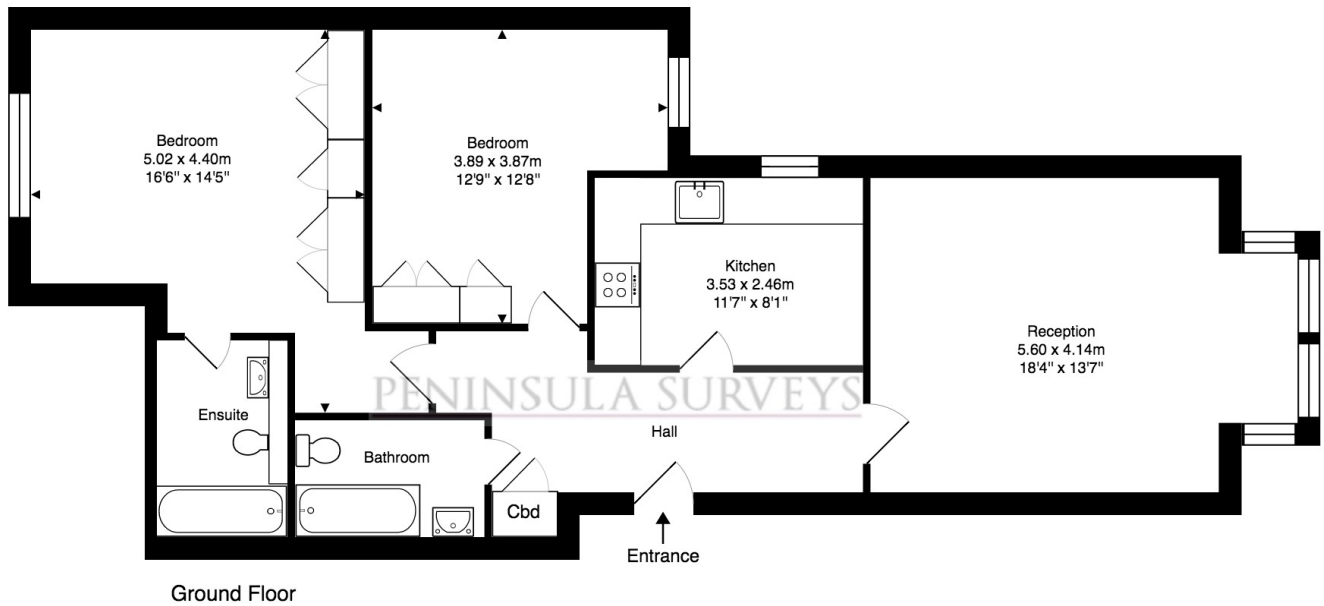

Approx. Gross Internal Area: 81.9 m² ... 882 ft²

All measurements and areas are approximate only.
Dimensions are not to scale. This plan is for guidance
only and must not be relied upon as a statement of fact.
(c) Peninsula Surveys Ltd

PENINSULA SURVEYS

Dreamview Estates give notice to anyone reading these particulars that: (i) these particulars do not constitute part of an offer or contract; (ii) these particulars and any pictures or plans represent the opinion of the author and are given in good faith for guidance only and must not be construed as statements of fact; (iii) nothing in the particulars shall be deemed a statement that the property is in good condition otherwise; we have not carried out a structural survey of the property and have not tested the services, appliances or specified fittings.

Long Description

A stunning two bedroom flat located on the first floor of this modern purpose built block.

The property benefits from two bathrooms (one en-suite), secure off street parking, wood flooring, modern kitchen with integrated appliances, extensive range of fitted wardrobes to the master bedroom, double glazing and is a short walk from Golders Green tube station and shops.

Available 20/01/2020.