



Major Son & Phipps

Albany Passage, TW10
Offers in excess of £390,000



Rarely available character one bedroom cottage in the ever popular 'Alberts' area of Richmond
This charming end of terrace cottage is conveniently located a very short walk from the Town centre and station.
No forward chain.

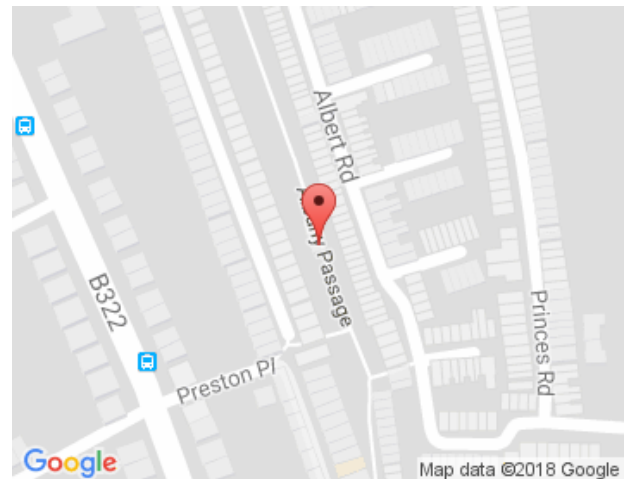



Energy Efficiency Rating		
	Current	Potential
Very energy efficient - lower running costs		
(92-100) A		
(81-91) B		
(69-80) C		
(55-68) D		
(39-54) E		
(21-38) F		
(1-20) G		
Not energy efficient - higher running costs		
	50	82
England, Scotland & Wales EU Directive 2002/91/EC		

Environmental Impact (CO ₂) Rating		
	Current	Potential
Very environmentally friendly - lower CO ₂ emissions		
(92-100) A		
(81-91) B		
(69-80) C		
(55-68) D		
(39-54) E		
(21-38) F		
(1-20) G		
Not environmentally friendly - higher CO ₂ emissions		
	44	80
England, Scotland & Wales EU Directive 2002/91/EC		

Ground Floor

Approx. 24.2 sq. metres (260.5 sq. feet)

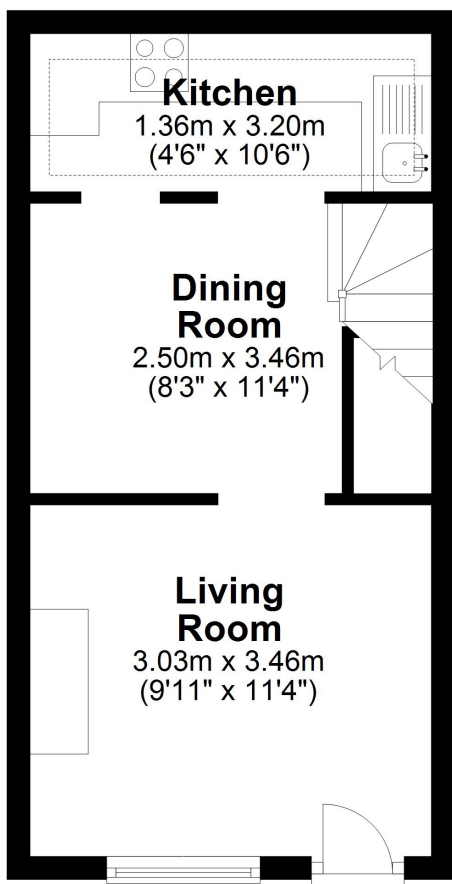

First Floor

Approx. 19.6 sq. metres (211.1 sq. feet)

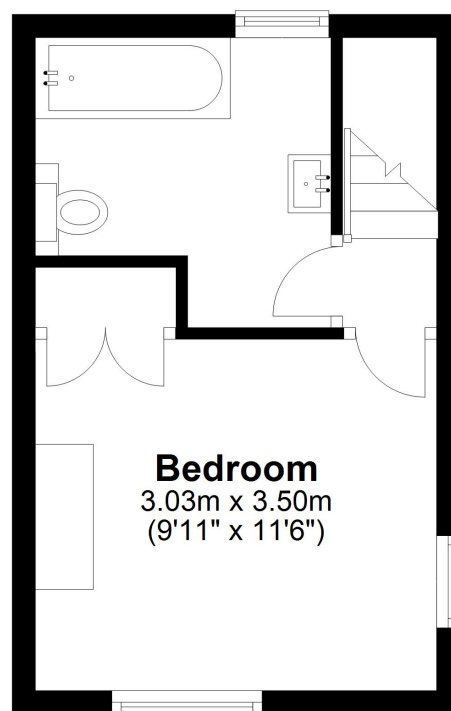

Total area: approx. 43.8 sq. metres (471.7 sq. feet)

Major Son & Phipps give notice to anyone reading these particulars that: (i) these particulars do not constitute part of an offer or contract; (ii) these particulars and any pictures or plans represent the opinion of the author and are given in good faith for guidance only and must not be construed as statements of fact; (iii) nothing in the particulars shall be deemed a statement that the property is in good condition otherwise; we have not carried out a structural survey of the property and have not tested the services, appliances or specified fittings.

Long Description

Rarely available character one bedroom cottage in the ever popular 'Alberts' area of Richmond. This charming end of terrace cottage comprises reception room, dining room, fitted kitchen, bedroom and upstairs bathroom, conveniently located a very short walk from the Town centre and station.