

HENDON WAY, LONDON, NW2 £495,000, Leasehold



SOLD

STUNNING NEW CONVERSION

Spacious Ground floor 3 BEDROOM 2 BATHROOM flat of 975 sq ft /90 sq mt in this NEWLY CONVERTED and extended house with 3 flats in total situated on the North Bound side between Cricklewood Lane and The Vale.





Hendon Way NW2

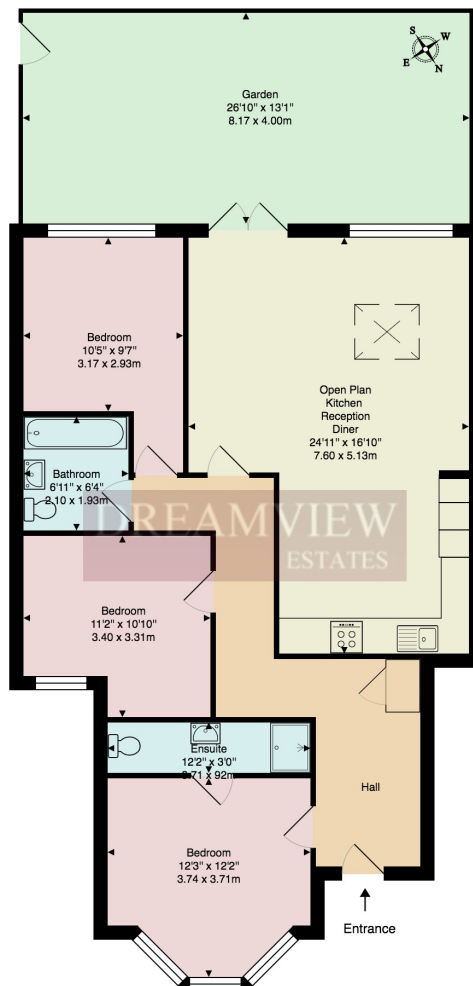

Approx. Gross Internal Area: 975 ft² ... 90.6 m² (excluding garden)

All measurements and areas are approximate only.
Dimensions are not to scale. This plan is for guidance
only and must not be relied upon as a statement of fact.
(c) Peninsula Surveys Ltd

Dreamview Estates give notice to anyone reading these particulars that: (i) these particulars do not constitute part of an offer or contract; (ii) these particulars and any pictures or plans represent the opinion of the author and are given in good faith for guidance only and must not be construed as statements of fact; (iii) nothing in the particulars shall be deemed a statement that the property is in good condition otherwise; we have not carried out a structural survey of the property and have not tested the services, appliances or specified fittings.

Long Description

HENDON WAY, LONDON, NW2 2LX

SOLD

We are pleased to bring to the market the ground floor 3 BEDROOM 2 BATHROOM flat with some 975 sq ft/90 sq mt of accommodation in this NEWLY CONVERTED and extended house situated on the North Bound side between Cricklewood Lane and The Vale.

All flats have been newly REFURBISHED to a HIGH STANDARD with LUXURY kitchens and bathrooms and will have new 125 year lease

This ground floor unit provides a large lounge with open plan kitchen along with the additional bathroom and own section of rear garden with direct access

There is also 1 off street parking space

The flat is newly decorated with wooden flooring, in great condition and gas central heating so its ready to move straight in !

Price at £535,000 with a new 125 year leases with £200pa Ground Rent

NOW ONLY £495,000 !!!

This flat will pay a 45% share of any maintenance costs and building insurance