



A stunning top floor one bedroom apartment set in a glorious period detached house with communal gardens and parking. Located within the highly desirable Lovelace area only minutes' walk from Surbiton mainline station and high street. The many benefits include a good size living room, period fire place, double bedroom, storage space, modern white bathroom suite with a shower over the bath, gas central heating and security entrance phone. Well maintained communal gardens and parking. Sold with a Share of Freehold and no onward chain.



Lovelace Gardens, Surbiton, Surrey, KT6

APPROX. GROSS INTERNAL FLOOR AREA 479 SQFT / 44.4 SQM

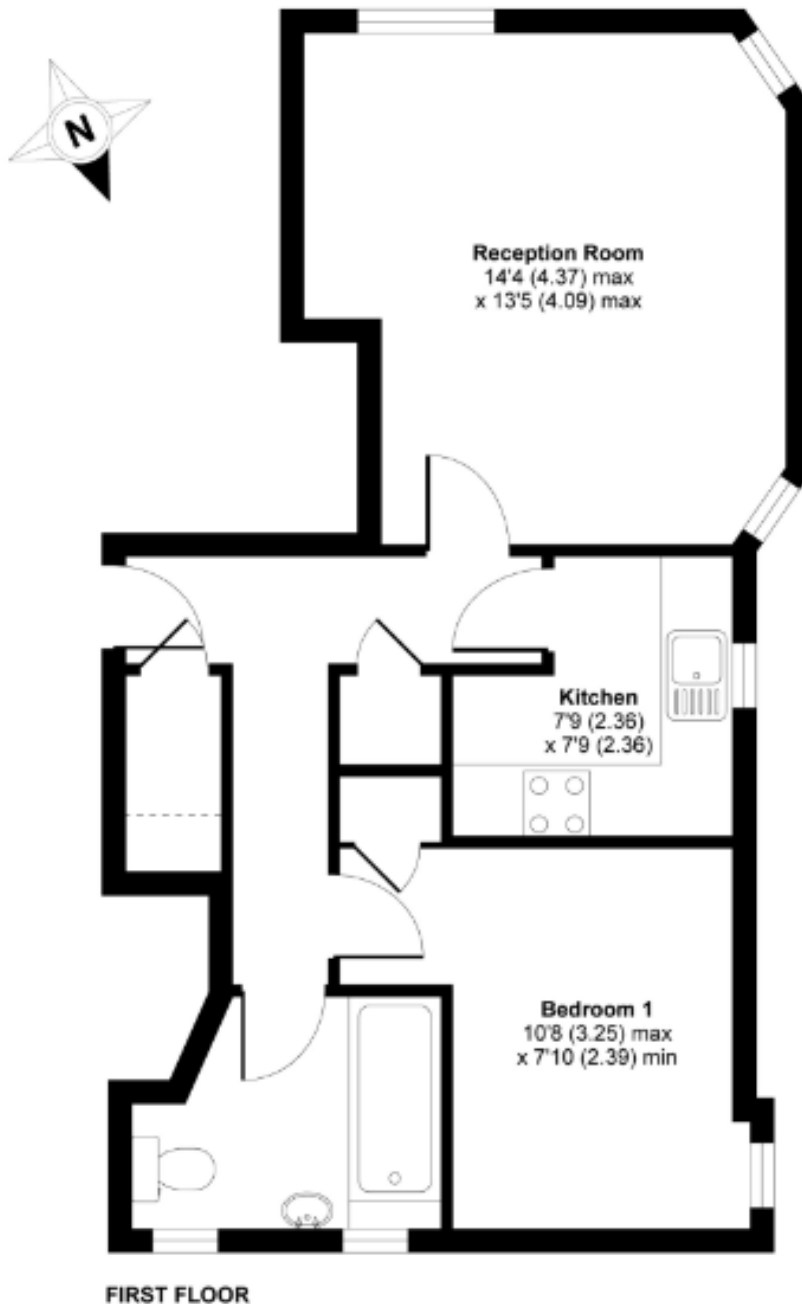

We have prepared these sales particulars as a general guide after a brief inspection of the property and with information supplied by the Vendors. No detailed survey was carried out nor were the services and appliances tested. Photographs are not comprehensive and no assumption should be made that the property remains as displayed.

The floor plans are for representation purposes only as defined by the RICS Code of Measuring Practice. Measurements, room shapes and sizes are approximate and must not be relied on. No responsibility is taken for errors or omissions. All fixtures and fittings, carpets, curtains/blinds, lighting and kitchen equipment, whether fitted or not, are deemed to be removable by the Vendors unless specifically itemised. No representation is given as to the title of the property.

HJC

HIGHER VALUES

HJC Surbiton 020 8390 0404 | HJC Lettings 020 8390 9290 | HJC Thames Ditton 020 8398 3707
surbiton@hjc.co.uk | lettings@hjc.co.uk | thamesditton@hjc.co.uk

Reg no: 05272208 | VAT no: 720 5720 65