

To find out more please call us on **020 8549 3366**

Kingston, KT6

Approximate Gross Internal Area = 45.2 sq m / 486 sq ft

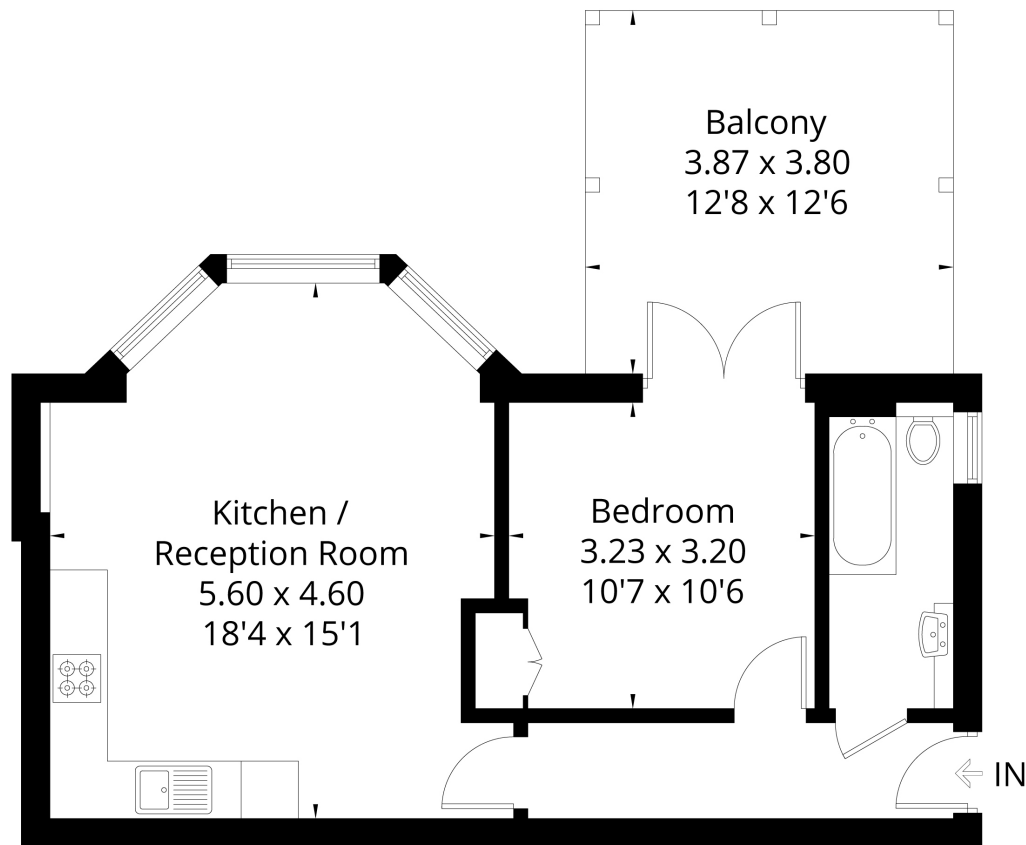

FLOORPLANZ © 2017 0203 9056099 Ref: 198989

This plan is for layout guidance only. Drawn in accordance with RICS guidelines. Not drawn to scale unless stated. Windows & door openings are approximate. Whilst every care is taken in the preparation of this plan, please check all dimensions, shapes & compass bearings before making any decisions reliant upon them.

**EWELL ROAD**



**£350,000**

**STATEMENT OF INTENT**

- We are independent property marketing experts dedicated to finding you a new home.
- We are agile & responsive to your search requirements. We listen and won't waste time recommending properties outside your search criteria. If we don't have your perfect property we'll market and advertise on your behalf.
- We provide a dedicated point-of-contact who'll listen to what's important in your property search from viewing through to exchange and final completion.



**Carringtons**

Kingston Hill | North Kingston  
**020 8549 3366** | **020 8549 7788**  
mail@carringtonsproperty.com

[www.carringtonsproperty.co.uk](http://www.carringtonsproperty.co.uk)



**Carringtons**

[www.carringtonsproperty.co.uk](http://www.carringtonsproperty.co.uk)

# EWELL ROAD



A beautiful conversion flat situated in the popular Ewell Road, Surbiton. This one bedroom flat has a large private terrace overlooking the communal gardens, wooden flooring, high ceilings and new kitchen and bathroom. Available now.

