

Buttermere Gardens

Liverpool, L23

£150,000



- * Book A Viewing Online Now;
Visit www.logicstates.co.uk
- * Recently Refurbished
- * Three Bedroom Mid Terrace House
- * Approx 100 Foot Private Rear Garden
- * No Chain



97 | SOUTH ROAD | WATERLOO | L22 0LR
Tel: 0151 920 2404
E-mail: info@logicstates.co.uk

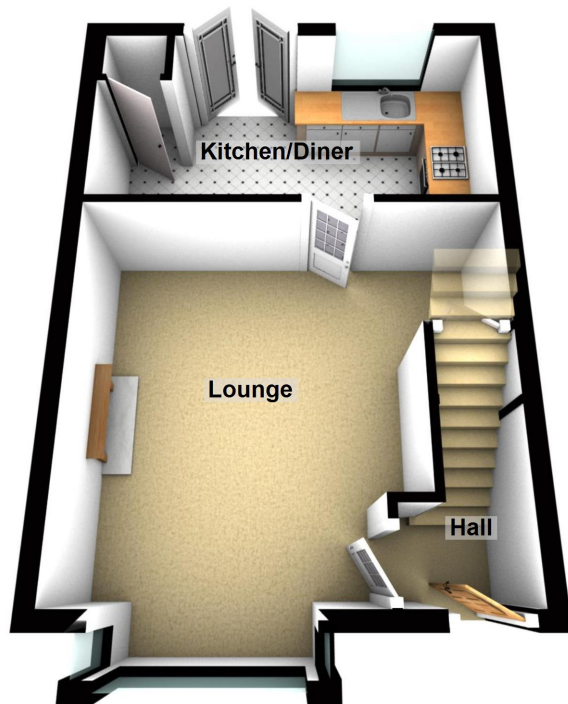
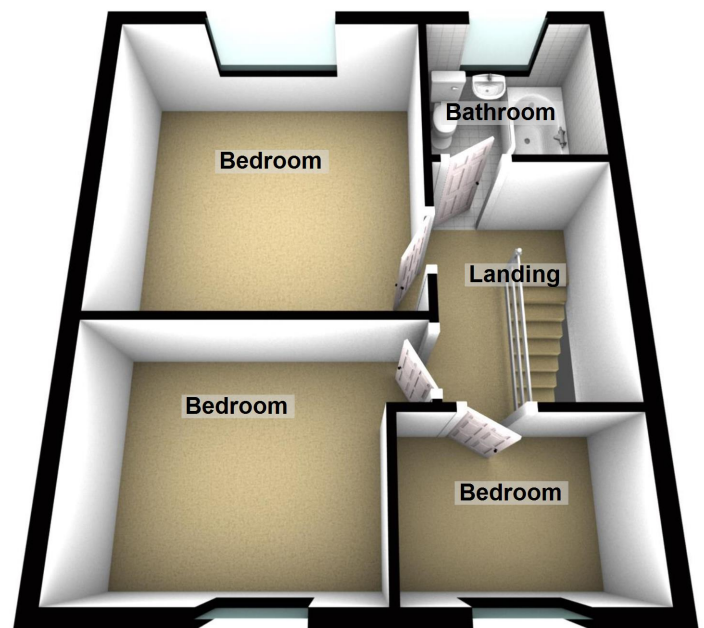

Ground Floor**First Floor**

Buttermere Gardens, Liverpool

These particulars do not form part of any offer or contract and must not be relied upon as statements or representations of fact. Any areas, measurements or distances are approximate. The text, photographs and plans are for guidance only and are not necessarily comprehensive. It should not be assumed that the property has all the necessary planning, building regulation or other consents and we have not tested services, equipment or facilities. Purchasers must satisfy themselves by inspection or otherwise.

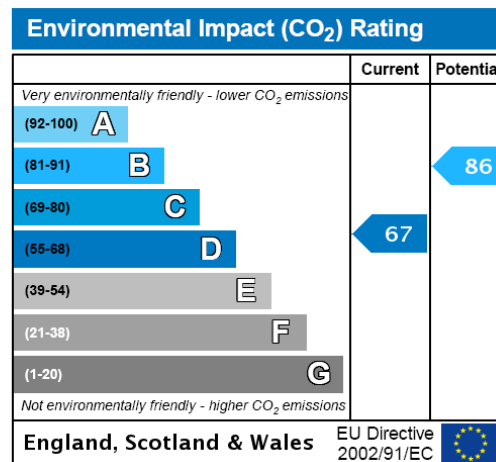
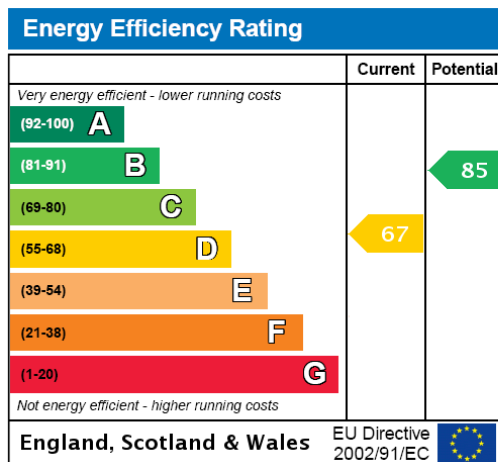

Book A Viewing Online Now;
Visit www.logicstates.co.uk

Accommodation Comprises Of:

Ground Floor:

Entrance Hallway

13'11 x 15'2 - Lounge With Bay Window

7'5 x 15'2 - Fitted Kitchen / Diner With French Doors To The Rear Garden

First Floor:

12'3 x 11'11 - Double Bedroom

8'11 x 10'4 - Double Bedroom

6'5 x 8'3 - Single Bedroom

6'1 x 6'7 - Fitted Bathroom

Exterior:

Front & Rear Gardens

To View Call Logic.

These particulars do not form part of any offer or contract and must not be relied upon as statements or representations of fact. Any areas, measurements or distances are approximate. The text, photographs and plans are for guidance only and are not necessarily comprehensive. It should not be assumed that the property has all the necessary planning, building regulation or other consents and we have not tested services, equipment or facilities. Purchasers must satisfy themselves by inspection or otherwise.