

To find out more please call us on **020 8549 3366**

Belvedere Court, Queens Road, Kingston upon Thames, KT2

Approximate Gross Internal Area = 68.7 sq m / 739 sq ft

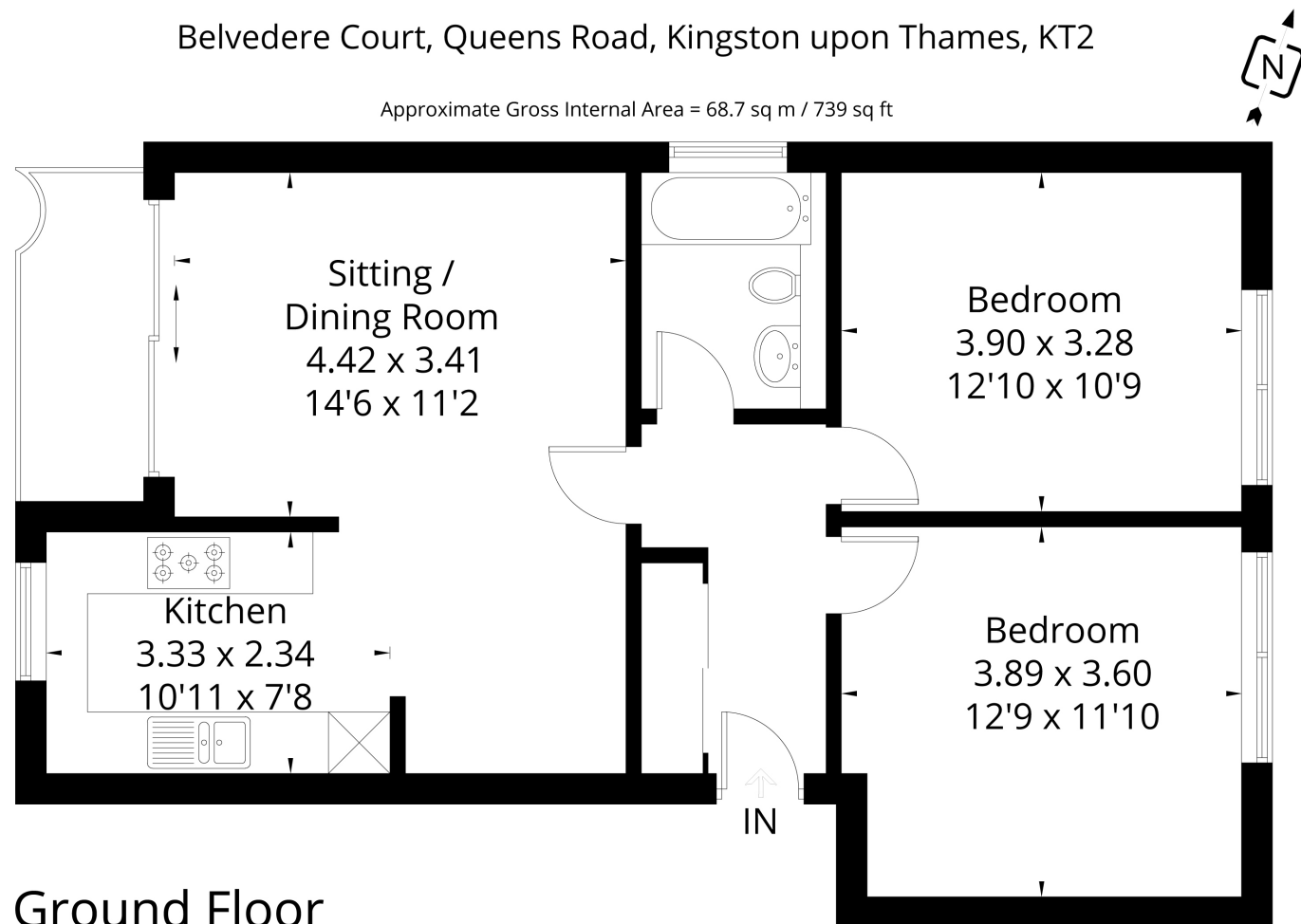

Ground Floor

Illustration for identification purposes only. Not to scale  
Ref: 199439

**QUEENS ROAD**



**£450,000**

#### STATEMENT OF INTENT

- We are independent property marketing experts dedicated to finding you a new home.
- We are agile & responsive to your search requirements. We listen and won't waste time recommending properties outside your search criteria. If we don't have your perfect property we'll market and advertise on your behalf.
- We provide a dedicated point-of-contact who'll listen to what's important in your property search from viewing through to exchange and final completion.



Kingston Hill | North Kingston  
**020 8549 3366** | **020 8549 7788**  
mail@carringtonsproperty.com  
[www.carringtonsproperty.co.uk](http://www.carringtonsproperty.co.uk)



[www.carringtonsproperty.co.uk](http://www.carringtonsproperty.co.uk)



QUEENS ROAD



This well proportioned two bedroom flat is on the ground floor of a small private block. The entire flat has been tastefully modernised throughout and has a parking space. Ideal for couple or single professional and is good for access to Richmond Park, Kingston Town Centre and Norbiton Station.

Available from the 1st of October 2018 please call now to book in a viewing. (flexible on furnishings)

