

To find out more please call us on **020 8549 3366**

Kingston Hill, Kingston upon Thames

Approximate Gross Internal Area = 63.8 sq m / 687 sq ft

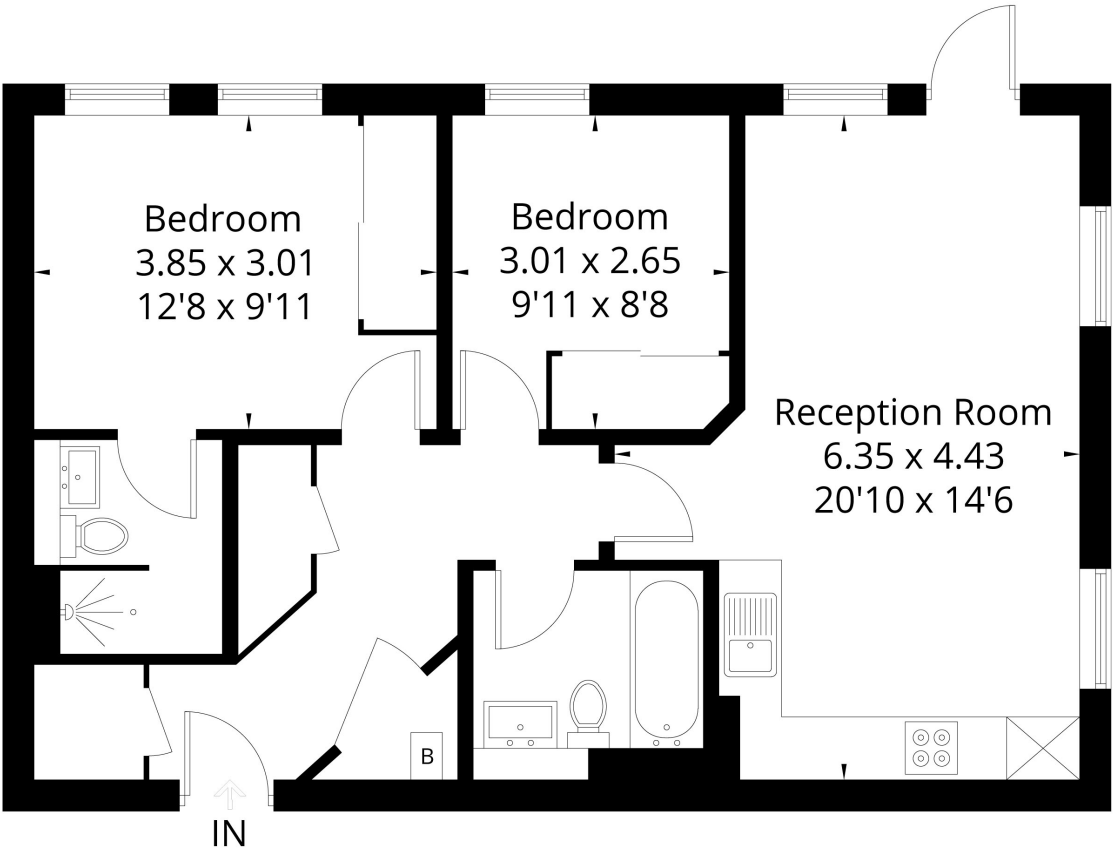

FLOORPLANZ © 2017 0203 9056099 Ref: 185191

This plan is for layout guidance only. Drawn in accordance with RICS guidelines. Not drawn to scale unless stated. Windows & door openings are approximate. Whilst every care is taken in the preparation of this plan, please check all dimensions, shapes & compass bearings before making any decisions reliant upon them.

**KINGSTON HILL**



**£450,000**

**STATEMENT OF INTENT**

- We are independent property marketing experts dedicated to finding you a new home.
- We are agile & responsive to your search requirements. We listen and won't waste time recommending properties outside your search criteria. If we don't have your perfect property we'll market and advertise on your behalf.
- We provide a dedicated point-of-contact who'll listen to what's important in your property search from viewing through to exchange and final completion.



**Carringtons**

Kingston Hill | North Kingston  
**020 8549 3366** | **020 8549 7788**  
mail@carringtonsproperty.com

[www.carringtonsproperty.co.uk](http://www.carringtonsproperty.co.uk)



**Carringtons**

[www.carringtonsproperty.co.uk](http://www.carringtonsproperty.co.uk)



# KINGSTON HILL



Charming 2 bedroom flat with a private garden. This property was newly refurbished as of 2015 and has been kept in immaculate condition. The flat boasts 2 double bedrooms, a family bathroom and en-suite shower room. A bright and spacious open plan living and kitchen are opens on to the attractive private garden, which further benefits from a side gate, allowing for rear entrance. The property further benefits from ample storage throughout.

The block is conveniently situated on Kingston Hill, for local shops, restaurants and bus routes to the Town Centre or into London. Directly opposite is Wolverton Avenue, leading to Norbiton Station for trains to London Waterloo. The historical Richmond Park is also within easy reach.

