

Croyde Avenue, UB3

Offers in excess of £270,000, Leasehold

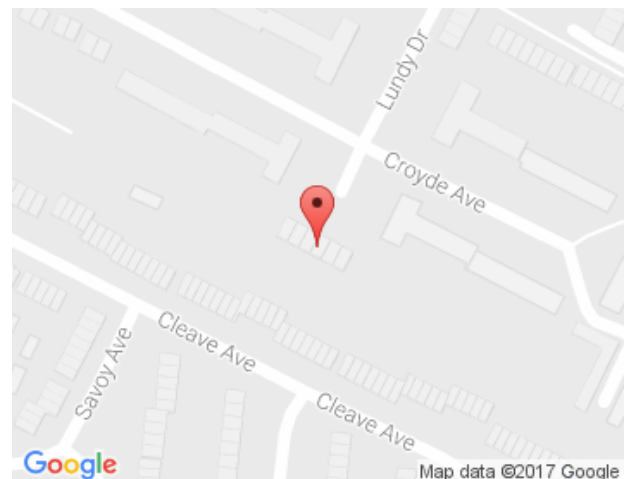

Spacious 3 bedroom split level 1st floor flat walking distance to Hayes & Harlington station (Crossrail anticipated 2020) + ASDA Superstore, a choice of schools & main bus route links for Heathrow etc. Entrance hall, 16' lounge/ diner, fitted kitchen, upstairs has 3 good sized bedrooms & bathroom with separate toilet. Outside has communal gardens & communal parking. 95 year lease
Ground rent £10 P/A
Service charge £78 pcm





Ground Floor

Approx. 37.7 sq. metres (405.3 sq. feet)

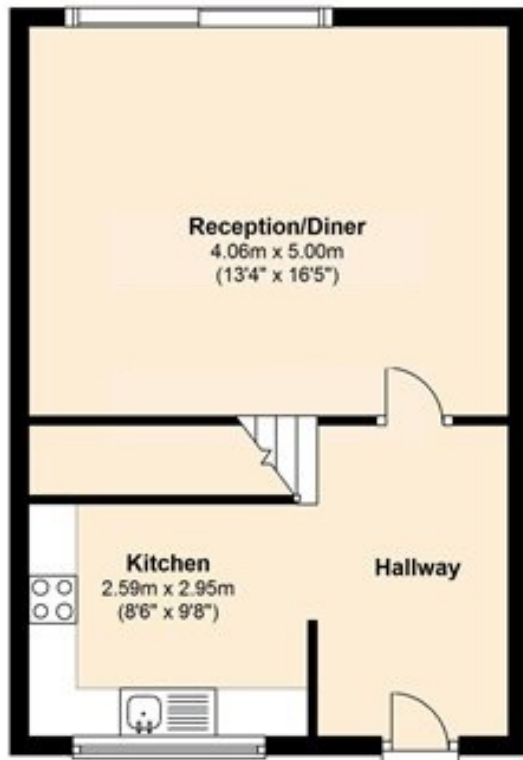

First Floor

Approx. 38.5 sq. metres (414.6 sq. feet)

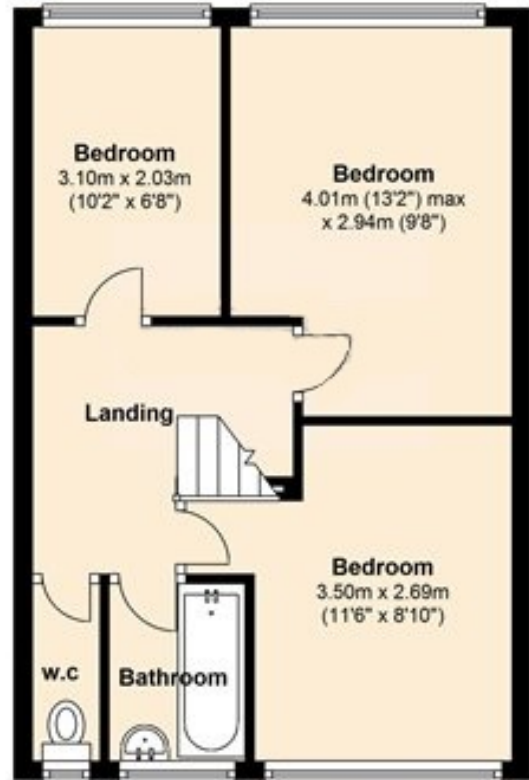

Total area: approx. 76.2 sq. metres (819.9 sq. feet)

Whilst every attempt has been made to ensure the accuracy of the floor plan contained here, measurements of doors, windows, rooms and other items are approximate and no responsibility is taken for any error, omission, or mis-statement. This plan is for illustrative purposes only and should be used as such by any prospective purchaser. The services, systems and appliances shown have not been tested and no guarantee as to their operability or efficiency can be given.

Plan produced using PlanUp.

broads property services give notice to anyone reading these particulars that: (i) these particulars do not constitute part of an offer or contract; (ii) these particulars and any pictures or plans represent the opinion of the author and are given in good faith for guidance only and must not be construed as statements of fact; (iii) nothing in the particulars shall be deemed a statement that the property is in good condition otherwise; we have not carried out a structural survey of the property and have not tested the services, appliances or specified fittings.

Long Description

Spacious 3 bedroom split level 1st floor flat walking distance to Hayes & Harlington station (Crossrail anticipated 2020) + ASDA Superstore, a choice of schools & main bus route links for Heathrow etc. Entrance hall, 16' lounge/ diner, fitted kitchen, upstairs has 3 good sized bedrooms & bathroom with separate toilet.

Outside has communal gardens & communal parking.

95 year lease

Ground rent £10 P/A

Service charge £78 pcm