



GROSVENOR STREET



£520 PER WEEK
FURNISHED

WETHERELL
MAYFAIR'S FINEST PROPERTIES

102 Mount Street · London · W1K 2TH
T: 020 7529 5588 E: rentals@wetherell.co.uk
wetherell.co.uk

NO-ONE KNOWS MAYFAIR BETTER THAN WETHERELL





GROSVENOR STREET

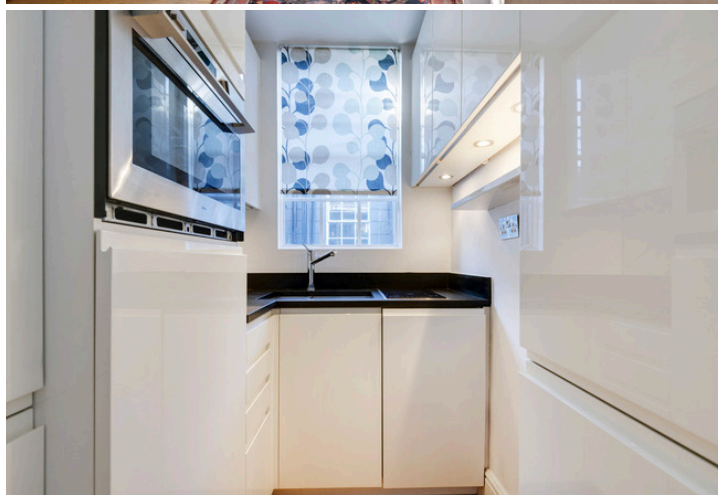

A well presented one bedroom apartment on the sixth floor of this popular period building with lift and porter. The heating and hot water bills are included.

SPACIOUS DOUBLE BEDROOM • SEPARATE KITCHEN • WOODEN FLOORS • PORTER
• LIFT • SIXTH FLOOR

NO-ONE KNOWS MAYFAIR BETTER THAN WETHERELL





GROSVENOR STREET

A well presented one bedroom apartment on the sixth floor of this popular period building with lift and porter. The heating and hot water bills are included.

Grosvenor Street is in the centre of Mayfair close to the restaurants, shops and the amenities the West End and surrounding areas have to offer.

Accommodation:

- * Spacious Double Bedroom
- * Separate Kitchen
- * Wooden Floors
- * Porter
- * Lift
- * Sixth Floor

*Wetherell & Co. (Mayfair) Ltd. is a member of the RICS Client money protection Scheme, and also a member of the NAEA, ARLA Propertymark and the property Ombudsman which are Redress schemes.

Any Tenancy that falls outside of the housing act will be subject to Tenant fees. You can find out more details on the Wetherell website or by contacting us directly.

£520 PER WEEK
FURNISHED

Wetherell have no authority to make or give any representations or warranties in relation to the property. These particulars do not form part of any offer or contract and must not be relied upon as statements or representations of fact. Any areas, measurements or distances are approximate. The text, photographs and plans are for guidance only and are not necessarily comprehensive. It should not be assumed that the property has all the necessary planning, building regulation or other consents and Wetherell have not tested any services, equipment or facilities. Purchasers must satisfy themselves by inspection or otherwise. 2021

WETHERELL
MAYFAIR'S FINEST PROPERTIES

102 Mount Street · London · W1K 2TH
T: 020 7529 5588 E: rentals@wetherell.co.uk
wetherell.co.uk

NO-ONE KNOWS MAYFAIR BETTER THAN WETHERELL





GROSVENOR STREET

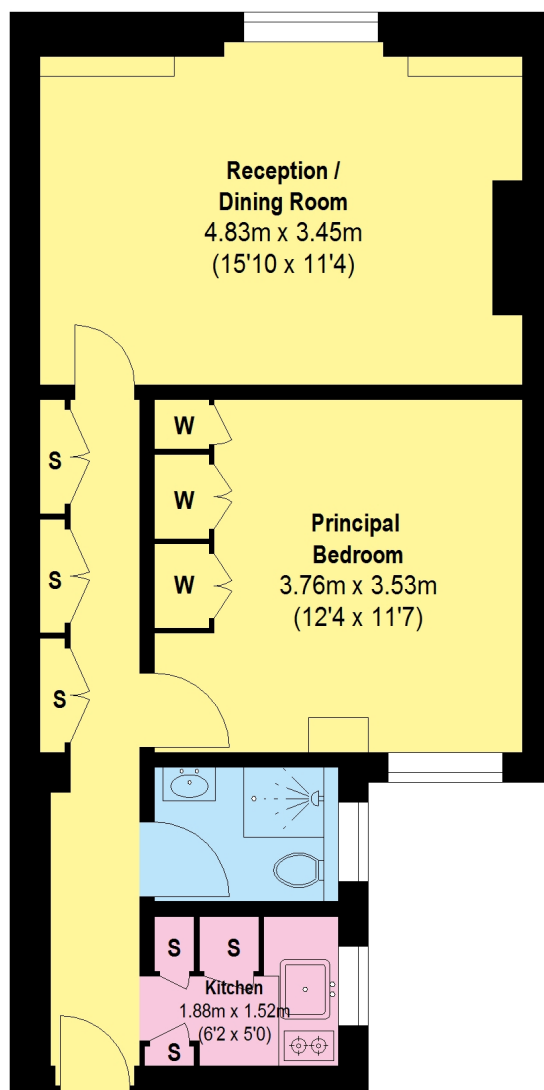

Sixth Floor

Total area (approx.): 42.55 sq. m (458 Sq. ft)

Wetherell have no authority to make or give any representations or warranties in relation to the property. These particulars do not form part of any offer or contract and must not be relied upon as statements or representations of fact. Any areas, measurements or distances are approximate. The text, photographs and plans are for guidance only and are not necessarily comprehensive. It should not be assumed that the property has all the necessary planning, building regulation or other consents and Wetherell have not tested any services, equipment or facilities. Purchasers must satisfy themselves by inspection or otherwise. 2021

WETHERELL
MAYFAIR'S FINEST PROPERTIES

102 Mount Street · London · W1K 2TH
T: 020 7529 5588 E: rentals@wetherell.co.uk
wetherell.co.uk

NO-ONE KNOWS MAYFAIR BETTER THAN WETHERELL

